

Stream & Location: West Creek (on 3.65) (Broadview Rd) C2/TZ RM: 3.65 Date: 7/29/13

Zamborsky Zaboltny (Post Rehab) Scorers Full Name & Affiliation: Northeast Ohio Regional Sewer District

River Code: - - - STORET #: Lat./Long.: 41.4103 / 81.6943 Office verified location

1] SUBSTRATE Check ONLY Two substrate TYPE BOXES; estimate % or note every type present Check ONE (Or 2 & average) (POST REMEDIATION)

Substrate assessment grid with categories: BEST TYPES, POOL RIFFLE, OTHER TYPES, POOL RIFFLE, ORIGIN, SILT, EMBEDDEDNESS, QUALITY. Includes checkboxes for various substrate types and a final score of 12.5.

Comments: Predominant bedrock (80%) bldr silt but not enough

2] INSTREAM COVER Indicate presence 0 to 3: 0-Absent; 1-Very small amounts or if more common of marginal quality; 2-Moderate amounts, but not of highest quality or in small amounts of highest quality; 3-Highest quality in moderate or greater amounts

Instream cover assessment grid with categories: UNDERCUT BANKS, OVERHANGING VEGETATION, SHALLOWS, ROOTMATS, POOLS, ROOTWADS, BOULDERS, OXBOWS, AQUATIC MACROPHYTES, LOGS OR WOODY DEBRIS. Includes checkboxes and a final score of 5.

Comments: Cover few

3] CHANNEL MORPHOLOGY Check ONE in each category (Or 2 & average)

Channel morphology assessment grid with categories: SINUOSITY, DEVELOPMENT, CHANNELIZATION, STABILITY. Includes checkboxes and a final score of 10.

Comments: Development - NOT WELL DEVELOPED P/R/W/S

4] BANK EROSION AND RIPARIAN ZONE Check ONE in each category for EACH BANK (Or 2 per bank & average)

Bank erosion and riparian zone assessment grid with categories: EROSION, RIPARIAN WIDTH, FLOOD PLAIN QUALITY, CONSERVATION TILLAGE, URBAN OR INDUSTRIAL, MINING / CONSTRUCTION. Includes checkboxes and a final score of 3.5.

Comments: Apartment blocks RR Nursing Home - RR -> LG parking lots

5] POOL / GLIDE AND RIFFLE / RUN QUALITY

Pool/glide and riffle/run quality assessment grid with categories: MAXIMUM DEPTH, CHANNEL WIDTH, CURRENT VELOCITY, Recreation Potential. Includes checkboxes and a final score of 8.

Comments

Indicate for functional riffles; Best areas must be large enough to support a population of riffle-obligate species: Check ONE (Or 2 & average). NO RIFFLE [metric=0]

Riffle/run quality assessment grid with categories: RIFFLE DEPTH, RUN DEPTH, RIFFLE / RUN SUBSTRATE, RIFFLE / RUN EMBEDDEDNESS. Includes checkboxes and a final score of 5.5.

Comments

6] GRADIENT (48.4 ft/mi) DRAINAGE AREA (6.3 ml^2) Gradient assessment grid with categories: VERY LOW - LOW, MODERATE, HIGH - VERY HIGH, %POOL, %GLIDE, %RUN, %RIFFLE. Includes checkboxes and a final score of 4.

Comment RE: Reach consistency/ Is reach typical of stream?, Recreation/Observed - Inferred, Other/ Sampling observations, Concerns, Access directions, etc.

A) SAMPLED REACH

Check ALL that apply

METHOD

- BOAT
 - WADE
 - L. LINE
 - OTHER
- STAGE**
- HIGH
 - UP
 - NORMAL
 - LOW
 - DRY

DISTANCE

- 0.5 Km
- 0.2 Km
- 0.15 Km
- 0.12 Km
- OTHER

CLARITY

- 1st --sample pass-- 2nd
- < 20 cm
 - 20-40 cm
 - 40-70 cm
 - > 70 cm/CTB
 - SECCHI DEPTH

CANOPY

- > 85%- OPEN
- 55%-<85%
- 30%-<55%
- 10%-<30%
- <10%- CLOSED

CJ RECREATION

AREA DEPTH
POOL: >100R2 >3ft

BJ AESTHETICS

- NUISANCE ALGAE
- INVASIVE MACROPHYTES
- EXCESS TURBIDITY
- DISCOLORATION
- FOAM / SCUM
- OIL SHEEN
- TRASH / LITTER
- NUISANCE ODOR
- SLUDGE DEPOSITS
- CSOS/ISSOS/OUTFALLS

DJ MAINTENANCE

- PUBLIC / PRIVATE / BOTH / NA
- ACTIVE / HISTORIC / BOTH / NA
- YOUNG-SUCCESSION-OLD
- SPRAY / SNAG / REMOVED
- MODIFIED / DIPPED OUT / NA
- LEVEED / ONE SIDED
- RELOCATED / CUTOFFS
- MOVING-BEDLOAD-STABLE
- ARMoured / SLUMPS
- ISLANDS / SCOURED
- IMPOUNDED / DESICCATED
- FLOOD CONTROL / DRAINAGE

EJ ISSUES

- WWTP / CSO / NPDES / INDUSTRY
- HARDENED / URBAN / DIRT&GRIME
- CONTAMINATED / LANDFILL
- BMPs-CONSTRUCTION-SEDIMENT
- LOGGING / IRRIGATION / COOLING
- BANK / EROSION / SURFACE
- FALSE BANK / MANURE / LAGOON
- WASH H₂O / TILE / H₂O TABLE
- ACID / MINE / QUARRY / FLOW
- NATURAL / WETLAND / STAGNANT
- PARK / GOLF / LAWN / HOME
- ATMOSPHERE / DATA PAUCITY

FJ MEASUREMENTS

- \bar{x} width
- \bar{x} depth
- max. depth
- \bar{x} bankfull width
- bankfull \bar{x} depth
- W/D ratio
- bankfull max. depth
- floodprone \bar{x}^2 width
- entrench. ratio

Legacy Tree:

Stream Drawing:

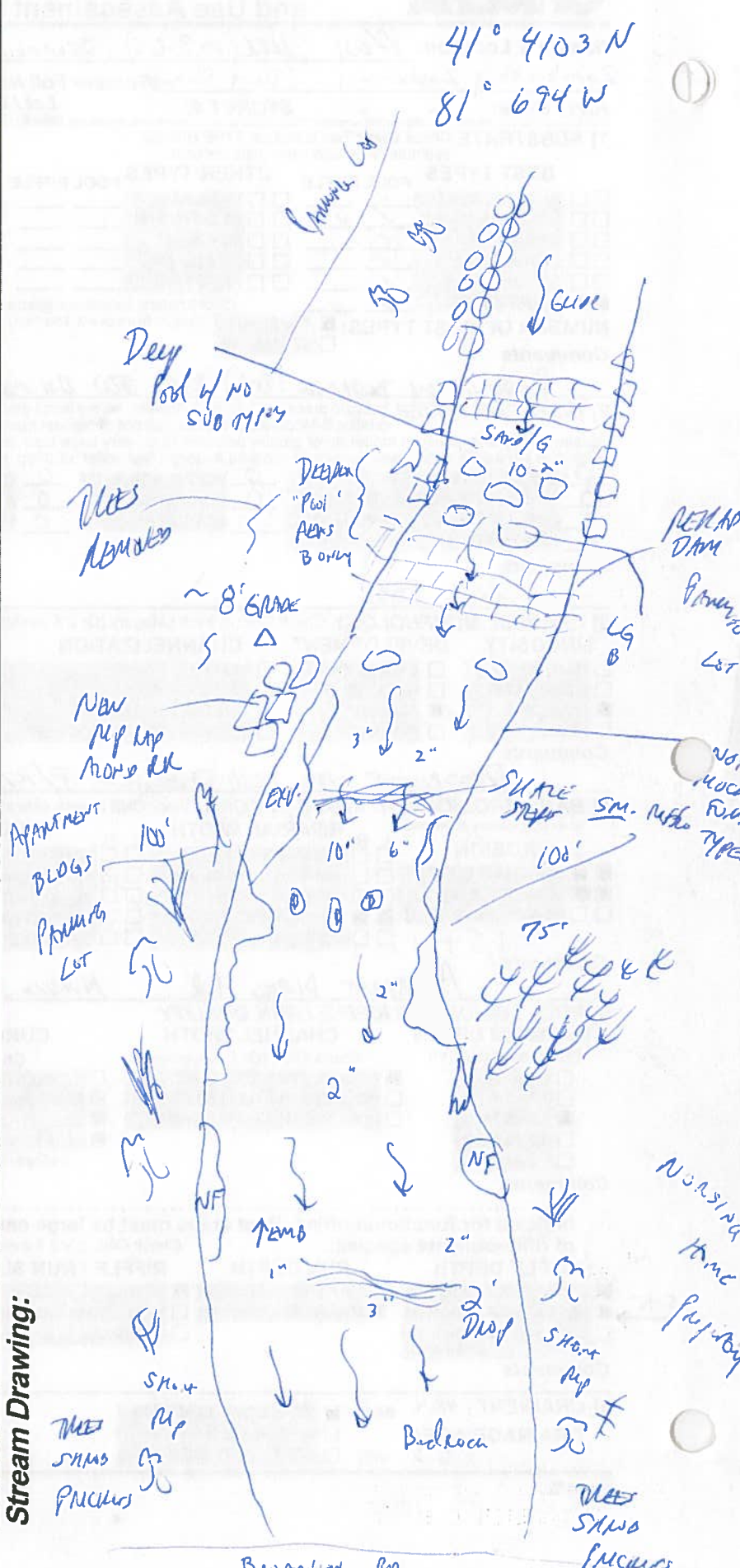

Stream & Location: WEST CREEK (RM 2.1) DS 480 RM: 2.10 Date: 7/29/13

Post RELOAD Zambovsky Zablotny Scorers Full Name & Affiliation: Northeast Ohio Regional Sewer District C2/T2

River Code: STORET #: Lat./Long.: 41.4103 / 81.6943 Office verified location

1) SUBSTRATE Check ONLY Two substrate TYPE BOXES; estimate % or note every type present. Check ONE (Or 2 & average). BEST TYPES: BLDR/SLABS [10], BOULDER [9], COBBLE [8], GRAVEL [7], SAND [6], BEDROCK [5]. OTHER TYPES: HARDPAN [4], DETRITUS [3], MUCK [2], SILT [2], ARTIFICIAL [0]. ORIGIN: LIMESTONE [1], TILLS [1], WETLANDS [0], HARDPAN [0], SANDSTONE [0], RIP/RAP [0], LACUSTURINE [0], SHALE [-1], COAL FINES [-2]. QUALITY: HEAVY [-2], MODERATE [-1], NORMAL [0], FREE [1], EXTENSIVE [-2], MODERATE [-1], NORMAL [0], NONE [1]. Substrate Maximum 20. Comments: B/C/G IN ROAD AREA. DS OF LAST STEP POOL SAME ONLY!

2) INSTREAM COVER Indicate presence 0 to 3: 0-Absent, 1-Very small amounts or if more common of marginal quality, 2-Moderate amounts, but not of highest quality or in small amounts of highest quality, 3-Highest quality in moderate or greater amounts. AMOUNT: Check ONE (Or 2 & average). EXTENSIVE >75% [11], MODERATE 25-75% [7], SPARSE 5-<25% [3], NEARLY ABSENT <5% [1]. Comments: BERS only. Cover Maximum 20.

3) CHANNEL MORPHOLOGY Check ONE in each category (Or 2 & average). SINUOSITY: HIGH [4], MODERATE [3], LOW [2], NONE [1]. DEVELOPMENT: EXCELLENT [7], GOOD [5], FAIR [3], POOR [1]. CHANNELIZATION: NONE [6], RECOVERED [4], RECOVERING [3], RECENT OR NO RECOVERY [1]. STABILITY: HIGH [3], MODERATE [2], LOW [1]. Channel Maximum 20. Comments: Not well-defined pool.

4) BANK EROSION AND RIPARIAN ZONE Check ONE in each category for EACH BANK (Or 2 per bank & average). River right looking downstream. EROSION: NONE / LITTLE [3], MODERATE [2], HEAVY / SEVERE [1]. RIPARIAN WIDTH: WIDE > 50m [4], MODERATE 10-50m [3], NARROW 5-10m [2], VERY NARROW < 5m [1], NONE [0]. FLOOD PLAIN QUALITY: FOREST, SWAMP [3], SHRUB OR OLD FIELD [2], RESIDENTIAL, PARK, NEW FIELD [1], FENCED PASTURE [1], OPEN PASTURE, ROWCROP [0]. CONSERVATION TILLAGE [1], URBAN OR INDUSTRIAL [0], MINING / CONSTRUCTION [0]. Riparian Maximum 10. Comments: 2.5+3, 2.75.

5) POOL / GLIDE AND RIFFLE / RUN QUALITY MAXIMUM DEPTH: > 1m [6], 0.7-<1m [4], 0.4-<0.7m [2], 0.2-<0.4m [1], < 0.2m [0]. CHANNEL WIDTH: POOL WIDTH > RIFFLE WIDTH [2], POOL WIDTH = RIFFLE WIDTH [1], POOL WIDTH < RIFFLE WIDTH [0]. CURRENT VELOCITY: TORRENTIAL [-1], VERY FAST [1], FAST [1], MODERATE [1], SLOW [1], INTERSTITIAL [-1], INTERMITTENT [-2], EDDIES [1]. Recreation Potential: Primary Contact, Secondary Contact. Pool / Current Maximum 12. Comments:

Indicate for functional riffles; Best areas must be large enough to support a population of riffle-obligate species: Check ONE (Or 2 & average). NO RIFFLE [metric=0]. RIFFLE DEPTH: BEST AREAS > 10cm [2], BEST AREAS 5-10cm [1], BEST AREAS < 5cm [metric=0]. RUN DEPTH: MAXIMUM > 50cm [2], MAXIMUM < 50cm [1]. RIFFLE / RUN SUBSTRATE: STABLE (e.g., Cobble, Boulder) [2], MOD. STABLE (e.g., Large Gravel) [1], UNSTABLE (e.g., Fine Gravel, Sand) [0]. RIFFLE / RUN EMBEDDEDNESS: NONE [2], LOW [1], MODERATE [0], EXTENSIVE [-1]. Riffle / Run Maximum 8. Comments:

6] GRADIENT (36.4 ft/mi) DRAINAGE AREA (8.7 mi^2) VERY LOW - LOW [2-4], MODERATE [6-10], HIGH - VERY HIGH [10-6]. %POOL: %GLIDE: %RUN: %RIFFLE: Gradient Maximum 10.

Comment RE: Reach consistency/Is reach typical of stream?, Recreation/Observed - Inferred, Other/ Sampling observations, Concerns, Access directions, etc.

AJ SAMPLED REACH

Check ALL that apply

METHOD

- BOAT
 - WADE
 - L. LINE
 - OTHER
- STAGE**
- HIGH
 - UP
 - NORMAL
 - LOW
 - DRY

DISTANCE

- 0.5 Km
- 0.2 Km
- 0.15 Km
- 0.12 Km
- OTHER

CLARITY

- 1st - sample pass-- 2nd
- < 20 cm
 - 20-40 cm
 - 40-70 cm
 - > 70 cm/CTB
 - SECCHI DEPTH

CANOPY

- > 85%- OPEN
- 55%-<85%
- 30%-<55%
- 10%-<30%
- <10%- CLOSED

BJAESTHETICS

- NUISANCE ALGAE
- INVASIVE MACROPHYTES
- EXCESS TURBIDITY
- DISCOLORATION
- FOAM / SCUM
- OIL SHEEN
- TRASH / LITTER
- NUISANCE ODOR
- SLUDGE DEPOSITS
- CSOS/SOS/OUTFALLS

CJ RECREATION

AREA DEPTH POOL: >100ft² >3ft

DJ MAINTENANCE

- PUBLIC / PRIVATE / BOTH / NA
- ACTIVE / HISTORIC / BOTH / NA
- YOUNG-SUCCESSION-OLD
- SPRAY / SNAG / REMOVED
- MODIFIED / DIPPED OUT / NA
- LEVEED / ONE SIDED
- RELOCATED / CUTOFFS
- MOVING-BEDLOAD-STABLE
- ARMOURED / SLUMPS
- ISLANDS / SCoured
- IMPOUNDED / DESICCATED
- FLOOD CONTROL / DRAINAGE

EJ ISSUES

- WWTP / CSO / NPDES / INDUSTRY
- HARDENED / URBAN / DIRT&GRIME
- CONTAMINATED / LANDFILL
- BMPs-CONSTRUCTION-SEDIMENT
- LOGGING / IRRIGATION / COOLING
- BANK / EROSION / SURFACE
- FALSE BANK / MANURE / LAGOON
- WASH H₂O / TILE / H₂O TABLE
- ACID / MINE / QUARRY / FLOW
- NATURAL / WETLAND / STAGNANT
- PARK / GOLF / LAWN / HOME
- ATMOSPHERE / DATA PAUCITY

FJ MEASUREMENTS

- \bar{x} width
- \bar{x} depth
- max. depth
- bankfull width
- bankfull \bar{x} depth
- W/D ratio
- bankfull max. depth
- floodprone \bar{x} width
- entrench. ratio

Legacy Tree:

Stream Drawing:

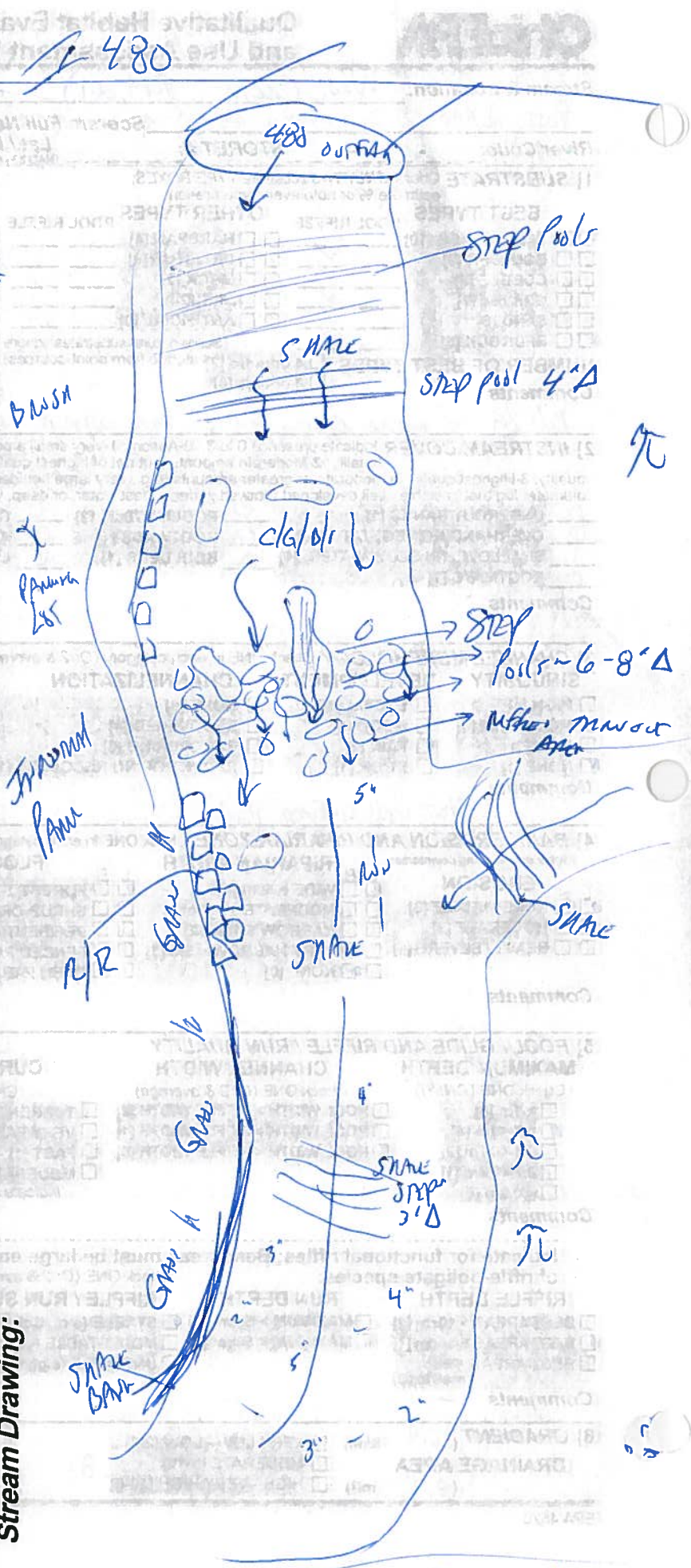

Stream & Location: WEST CREEK (RM 1.6) DS LAMARCA Pk **RM:** 1.60 **Date:** 7/29/13

POST RENAS Zamborsky Zablotny <2/12 **Scorers Full Name & Affiliation:** Northeast Ohio Regional Sewer District

River Code: - - - **STORET #:** - - - **Lat./Long.:** 41.4144 / 81.6618 (NAD 83 - decimal °) **Office verified location**

1] SUBSTRATE Check **ONLY** Two substrate **TYPE BOXES**; estimate % or note every type present

BEST TYPES	POOL RIFFLE	OTHER TYPES	POOL RIFFLE	ORIGIN	QUALITY
<input type="checkbox"/> BLDR /SLABS [10]	<input checked="" type="checkbox"/>	<input type="checkbox"/> HARDPAN [4]	<input type="checkbox"/>	<input type="checkbox"/> LIMESTONE [1]	<input type="checkbox"/> HEAVY [-2]
<input checked="" type="checkbox"/> BOULDER [9]	<input checked="" type="checkbox"/>	<input type="checkbox"/> DETRITUS [3]	<input type="checkbox"/>	<input checked="" type="checkbox"/> TILLS [1]	<input type="checkbox"/> MODERATE [-1]
<input type="checkbox"/> COBBLE [8]	<input checked="" type="checkbox"/>	<input type="checkbox"/> MUCK [2]	<input type="checkbox"/>	<input type="checkbox"/> WETLANDS [0]	<input type="checkbox"/> NORMAL [0]
<input type="checkbox"/> GRAVEL [7]	<input checked="" type="checkbox"/>	<input type="checkbox"/> SILT [2]	<input type="checkbox"/>	<input type="checkbox"/> HARDPAN [0]	<input type="checkbox"/> FREE [1]
<input type="checkbox"/> SAND [6]	<input checked="" type="checkbox"/>	<input type="checkbox"/> ARTIFICIAL [0]	<input type="checkbox"/>	<input type="checkbox"/> SANDSTONE [0]	<input type="checkbox"/> EXTENSIVE [-2]
<input type="checkbox"/> BEDROCK [5]	<input type="checkbox"/>			<input type="checkbox"/> RIP/RAP [0]	<input checked="" type="checkbox"/> MODERATE [-1]
<small>(Score natural substrates; ignore sludge from point-sources)</small>				<input type="checkbox"/> LACUSTURINE [0]	<input type="checkbox"/> NORMAL [0]
NUMBER OF BEST TYPES: <input checked="" type="checkbox"/> 4 or more [2] <input type="checkbox"/> 3 or less [0]				<input type="checkbox"/> SHALE [-1]	<input type="checkbox"/> NONE [1]
Comments				<input type="checkbox"/> COAL FINES [-2]	

Substrate
18.5
Maximum 20

2] INSTREAM COVER Indicate presence 0 to 3: 0-Absent; 1-Very small amounts or if more common of marginal quality; 2-Moderate amounts, but not of highest quality or in small amounts of highest quality; 3-Highest quality in moderate or greater amounts (e.g., very large boulders in deep or fast water, large diameter log that is stable, well developed rootwad in deep / fast water, or deep, well-defined, functional pools.

AMOUNT Check ONE (Or 2 & average)	Check ONE (Or 2 & average)
<input type="checkbox"/> UNDERCUT BANKS [1]	<input type="checkbox"/> EXTENSIVE >75% [11]
<input type="checkbox"/> OVERHANGING VEGETATION [1]	<input type="checkbox"/> MODERATE 25-75% [7]
<input type="checkbox"/> SHALLOWS (IN SLOW WATER) [1]	<input checked="" type="checkbox"/> SPARSE 5-<25% [3]
<input type="checkbox"/> ROOTMATS [1]	<input checked="" type="checkbox"/> NEARLY ABSENT <5% [1]
<input type="checkbox"/> POOLS > 70cm [2]	
<input type="checkbox"/> ROOTWADS [1]	
<input type="checkbox"/> BOULDERS [1]	
<input type="checkbox"/> OXBOWS, BACKWATERS [1]	
<input type="checkbox"/> AQUATIC MACROPHYTES [1]	
<input type="checkbox"/> LOGS OR WOODY DEBRIS [1]	

Cover
Maximum 20
6

Comments
COVER TYPES CONSISTENT THROUGHOUT ZONE

3] CHANNEL MORPHOLOGY Check ONE in each category (Or 2 & average)

SINUOSITY	DEVELOPMENT	CHANNELIZATION	STABILITY
<input type="checkbox"/> HIGH [4]	<input type="checkbox"/> EXCELLENT [7]	<input type="checkbox"/> NONE [6]	<input type="checkbox"/> HIGH [3]
<input type="checkbox"/> MODERATE [3]	<input checked="" type="checkbox"/> GOOD [5]	<input type="checkbox"/> RECOVERED [4]	<input checked="" type="checkbox"/> MODERATE [2]
<input type="checkbox"/> LOW [2]	<input checked="" type="checkbox"/> FAIR [3]	<input checked="" type="checkbox"/> RECOVERING [3]	<input type="checkbox"/> LOW [1]
<input checked="" type="checkbox"/> NONE [1]	<input type="checkbox"/> POOR [1]	<input type="checkbox"/> RECENT OR NO RECOVERY [1]	

Channel
Maximum 20
10

Comments
RECOVERING FROM RENAS - TREES REMOVED FROM DAM BANKS DURING RECONSTRUCTION

4] BANK EROSION AND RIPARIAN ZONE Check ONE in each category for **EACH BANK** (Or 2 per bank & average)

EROSION	RIPARIAN WIDTH	FLOOD PLAIN QUALITY
<input checked="" type="checkbox"/> NONE / LITTLE [3]	<input type="checkbox"/> WIDE > 50m [4]	<input type="checkbox"/> FOREST, SWAMP [3]
<input type="checkbox"/> MODERATE [2]	<input type="checkbox"/> MODERATE 10-50m [3]	<input checked="" type="checkbox"/> SHRUB OR OLD FIELD [2]
<input type="checkbox"/> HEAVY / SEVERE [1]	<input type="checkbox"/> NARROW 5-10m [2]	<input type="checkbox"/> RESIDENTIAL, PARK, NEW FIELD [1]
	<input type="checkbox"/> VERY NARROW < 5m [1]	<input type="checkbox"/> MINING / CONSTRUCTION [0]
	<input checked="" type="checkbox"/> NONE [0]	<input type="checkbox"/> FENCED PASTURE [1]
		<input type="checkbox"/> OPEN PASTURE, ROWCROP [0]

Riparian
Maximum 10
3

Comments
Indicate predominant land use(s) past 100m riparian.

5] POOL / GLIDE AND RIFFLE / RUN QUALITY

MAXIMUM DEPTH Check ONE (ONLY!)	CHANNEL WIDTH Check ONE (Or 2 & average)	CURRENT VELOCITY Check ALL that apply
<input checked="" type="checkbox"/> > 1m [6]	<input type="checkbox"/> POOL WIDTH > RIFFLE WIDTH [2]	<input type="checkbox"/> TORRENTIAL [-1]
<input type="checkbox"/> 0.7-<1m [4]	<input type="checkbox"/> POOL WIDTH = RIFFLE WIDTH [1]	<input checked="" type="checkbox"/> SLOW [1]
<input type="checkbox"/> 0.4-<0.7m [2]	<input checked="" type="checkbox"/> POOL WIDTH < RIFFLE WIDTH [0]	<input type="checkbox"/> INTERSTITIAL [-1]
<input type="checkbox"/> 0.2-<0.4m [1]		<input checked="" type="checkbox"/> FAST [1]
<input type="checkbox"/> < 0.2m [0]		<input type="checkbox"/> INTERMITTENT [-2]
		<input checked="" type="checkbox"/> MODERATE [1]
		<input type="checkbox"/> EDDIES [1]

Pool / Current
Maximum 12
9

Comments
Indicate for functional riffles; Best areas must be large enough to support a population of riffle-obligate species: Check ONE (Or 2 & average). NO RIFFLE [metric=0]

RIFFLE DEPTH	RUN DEPTH	RIFFLE / RUN SUBSTRATE	RIFFLE / RUN EMBEDDEDNESS
<input type="checkbox"/> BEST AREAS > 10cm [2]	<input type="checkbox"/> MAXIMUM > 50cm [2]	<input checked="" type="checkbox"/> STABLE (e.g., Cobble, Boulder) [2]	<input type="checkbox"/> NONE [2]
<input checked="" type="checkbox"/> BEST AREAS 5-10cm [1]	<input checked="" type="checkbox"/> MAXIMUM < 50cm [1]	<input type="checkbox"/> MOD. STABLE (e.g., Large Gravel) [1]	<input type="checkbox"/> LOW [1]
<input type="checkbox"/> BEST AREAS < 5cm [metric=0]		<input type="checkbox"/> UNSTABLE (e.g., Fine Gravel, Sand) [0]	<input checked="" type="checkbox"/> MODERATE [0]
			<input type="checkbox"/> EXTENSIVE [-1]

Riffle / Run
Maximum 8
4

Comments

6] GRADIENT (33.3 ft/mi) VERY LOW - LOW [2-4] MODERATE [6-10] HIGH - VERY HIGH [10-6]

DRAINAGE AREA (8.9 mi²) VERY LOW - LOW [2-4] MODERATE [6-10] HIGH - VERY HIGH [10-6]

%POOL: **%GLIDE:** **Gradient** Maximum 10 8

%RUN: **%RIFFLE:**

Comment RE: Reach consistency/Is reach typical of stream?, Recreation/Observed - Inferred, Other/Sampling observations, Concerns, Access directions, etc.

AJ SAMPLED REACH

Check ALL that apply

METHOD

- BOAT
- WADE
- L. LINE
- OTHER

STAGE

- 1st - sample pass - 2nd
- HIGH
- UP
- NORMAL
- LOW
- DRY

DISTANCE

- 0.5 Km
- 0.2 Km
- 0.15 Km
- 0.12 Km
- OTHER

CLARITY

- 1st - sample pass - 2nd
- < 20 cm
- 20-40 cm
- 40-70 cm
- > 70 cm / CTB
- SECCHI DEPTH

meters

CANOPY

- > 85% - OPEN
- 55% - < 85%
- 30% - < 55%
- 10% - < 30%
- < 10% - CLOSED

CJ RECREATION

- AREA DEPTH
- > 100ft²
- > 3ft

BJAESTHETICS

- NUISANCE ALGAE
- INVASIVE MACROPHYTES
- EXCESS TURBIDITY
- DISCOLORATION
- FOAM / SCUM
- OIL SHEEN
- TRASH / LITTER
- NUISANCE ODOR
- SLUDGE DEPOSITS
- CSOs/ISSOs/OUTFALLS

DJ MAINTENANCE

- PUBLIC / PRIVATE / BOTH / NA
- ACTIVE / HISTORIC / BOTH / NA
- YOUNG-SUCCESSION-OLD
- SPRAY / SNAG / REMOVED
- MODIFIED / DIPPED OUT / NA
- LEVEED / ONE SIDED
- RELOCATED / CUTOFFS
- MOVING-BEDLOAD-STABLE
- ARMoured / SLUMPS
- ISLANDS / SCOURED
- IMPOUNDED / DESICCATED
- FLOOD CONTROL / DRAINAGE

EJ ISSUES

- WWTP / CSO / NPDES / INDUSTRY
- HARDENED / URBAN / DIRT & GRIME
- CONTAMINATED / LANDFILL
- BMPs - CONSTRUCTION-SEDIMENT
- LOGGING / IRRIGATION / COOLING
- BANK / EROSION / SURFACE
- FALSE BANK / MANURE / LAGOON
- WASH H₂O / TILE / H₂O TABLE
- ACID / MINE / QUARRY / FLOW
- NATURAL / WETLAND / STAGNANT
- PARK / GOLF / LAWN / HOME
- ATMOSPHERE / DATA PAUCITY

FJ MEASUREMENTS

- \bar{x} width
- \bar{x} depth
- max. depth
- \bar{x} bankfull width
- bankfull \bar{x} depth
- W/D ratio
- bankfull max. depth
- floodprone \bar{x} width
- entrench. ratio

Legacy Tree:

Stream Drawing:

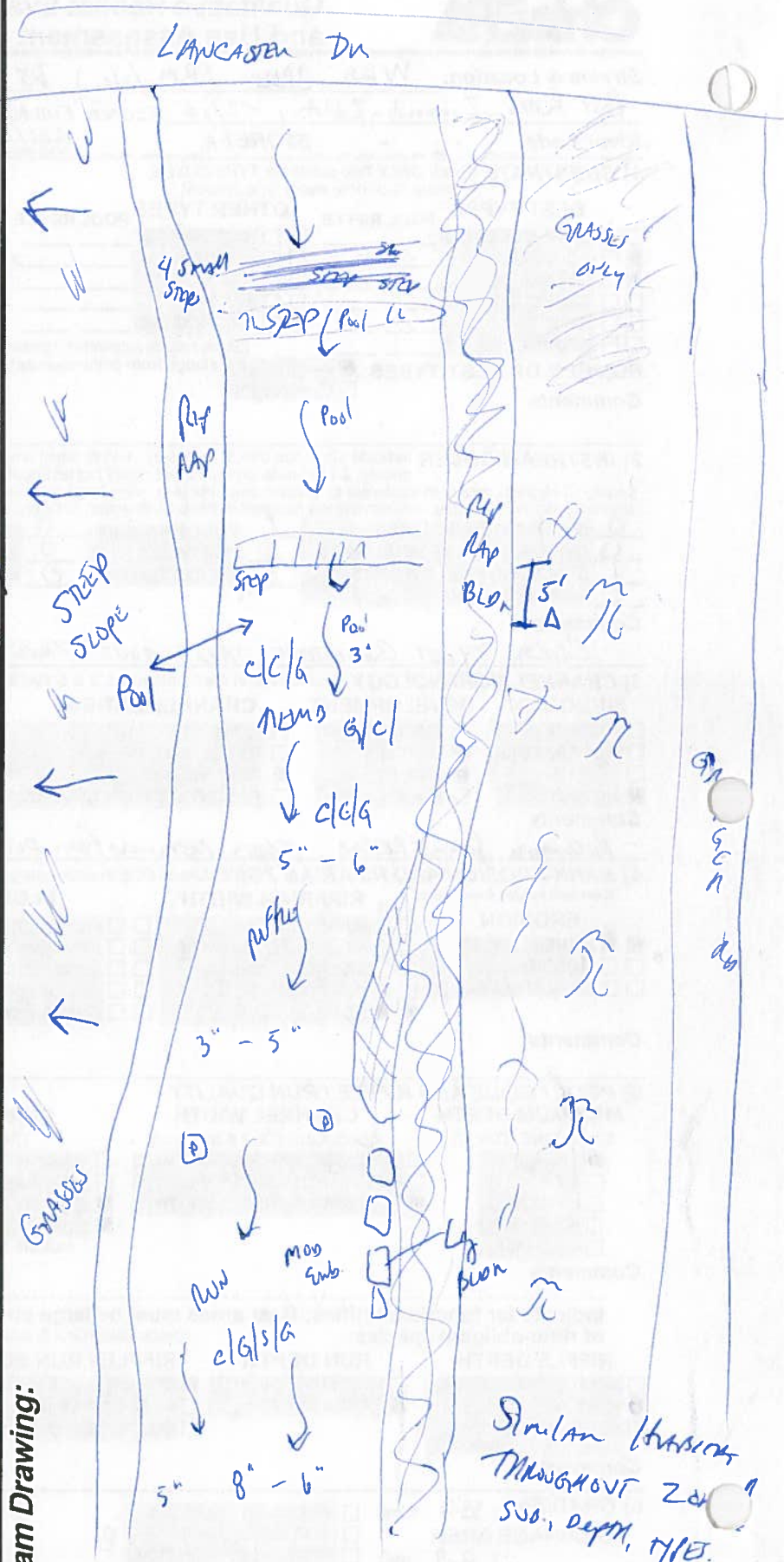

Similar habitats throughout reach
swamp depth, etc.