

Stream & Location: Tinkers Creek (US of Northfield Rd Bridge, Metroparks Bedford Chagrin Pkwy) RM: 1.00 Date: 7/31/17

River Code: - STORET #: - Scorer's Full Name & Affiliation: Northeast Ohio Regional Sewer District Office verified location

1] SUBSTRATE Check ONLY Two substrate TYPE BOXES; estimate % for note every type present. Check ONE (Or 2 & average). Includes categories: BEST TYPES, OTHER TYPES, ORIGIN, QUALITY. Includes handwritten calculations: 8+7+2+1+0=17.

2] INSTREAM COVER Indicate presence 0 to 3: 0-Absent; 1-Very small amounts or if more common of marginal quality; 2-Moderate amounts, but not of highest quality or in small amounts of highest quality; 3-Highest quality in moderate or greater amounts. Includes categories: UNDERCUT BANKS, OVERHANGING VEGETATION, SHALLOWS, ROOTMATS, POOLS, ROOTWADS, BOULDERS, OXBOWS, AQUATIC MACROPHYTES, LOGS OR WOODY DEBRIS. Includes handwritten calculations: 9+7=16.

3] CHANNEL MORPHOLOGY Check ONE in each category (Or 2 & average). Includes categories: SINUOSITY, DEVELOPMENT, CHANNELIZATION, STABILITY. Includes handwritten calculations: 2+3+0+2=13.

4] BANK EROSION AND RIPARIAN ZONE Check ONE in each category for EACH BANK (Or 2 per bank & average). Includes categories: EROSION, RIPARIAN WIDTH, FLOOD PLAIN QUALITY, CONSERVATION TILLAGE, URBAN OR INDUSTRIAL, MINING / CONSTRUCTION. Includes handwritten calculations: 3+3+4=10.

5] POOL / GLIDE AND RIFFLE / RUN QUALITY MAXIMUM DEPTH, CHANNEL WIDTH, CURRENT VELOCITY. Includes categories: MAXIMUM DEPTH, CHANNEL WIDTH, CURRENT VELOCITY, Recreation Potential. Includes handwritten calculations: 2+0+4=6.

Indicate for functional riffles; Best areas must be large enough to support a population of riffle-obligate species: RIFFLE DEPTH, RUN DEPTH, RIFFLE / RUN SUBSTRATE, RIFFLE / RUN EMBEDDEDNESS. Includes handwritten calculations: 2+1+0.5+0=4.5.

6] GRADIENT (4.69 ft/mi) DRAINAGE AREA (78.0 mi^2). Includes categories: GRADIENT, DRAINAGE AREA, % POOL, % GLIDE, % RUN, % RIFFLE. Includes handwritten calculations: 6.

17+16+13+10+6+4.5+6



Qualitative Habitat Evaluation Index and Use Assessment Field Sheet

QHEI Score: 56

Stream & Location: Tinkers Creek (upstream of Dunham Rd) **RM:** 2.25 **Date:** 07/26/17

Scorers Full Name & Affiliation: Cathy Zamorsky / D. Dunham (NEOSD) Northeast Ohio Regional Sewer District
River Code: **STORET #:** **Lat./ Long.:** 41.3742 / 81.5785 **Office verified location**

1] SUBSTRATE Check ONLY Two substrate TYPE BOXES; estimate % or note every type present

<p>BEST TYPES</p> <input type="checkbox"/> BLDR / SLABS [10] <input type="checkbox"/> BOULDER [9] <input type="checkbox"/> COBBLE [8] <input type="checkbox"/> GRAVEL [7] <input type="checkbox"/> SAND [6] <input checked="" type="checkbox"/> BEDROCK [5]	<p>POOL RIFFLE</p> <input checked="" type="checkbox"/> <input checked="" type="checkbox"/> <input checked="" type="checkbox"/> <input checked="" type="checkbox"/> <input checked="" type="checkbox"/> <input checked="" type="checkbox"/> <input checked="" type="checkbox"/> <input checked="" type="checkbox"/>	<p>OTHER TYPES</p> <input type="checkbox"/> HARDPAN [4] <input type="checkbox"/> DETRITUS [3] <input type="checkbox"/> MUCK [2] <input type="checkbox"/> SILT [2] <input type="checkbox"/> ARTIFICIAL [0]	<p>POOL RIFFLE</p> <input type="checkbox"/> <input type="checkbox"/> <input type="checkbox"/> <input type="checkbox"/> <input type="checkbox"/> <input type="checkbox"/> <input type="checkbox"/> <input type="checkbox"/>	<p>ORIGIN</p> <input type="checkbox"/> LIMESTONE [1] <input type="checkbox"/> TILLS [1] <input type="checkbox"/> WETLANDS [0] <input type="checkbox"/> HARDPAN [0] <input type="checkbox"/> SANDSTONE [0] <input type="checkbox"/> RIP/RAP [0] <input type="checkbox"/> LACUSTURINE [0] <input type="checkbox"/> SHALE [-1] <input type="checkbox"/> COAL FINES [-2]	<p>QUALITY</p> <input type="checkbox"/> HEAVY [-2] <input type="checkbox"/> MODERATE [-1] <input type="checkbox"/> NORMAL [0] <input type="checkbox"/> FREE [1] <input checked="" type="checkbox"/> EXTENSIVE [-2] <input checked="" type="checkbox"/> MODERATE [-1] <input type="checkbox"/> NORMAL [0] <input type="checkbox"/> NONE [1]	<p>Substrate</p> <div style="border: 1px solid black; border-radius: 50%; width: 40px; height: 40px; display: flex; align-items: center; justify-content: center; margin: 5px;"> 14.5 </div> <p>Maximum 20</p>
---	--	--	--	---	--	--

NUMBER OF BEST TYPES: 4 or more [2] 3 or less [0]

Comments: predomin. bedrock & G/C

2] INSTREAM COVER Indicate presence 0 to 3: 0-Absent; 1-Very small amounts or if more common of marginal quality; 2-Moderate amounts, but not of highest quality or in small amounts of highest quality; 3-Highest quality in moderate or greater amounts (e.g., very large boulders in deep or fast water, large diameter log that is stable, well developed rootwad in deep / fast water, or deep, well-defined, functional pools.

<p>UNDERCUT BANKS [1] <input type="checkbox"/></p> <p>OVERHANGING VEGETATION [1] <input type="checkbox"/></p> <p>SHALLOWS (IN SLOW WATER) [1] <input type="checkbox"/></p> <p>ROOTMATS [1] <input type="checkbox"/></p>	<p>POOLS > 70cm [2] <input type="checkbox"/></p> <p>ROOTWADS [1] <input type="checkbox"/></p> <p>BOULDERS [1] <input type="checkbox"/></p>	<p>OXBOWS, BACKWATERS [1] <input type="checkbox"/></p> <p>AQUATIC MACROPHYTES [1] <input type="checkbox"/></p> <p>LOGS OR WOODY DEBRIS [1] <input type="checkbox"/></p>	<p>AMOUNT</p> <input type="checkbox"/> EXTENSIVE >75% [11] <input type="checkbox"/> MODERATE 25-75% [7] <input checked="" type="checkbox"/> SPARSE 5-25% [3] <input type="checkbox"/> NEARLY ABSENT <5% [1]	<p>Cover</p> <div style="border: 1px solid black; border-radius: 50%; width: 40px; height: 40px; display: flex; align-items: center; justify-content: center; margin: 5px;"> 7 </div> <p>Maximum 20</p>
---	--	--	---	---

Comments: BLDR MOST 20%?

3] CHANNEL MORPHOLOGY Check ONE in each category (Or 2 & average)

<p>SINUOSITY</p> <input type="checkbox"/> HIGH [4] <input type="checkbox"/> MODERATE [3] <input checked="" type="checkbox"/> LOW [2] <input checked="" type="checkbox"/> NONE [1]	<p>DEVELOPMENT</p> <input type="checkbox"/> EXCELLENT [7] <input type="checkbox"/> GOOD [5] <input checked="" type="checkbox"/> FAIR [3] <input type="checkbox"/> POOR [1]	<p>CHANNELIZATION</p> <input checked="" type="checkbox"/> NONE [6] <input type="checkbox"/> RECOVERED [4] <input type="checkbox"/> RECOVERING [3] <input type="checkbox"/> RECENT OR NO RECOVERY [1]	<p>STABILITY</p> <input type="checkbox"/> HIGH [3] <input checked="" type="checkbox"/> MODERATE [2] <input type="checkbox"/> LOW [1]	<p>Channel</p> <div style="border: 1px solid black; border-radius: 50%; width: 40px; height: 40px; display: flex; align-items: center; justify-content: center; margin: 5px;"> 12.5 </div> <p>Maximum 20</p>
---	--	--	---	--

Comments: Riffles "200' Good" PUT POOL SUBSTR. / RUN GOOD

4] BANK EROSION AND RIPARIAN ZONE Check ONE in each category for EACH BANK (Or 2 per bank & average)

<p>EROSION</p> <input checked="" type="checkbox"/> NONE / LITTLE [3] <input type="checkbox"/> MODERATE [2] <input type="checkbox"/> HEAVY / SEVERE [1]	<p>RIPARIAN WIDTH</p> <input type="checkbox"/> WIDE > 50m [4] <input type="checkbox"/> MODERATE 10-50m [3] <input type="checkbox"/> NARROW 5-10m [2] <input checked="" type="checkbox"/> VERY NARROW < 5m [1] <input type="checkbox"/> NONE [0]	<p>FLOOD PLAIN QUALITY</p> <input type="checkbox"/> FOREST, SWAMP [3] <input type="checkbox"/> SHRUB OR OLD FIELD [2] <input checked="" type="checkbox"/> RESIDENTIAL, PARK, NEW FIELD [1] <input type="checkbox"/> FENCED PASTURE [1] <input type="checkbox"/> OPEN PASTURE, ROWCROP [0]	<p>CONSERVATION TILLAGE [1] <input type="checkbox"/></p> <p>URBAN OR INDUSTRIAL [0] <input type="checkbox"/></p> <p>MINING / CONSTRUCTION [0] <input type="checkbox"/></p>	<p>Riparian</p> <div style="border: 1px solid black; border-radius: 50%; width: 40px; height: 40px; display: flex; align-items: center; justify-content: center; margin: 5px;"> 4.5 </div> <p>Maximum 10</p>
---	--	--	---	--

Comments: PARK RD BOTH BANKS

5] POOL / GLIDE AND RIFFLE / RUN QUALITY

<p>MAXIMUM DEPTH</p> <input type="checkbox"/> > 1m [6] <input checked="" type="checkbox"/> 0.7-1m [4] <input type="checkbox"/> 0.4-0.7m [2] <input type="checkbox"/> 0.2-0.4m [1] <input type="checkbox"/> < 0.2m [0]	<p>CHANNEL WIDTH</p> <input type="checkbox"/> POOL WIDTH > RIFFLE WIDTH [2] <input type="checkbox"/> POOL WIDTH = RIFFLE WIDTH [1] <input checked="" type="checkbox"/> POOL WIDTH < RIFFLE WIDTH [0]	<p>CURRENT VELOCITY</p> <input type="checkbox"/> TORRENTIAL [-1] <input checked="" type="checkbox"/> VERY FAST [1] <input checked="" type="checkbox"/> FAST [1] <input checked="" type="checkbox"/> MODERATE [1]	<p>RECREATION POTENTIAL</p> <div style="border: 1px solid black; border-radius: 50%; width: 40px; height: 40px; display: flex; align-items: center; justify-content: center; margin: 5px;"> 7 </div> <p>Maximum 12</p>
--	---	--	--

Comments: Due to bedrock - shifting

Indicate for functional riffles; Best areas must be large enough to support a population of riffle-obligate species: NO RIFFLE [metric=0]

<p>RIFFLE DEPTH</p> <input checked="" type="checkbox"/> BEST AREAS > 10cm [2] <input type="checkbox"/> BEST AREAS 5-10cm [1] <input type="checkbox"/> BEST AREAS < 5cm [metric=0]	<p>RUN DEPTH</p> <input checked="" type="checkbox"/> MAXIMUM > 50cm [2] <input type="checkbox"/> MAXIMUM < 50cm [1]	<p>RIFFLE / RUN SUBSTRATE</p> <input type="checkbox"/> STABLE (e.g., Cobble, Boulder) [2] <input checked="" type="checkbox"/> MOD. STABLE (e.g., Large Gravel) [1] <input type="checkbox"/> UNSTABLE (e.g., Fine Gravel, Sand) [0]	<p>RIFFLE / RUN EMBEDDEDNESS</p> <input type="checkbox"/> NONE [2] <input type="checkbox"/> LOW [1] <input checked="" type="checkbox"/> MODERATE [0] <input type="checkbox"/> EXTENSIVE [-1]	<p>Riffle / Run</p> <div style="border: 1px solid black; border-radius: 50%; width: 40px; height: 40px; display: flex; align-items: center; justify-content: center; margin: 5px;"> 4.5 </div> <p>Maximum 8</p>
--	---	---	--	---

Comments: wa Due to bedrock sub. - may shift

6] GRADIENT (29.41 ft/mi) VERY LOW - LOW [2-4] MODERATE [6-10] HIGH - VERY HIGH [10-6]

DRAINAGE AREA (93.9 mi²)

% POOL: **% GLIDE:**

% RUN: **% RIFFLE:**

Gradient

6

Maximum 10

Comment RE: Reach consistency/ Is reach typical of stream?, Recreation/ Observed - Inferred, Other/ Sampling observations, Concerns, Access directions, etc.

AJ SAMPLED REACH

Check ALL that apply

METHOD

- BOAT
 - WADE
 - L. LINE
 - OTHER
- DISTANCE**
- 0.5 Km
 - 0.2 Km
 - 0.15 Km
 - 0.12 Km
 - OTHER

STAGE

- 1st -sample pass-- 2nd
- HIGH
 - UP
 - NORMAL
 - LOW
 - DRY

CLARITY

- < 20 cm
- 20-40 cm
- 40-70 cm
- > 70 cm/ CTB
- SECCHI DEPTH

1st _____ cm

2nd _____ cm

CANOPY

- > 85%- OPEN
- 55%-85%
- 30%-55%
- 10%-30%
- <10%- CLOSED

CJ RECREATION

AREA DEPTH POOL: >100ft? >3ft

BJ AESTHETICS

- NUISANCE ALGAE
- INVASIVE MACROPHYTES
- EXCESS TURBIDITY
- DISCOLORATION
- FOAM/ SCUM
- OIL SHEEN
- TRASH/ LITTER
- NUISANCE ODOR
- SLUDGE DEPOSITS
- CSOs/SSOs/OUTFALLS

DJ MAINTENANCE

- PUBLIC / PRIVATE / BOTH / NA
- ACTIVE / HISTORIC / BOTH / NA
- YOUNG-SUCCESSION-OLD
- SPRAY / SNAG / REMOVED
- MODIFIED / DIPPED OUT / NA
- LEVEED / ONE SIDED
- RELOCATED / CUTOFFS
- MOVING-BEDLOAD-STABLE
- ARMoured / SLUMPS
- ISLANDS / SCoured
- IMPounded / DESICCATED
- FLOOD CONTROL / DRAINAGE

Circle some & COMMENT

(X) UD
 ABOVE H2O 4ft
 NOT FOR

EJ ISSUES

- WWTP / CSO / NPDES / INDUSTRY
- HARDENED / URBAN / DIRT&GRIME
- CONTAMINATED / LANDFILL
- BMPs-CONSTRUCTION-SEDIMENT
- LOGGING / IRRIGATION / COOLING
- BANK / EROSION / SURFACE
- FALSE BANK / MANURE / LAGOON
- WASH H2O / TILE / H2O TABLE
- ACID / MINE / QUARRY / FLOW
- NATURAL / WETLAND / STAGNANT
- PARK / GOLF / LAWN / HOME
- ATMOSPHERE / DATA PAUCITY

FJ MEASUREMENTS

- \bar{x} width
- \bar{x} depth
- max. depth
- \bar{x} bankfull width
- bankfull \bar{x} depth
- W/D ratio
- bankfull max. depth
- floodprone \bar{x}^2 width
- entrench. ratio

Legacy Tree:

Stream Drawing:

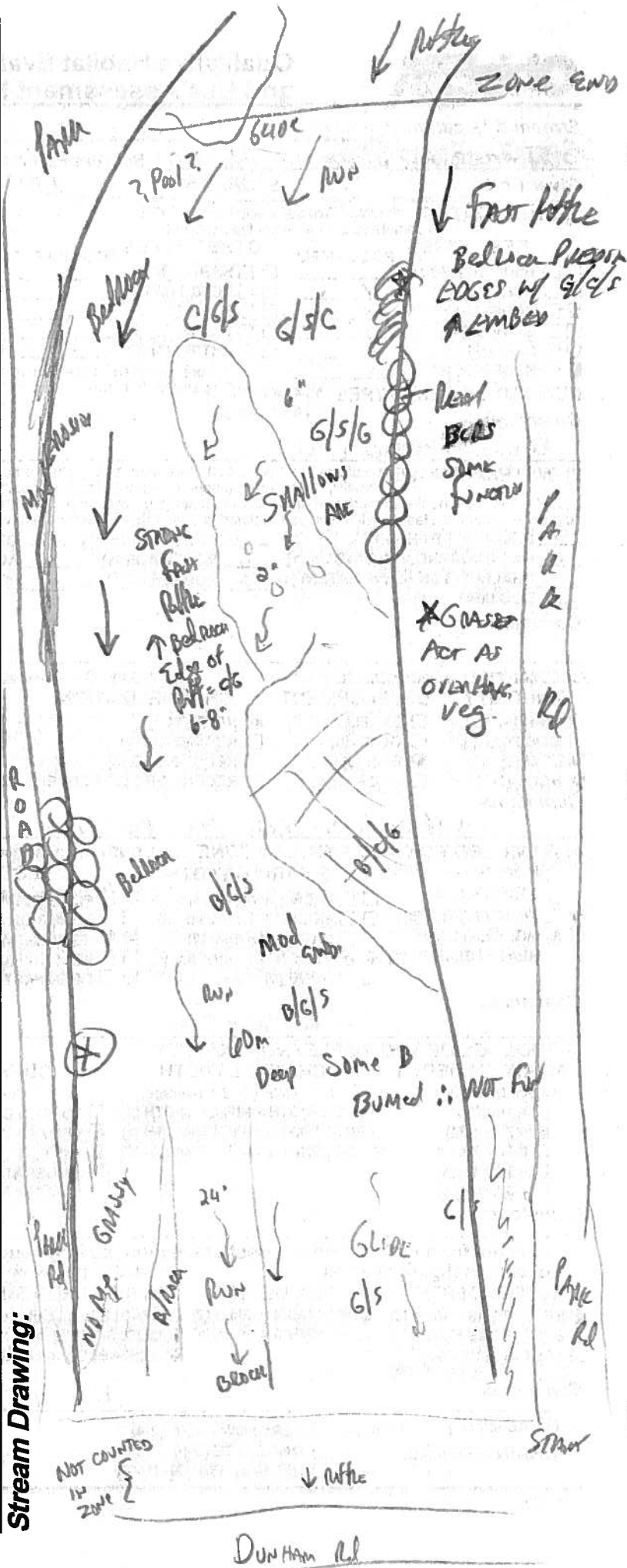

Stream & Location: Tinkers creek (upstream of canal road) **RM:** 0.15 **Date:** 07/26/17

Carry Zamorsky / D. Phillips (NEORSO) **Scorers Full Name & Affiliation:** Northeast Ohio Regional Sewer District
River Code: _____ **STORET #:** _____ **Lat./ Long.:** 41.3654 181.6083 (NAD 83 - decimal) **Office verified location**

1) SUBSTRATE Check ONLY Two substrate TYPE BOXES; estimate % or note every type present

<p>BEST TYPES</p> <input type="checkbox"/> BLDR/SLABS [10] <input type="checkbox"/> BOULDER [9] <input checked="" type="checkbox"/> COBBLE [8] <input checked="" type="checkbox"/> GRAVEL [7] <input type="checkbox"/> SAND [6] <input type="checkbox"/> BEDROCK [5]	<p>POOL RIFFLE</p> <input checked="" type="checkbox"/> <input checked="" type="checkbox"/> <input checked="" type="checkbox"/> <input checked="" type="checkbox"/> <input checked="" type="checkbox"/> <input checked="" type="checkbox"/> <input checked="" type="checkbox"/> <input checked="" type="checkbox"/>	<p>OTHER TYPES</p> <input type="checkbox"/> HARDPAN [4] <input type="checkbox"/> DETRITUS [3] <input type="checkbox"/> MUCK [2] <input type="checkbox"/> SILT [2] <input type="checkbox"/> ARTIFICIAL [0]	<p>POOL RIFFLE</p> <input type="checkbox"/> <input type="checkbox"/> <input checked="" type="checkbox"/> <input type="checkbox"/> <input type="checkbox"/> <input type="checkbox"/>	<p>ORIGIN</p> <input type="checkbox"/> LIMESTONE [1] <input checked="" type="checkbox"/> TILLS [1] <input type="checkbox"/> WETLANDS [0] <input type="checkbox"/> HARDPAN [0] <input type="checkbox"/> SANDSTONE [0] <input type="checkbox"/> RIP/RAP [0] <input type="checkbox"/> LACUSTURINE [0] <input type="checkbox"/> SHALE [-1] <input type="checkbox"/> COAL FINES [-2]	<p>QUALITY</p> <input type="checkbox"/> HEAVY [-2] <input type="checkbox"/> MODERATE [-1] <input checked="" type="checkbox"/> NORMAL [0] <input type="checkbox"/> FREE [1] <input type="checkbox"/> EXTENSIVE [-2] <input checked="" type="checkbox"/> MODERATE [-1] <input checked="" type="checkbox"/> NORMAL [0] <input type="checkbox"/> NONE [1]	<p>Substrate</p> <div style="border: 1px solid black; border-radius: 50%; width: 40px; height: 40px; display: flex; align-items: center; justify-content: center; margin: 5px;"> 17.5 </div> <p>Maximum 20</p>
--	--	--	--	--	---	--

NUMBER OF BEST TYPES: 4 or more [2] 3 or less [0]

Comments: _____

2) INSTREAM COVER Indicate presence 0 to 3: 0-Absent; 1-Very small amounts or if more common of marginal quality; 2-Moderate amounts, but not of highest quality or in small amounts of highest quality; 3-Highest quality in moderate or greater amounts (e.g., very large boulders in deep or fast water, large diameter log that is stable, well developed rootwad in deep / fast water, or deep, well-defined, functional pools.)

<p><input type="checkbox"/> UNDERCUT BANKS [1] <input type="checkbox"/> OVERHANGING VEGETATION [1] <input checked="" type="checkbox"/> SHALLOWS (IN SLOW WATER) [1] <input type="checkbox"/> ROOTMATS [1]</p>	<p><input type="checkbox"/> POOLS > 70cm [2] <input type="checkbox"/> ROOTWADS [1] <input type="checkbox"/> BOULDERS [1]</p>	<p><input type="checkbox"/> OXBOWS, BACKWATERS [1] <input type="checkbox"/> AQUATIC MACROPHYTES [1] <input type="checkbox"/> LOGS OR WOODY DEBRIS [1]</p>	<p>AMOUNT</p> <input type="checkbox"/> EXTENSIVE >75% [11] <input type="checkbox"/> MODERATE 25-75% [7] <input checked="" type="checkbox"/> SPARSE 5-<25% [3] <input type="checkbox"/> NEARLY ABSENT <5% [1]
--	---	---	--

Comments: Pool - only ONE Pool - only 2 pool NOT MUCH COVER

Cover Maximum 20 8

3) CHANNEL MORPHOLOGY Check ONE in each category (Or 2 & average)

<p>SINUOSITY</p> <input type="checkbox"/> HIGH [4] <input type="checkbox"/> MODERATE [3] <input checked="" type="checkbox"/> LOW [2] <input type="checkbox"/> NONE [1]	<p>DEVELOPMENT</p> <input type="checkbox"/> EXCELLENT [7] <input checked="" type="checkbox"/> GOOD [5] <input type="checkbox"/> FAIR [3] <input type="checkbox"/> POOR [1]	<p>CHANNELIZATION</p> <input checked="" type="checkbox"/> NONE [8] <input type="checkbox"/> RECOVERED [4] <input type="checkbox"/> RECOVERING [3] <input type="checkbox"/> RECENT OR NO RECOVERY [1]	<p>STABILITY</p> <input type="checkbox"/> HIGH [3] <input checked="" type="checkbox"/> MODERATE [2] <input type="checkbox"/> LOW [1]
--	--	--	---

Comments: Pool - Poor Riffle/run - Very Good RR ↑ EMBEDD

Channel Maximum 20 14.5

4) BANK EROSION AND RIPARIAN ZONE Check ONE in each category for EACH BANK (Or 2 per bank & average)

<p>EROSION</p> <input checked="" type="checkbox"/> NONE/LITTLE [3] <input type="checkbox"/> MODERATE [2] <input type="checkbox"/> HEAVY/SEVERE [1]	<p>RIPARIAN WIDTH</p> <input type="checkbox"/> WIDE > 50m [4] <input type="checkbox"/> MODERATE 10-50m [3] <input type="checkbox"/> NARROW 5-10m [2] <input type="checkbox"/> VERY NARROW < 5m [1] <input type="checkbox"/> NONE [0]	<p>FLOOD PLAIN QUALITY</p> <input checked="" type="checkbox"/> FOREST, SWAMP [3] <input type="checkbox"/> SHRUB OR OLD FIELD [2] <input type="checkbox"/> RESIDENTIAL, PARK, NEW FIELD [1] <input type="checkbox"/> FENCED PASTURE [1] <input type="checkbox"/> OPEN PASTURE, ROWCROP [0]	<p>CONSERVATION TILLAGE [1] URBAN OR INDUSTRIAL [0] MINING / CONSTRUCTION [0]</p> <p>Indicate predominant land use(s) past 100m riparian.</p>
---	---	--	--

Comments: NEW CROP / SHRUB RR

Riparian Maximum 10 7.25

5) POOL / GLIDE AND RIFFLE / RUN QUALITY

<p>MAXIMUM DEPTH</p> <p>Check ONE (ONLY!)</p> <input checked="" type="checkbox"/> > 1m [6] <input type="checkbox"/> 0.7-<1m [4] <input type="checkbox"/> 0.4-<0.7m [2] <input type="checkbox"/> 0.2-<0.4m [1] <input type="checkbox"/> < 0.2m [0]	<p>CHANNEL WIDTH</p> <p>Check ONE (Or 2 & average)</p> <input type="checkbox"/> POOL WIDTH > RIFFLE WIDTH [2] <input type="checkbox"/> POOL WIDTH = RIFFLE WIDTH [1] <input checked="" type="checkbox"/> POOL WIDTH < RIFFLE WIDTH [0]	<p>CURRENT VELOCITY</p> <p>Check ALL that apply</p> <input type="checkbox"/> TORRENTIAL [-1] <input type="checkbox"/> VERY FAST [1] <input checked="" type="checkbox"/> FAST [1] <input checked="" type="checkbox"/> MODERATE [1]	<p><input checked="" type="checkbox"/> SLOW [1] <input type="checkbox"/> INTERSTITIAL [-1] <input type="checkbox"/> INTERMITTENT [-2] <input type="checkbox"/> EDDIES [1]</p> <p>Indicate for reach - pools and riffles.</p>
--	---	---	---

Comments: _____

Recreation Potential

Primary Contact

Secondary Contact

(circle one and comment on back)

Pool / Current Maximum 12 9

Indicate for functional riffles; Best areas must be large enough to support a population of riffle-obligate species: NO RIFFLE [metric=0]

Check ONE (Or 2 & average).

<p>RIFFLE DEPTH</p> <input checked="" type="checkbox"/> BEST AREAS > 10cm [2] <input type="checkbox"/> BEST AREAS 5-10cm [1] <input type="checkbox"/> BEST AREAS < 5cm [metric=0]	<p>RUN DEPTH</p> <input checked="" type="checkbox"/> MAXIMUM > 50cm [2] <input type="checkbox"/> MAXIMUM < 50cm [1]	<p>RIFFLE / RUN SUBSTRATE</p> <input checked="" type="checkbox"/> STABLE (e.g., Cobble, Boulder) [2] <input type="checkbox"/> MOD. STABLE (e.g., Large Gravel) [1] <input type="checkbox"/> UNSTABLE (e.g., Fine Gravel, Sand) [0]	<p>RIFFLE / RUN EMBEDDEDNESS</p> <input type="checkbox"/> NONE [2] <input checked="" type="checkbox"/> LOW [1] <input type="checkbox"/> MODERATE [0] <input type="checkbox"/> EXTENSIVE [-1]
--	---	---	--

Comments: _____

Riffle / Run Maximum 8 6.5

6) GRADIENT (9.52 ft/mi) VERY LOW - LOW [2-4] MODERATE [6-10] HIGH - VERY HIGH [10-6]

DRAINAGE AREA (96.3 mi²)

% POOL: 5 **% GLIDE:** 20

% RUN: 65 **% RIFFLE:** 10

Gradient Maximum 10 10

Comment RE: Reach consistency/ Is reach typical of stream? - Inferred, Other/ Sampling observations, Concerns, Access directions, etc.

AJ SAMPLED REACH

Check ALL that apply

METHOD

- BOAT
- WADE
- L. LINE
- OTHER
- DISTANCE
- 0.5 Km
- 0.2 Km
- 0.15 Km
- 0.12 Km
- OTHER

STAGE

- HIGH
- UP
- NORMAL
- LOW
- DRY

CLARITY

- 1st -sample pass-- 2nd
- < 20 cm
- 20-40 cm
- 40-70 cm
- > 70 cm/CTB
- SECCHI DEPTH
- 1st _____ cm
- 2nd _____ cm

CANOPY

- > 85% - OPEN
- 55% - 85%
- 30% - 55%
- 10% - 30%
- < 10% - CLOSED

BJ AESTHETICS

- NUISANCE ALGAE
- INVASIVE MACROPHYTES
- EXCESS TURBIDITY
- DISCOLORATION
- FOAM / SCUM
- OIL SHEEN
- TRASH / LITTER
- NUISANCE ODOR
- SLUDGE DEPOSITS
- CSOs/SOs/OUTFALLS

CJ RECREATION

- AREA DEPTH
- > 100ft²
- > 3ft POOL:

DJ MAINTENANCE

- PUBLIC / PRIVATE / BOTH / NA
- ACTIVE / HISTORIC / BOTH / NA
- YOUNG-SUCCESSION-OLD
- SPRAY / SNAG / REMOVED
- MODIFIED / DIPPED OUT / NA
- LEVEED / ONE-SIDED
- RELOCATED / CUTOFFS
- MOVING-BEDLOAD-STABLE
- ARMOURD / SLUMPS
- ISLANDS / SCOURED
- IMPOUNDED / DESICCATED
- FLOOD CONTROL / DRAINAGE

EJ ISSUES

- WWTP / CSO / NPDES / INDUSTRY
- HARDENED / URBAN / DIRT&GRIME
- CONTAMINATED / LANDFILL
- BMPs-CONSTRUCTION-SEDIMENT
- LOGGING / IRRIGATION / COOLING
- BANK / EROSION / SURFACE
- FALSE BANK / MANURE / LAGOON
- WASH H₂O / TILE / H₂O TABLE
- ACID / MINE / QUARRY / FLOW
- NATURAL / WETLAND / STAGNANT
- PARK / GOLF / LAWN / HOME
- ATMOSPHERE / DATA PAUCITY

FJ MEASUREMENTS

- \bar{x} width
- \bar{x} depth
- max. depth
- \bar{x} bankfull width
- bankfull \bar{x} depth
- W/D ratio
- bankfull max. depth
- floodprone \bar{x}^2 width
- entrench. ratio

Legacy Tree:

Stream Drawing:

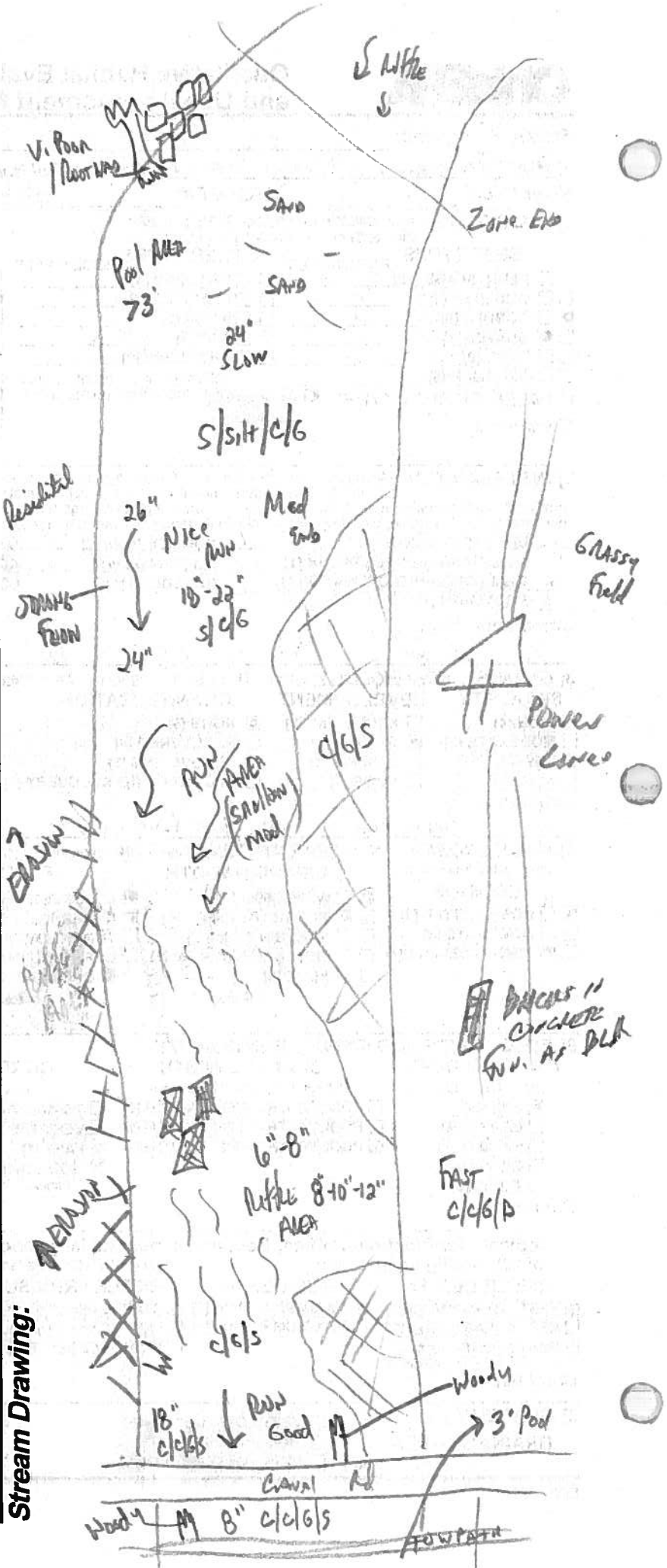



Qualitative Habitat Evaluation Index and Use Assessment Field Sheet

QHEI Score: **69**

Stream & Location: Wood Creek, Tinkers Creek Trib (US of Burton Rd) RM: 0.15 Date: 7/13/17

Molson Scorers Full Name & Affiliation: Northeast Ohio Regional Sewer District

River Code: - - - - - STORET #: - - - - - Lat./ Long.: 41.3774181 81.5752 Office verified location

1) **SUBSTRATE** Check ONLY Two substrate TYPE BOXES; estimate % or note every type present

BEST TYPES	POOL RIFFLE	OTHER TYPES	POOL RIFFLE	ORIGIN	QUALITY
<input type="checkbox"/> BLDR / SLABS [10]	<input checked="" type="checkbox"/> <input checked="" type="checkbox"/>	<input type="checkbox"/> HARDPAN [4]	<input type="checkbox"/> <input type="checkbox"/>	<input type="checkbox"/> LIMESTONE [1]	<input type="checkbox"/> HEAVY [-2]
<input type="checkbox"/> BOULDER [9]	<input checked="" type="checkbox"/> <input checked="" type="checkbox"/>	<input type="checkbox"/> DETRITUS [3]	<input type="checkbox"/> <input type="checkbox"/>	<input type="checkbox"/> TILLS [1]	<input type="checkbox"/> MODERATE [-1]
<input type="checkbox"/> COBBLE [8]	<input checked="" type="checkbox"/> <input checked="" type="checkbox"/>	<input type="checkbox"/> MUCK [2]	<input type="checkbox"/> <input type="checkbox"/>	<input type="checkbox"/> WETLANDS [0]	<input type="checkbox"/> NORMAL [0]
<input type="checkbox"/> GRAVEL [7]	<input checked="" type="checkbox"/> <input checked="" type="checkbox"/>	<input type="checkbox"/> SILT [2]	<input type="checkbox"/> <input type="checkbox"/>	<input type="checkbox"/> HARDPAN [0]	<input checked="" type="checkbox"/> FREE [1]
<input type="checkbox"/> SAND [6]	<input checked="" type="checkbox"/> <input checked="" type="checkbox"/>	<input type="checkbox"/> ARTIFICIAL [0]	<input type="checkbox"/> <input type="checkbox"/>	<input type="checkbox"/> SANDSTONE [0]	<input type="checkbox"/> EXTENSIVE [-2]
<input checked="" type="checkbox"/> BEDROCK [5]	<input checked="" type="checkbox"/> <input checked="" type="checkbox"/>			<input type="checkbox"/> RIP/RAP [0]	<input type="checkbox"/> MODERATE [-1]

NUMBER OF BEST TYPES: 4 or more [2] 3 or less [0]

Comments

Substrate Maximum 20 **17.5**

2) **INSTREAM COVER** Indicate presence 0 to 3: 0-Absent; 1-Very small amounts or if more common of marginal quality; 2-Moderate amounts, but not of highest quality or in small amounts of highest quality; 3-Highest quality in moderate or greater amounts (e.g., very large boulders in deep or fast water, large diameter log that is stable, well developed rootwad in deep / fast water, or deep, well-defined, functional pools.

<input checked="" type="checkbox"/> UNDERCUT BANKS [1]	<input type="checkbox"/> POOLS > 70cm [2]	<input type="checkbox"/> OXBOWS, BACKWATERS [1]
<input type="checkbox"/> OVERHANGING VEGETATION [1]	<input type="checkbox"/> ROOTWADS [1]	<input type="checkbox"/> AQUATIC MACROPHYTES [1]
<input type="checkbox"/> SHALLOWS (IN SLOW WATER) [1]	<input type="checkbox"/> BOULDERS [1]	<input type="checkbox"/> LOGS OR WOODY DEBRIS [1]
<input type="checkbox"/> ROOTMATS [1]		

AMOUNT Check ONE (Or 2 & average)

EXTENSIVE >75% [11] MODERATE 25-75% [7] SPARSE 5-<25% [3] NEARLY ABSENT <5% [1]

Comments

Cover Maximum 20 **9**

3) **CHANNEL MORPHOLOGY** Check ONE in each category (Or 2 & average)

SINUOSITY	DEVELOPMENT	CHANNELIZATION	STABILITY
<input type="checkbox"/> HIGH [4]	<input type="checkbox"/> EXCELLENT [7]	<input type="checkbox"/> NONE [6]	<input type="checkbox"/> HIGH [3]
<input checked="" type="checkbox"/> MODERATE [3]	<input checked="" type="checkbox"/> GOOD [5]	<input type="checkbox"/> RECOVERED [4]	<input checked="" type="checkbox"/> MODERATE [2]
<input checked="" type="checkbox"/> LOW [2]	<input type="checkbox"/> FAIR [3]	<input type="checkbox"/> RECOVERING [3]	<input type="checkbox"/> LOW [1]
<input type="checkbox"/> NONE [1]	<input type="checkbox"/> POOR [1]	<input type="checkbox"/> RECENT OR NO RECOVERY [1]	

Comments

Channel Maximum 20 **15.5**

4) **BANK EROSION AND RIPARIAN ZONE** Check ONE in each category for EACH BANK (Or 2 per bank & average)

EROSION	RIPARIAN WIDTH	FLOOD PLAIN QUALITY	CONSERVATION
<input checked="" type="checkbox"/> NONE / LITTLE [3]	<input type="checkbox"/> WIDE > 50m [4]	<input type="checkbox"/> FOREST, SWAMP [3]	<input type="checkbox"/> CONSERVATION TILLAGE [1]
<input type="checkbox"/> MODERATE [2]	<input type="checkbox"/> MODERATE 10-50m [3]	<input type="checkbox"/> SHRUB OR OLD FIELD [2]	<input type="checkbox"/> URBAN OR INDUSTRIAL [0]
<input type="checkbox"/> HEAVY / SEVERE [1]	<input type="checkbox"/> NARROW 5-10m [2]	<input type="checkbox"/> RESIDENTIAL, PARK, NEW FIELD [1]	<input type="checkbox"/> MINING / CONSTRUCTION [0]
	<input type="checkbox"/> VERY NARROW < 5m [1]	<input type="checkbox"/> FENCED PASTURE [1]	
	<input type="checkbox"/> NONE [0]	<input type="checkbox"/> OPEN PASTURE, ROWCROP [0]	

Comments

Riparian Maximum 10 **9.5**

5) **POOL / GLIDE AND RIFFLE / RUN QUALITY**

MAXIMUM DEPTH	CHANNEL WIDTH	CURRENT VELOCITY	Recreation Potential
Check ONE (ONLY)	Check ONE (Or 2 & average)	Check ALL that apply	Primary Contact
<input type="checkbox"/> > 1m [6]	<input checked="" type="checkbox"/> POOL WIDTH > RIFFLE WIDTH [2]	<input type="checkbox"/> TORRENTIAL [-1]	Secondary Contact
<input type="checkbox"/> 0.7-<1m [4]	<input type="checkbox"/> POOL WIDTH = RIFFLE WIDTH [1]	<input checked="" type="checkbox"/> SLOW [1]	(circle one and comment on back)
<input checked="" type="checkbox"/> 0.4-<0.7m [2]	<input type="checkbox"/> POOL WIDTH < RIFFLE WIDTH [0]	<input type="checkbox"/> VERY FAST [1]	
<input type="checkbox"/> 0.2-<0.4m [1]		<input type="checkbox"/> FAST [1]	
<input type="checkbox"/> < 0.2m [0]		<input checked="" type="checkbox"/> MODERATE [1]	
		<input type="checkbox"/> INTERSTITIAL [-1]	
		<input type="checkbox"/> INTERMITTENT [-2]	
		<input type="checkbox"/> EDDIES [1]	

Comments

Pool / Current Maximum 12 **7**

Indicate for functional riffles; Best areas must be large enough to support a population of riffle-obligate species: Check ONE (Or 2 & average).

RIFFLE DEPTH	RUN DEPTH	RIFFLE / RUN SUBSTRATE	RIFFLE / RUN EMBEDDEDNESS
<input checked="" type="checkbox"/> BEST AREAS > 10cm [2]	<input type="checkbox"/> MAXIMUM > 50cm [2]	<input checked="" type="checkbox"/> STABLE (e.g., Cobble, Boulder) [2]	<input type="checkbox"/> NONE [2]
<input type="checkbox"/> BEST AREAS 5-10cm [1]	<input checked="" type="checkbox"/> MAXIMUM < 50cm [1]	<input type="checkbox"/> MOD. STABLE (e.g., Large Gravel) [1]	<input checked="" type="checkbox"/> LOW [1]
<input type="checkbox"/> BEST AREAS < 5cm [metric=0]		<input type="checkbox"/> UNSTABLE (e.g., Fine Gravel, Sand) [0]	<input type="checkbox"/> MODERATE [0]
			<input type="checkbox"/> EXTENSIVE [-1]

Comments

Riffle / Run Maximum 8 **6.5**

6) **GRADIENT** (83.3 ft/mi) VERY LOW - LOW [2-4] MODERATE [6-10] HIGH - VERY HIGH [10-6]

DRAINAGE AREA (3.66 mi²)

% POOL: % GLIDE:

% RUN: % RIFFLE:

Comments

Gradient Maximum 10 **4**

AJ SAMPLED REACH

Check ALL that apply

METHOD

- BOAT
- WADE
- L. LINE
- OTHER

STAGE

- 1st-sample pass--2nd
- HIGH
- UP
- NORMAL
- LOW
- DRY

DISTANCE

- 0.5 Km
- 0.2 Km
- 0.15 Km
- 0.12 Km
- OTHER

CLARITY

- 1st --sample pass-- 2nd
- < 20 cm
- 20-40 cm
- 40-70 cm
- > 70 cm/CITB
- SECCHI DEPTH

meters

CANOPY

- > 85%- OPEN
- 55%-85%
- 30%-55%
- 10%-30%
- <10%- CLOSED

CJ RECREATION

- AREA
- DEPTH
- POOL: >100ft² >3ft

BJAESTHETICS

- NUISANCE ALGAE
- INVASIVE MACROPHYTES
- EXCESS TURBIDITY
- DISCOLORATION
- FOAM/ SCUM
- OIL SHEEN
- TRASH/ LITTER
- NUISANCE ODOR
- SLUDGE DEPOSITS
- CSOs/ISSOs/OUTFALLS

DJ MAINTENANCE

- PUBLIC / PRIVATE / BOTH / NA
- ACTIVE / HISTORIC / BOTH / NA
- YOUNG-SUCCESSION-OLD
- SPRAY / SNAG / REMOVED
- MODIFIED / DIPPED OUT / NA
- LEVEED / ONE SIDED
- RELOCATED / CUTOFFS
- MOVING-BEDLOAD-STABLE
- ARMoured / SLUMPS
- ISLANDS / SCoured
- IMPOUNDED / DESICCATED
- FLOOD CONTROL / DRAINAGE

EJ ISSUES

- WWTP / CSO / NPDES / INDUSTRY
- HARDENED / URBAN / DIRT&GRIME
- CONTAMINATED / LANDFILL
- BMPs-CONSTRUCTION-SEDIMENT
- LOGGING / IRRIGATION / COOLING
- BANK / EROSION / SURFACE
- FALSE BANK / MANURE / LAGOON
- WASH H₂O / TILE / H₂O TABLE
- ACID / MINE / QUARRY? / FLOW
- NATURAL / WETLAND / STAGNANT
- PARK / GOLF / LAWN / HOME
- ATMOSPHERE / DATA PAUCITY

FJ MEASUREMENTS

- \bar{x} width
- \bar{x} depth
- max. depth
- \bar{x} bankfull width
- bankfull \bar{x} depth
- W/D ratio
- bankfull max. depth
- floodprone \bar{x} width
- entrench. ratio

Legacy Tree:

Stream Drawing:

