

E:SLAVIC VILLAGE DEVELOPMENT\13-00363-010 SEVEN ROSES PARKING LOT\DESIGN\PLANS\SLAVIC VILLAGE PARKING LOT - 3/29/2017 11:56:45 AM

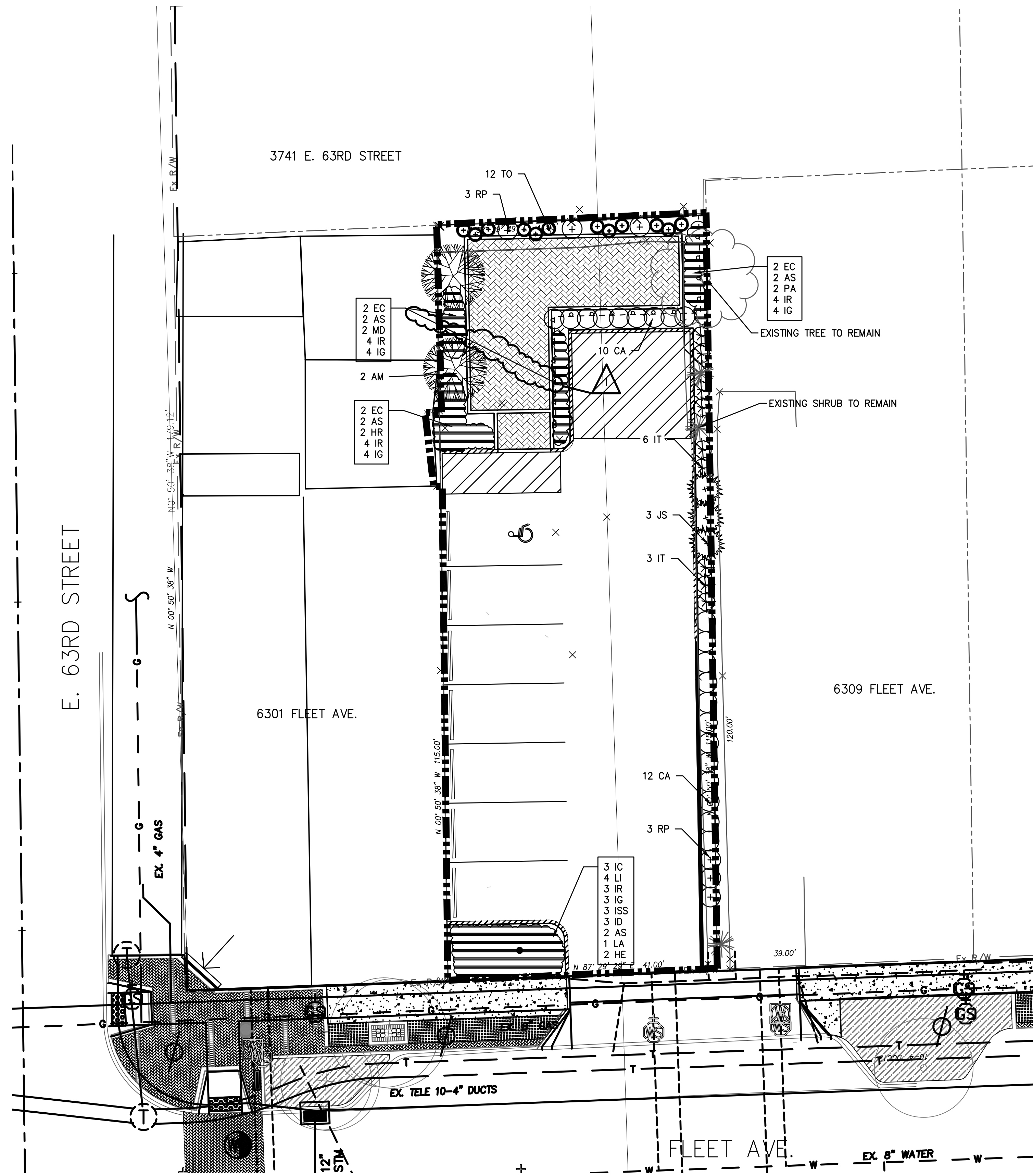

LANDSCAPE NOTES:

- CONTRACTOR TO VERIFY ALL UTILITY LOCATIONS IN THE FIELD PRIOR TO BEGINNING WORK. CONTRACTOR IS RESPONSIBLE FOR ANY DAMAGE TO UTILITIES ASSOCIATED WITH WORK. UTILITIES SHALL BE REPAIRED TO SATISFACTION OF THE UTILITY OWNER AND/OR OPERATING AUTHORITY AT NO ADDITIONAL COST.
- IN CASE OF DISCREPANCIES BETWEEN THE PLAN AND THE PLANT LIST, THE PLAN SHALL DICTATE. IF IN QUESTION, CONTACT THE LANDSCAPE ARCHITECT.
- FINAL PLACEMENT OF PLANT MATERIALS, ETC. SHALL BE APPROVED BY LANDSCAPE ARCHITECT BEFORE PLANTING OPERATIONS ARE TO PROCEED. ALL TREE LOCATIONS SHALL BE MARKED WITH A WOODEN STAKE INDICATING VARIETY AND SIZE OF TREE.
- NO SUBSTITUTIONS OF PLANT MATERIAL WILL BE ALLOWED. IF PLANTS ARE SHOWN TO BE UNAVAILABLE, THE CONTRACTOR SHALL NOTIFY LANDSCAPE ARCHITECT PRIOR TO BID DATE IN WRITING. ALL PLANTS SHALL BE INSPECTED AND TAGGED WITH PROJECT IDENTIFICATION AT NURSERY OR CONTRACTOR'S OPERATION PRIOR TO MOVING TO JOB SITE. PLANTS MAY ALSO BE INSPECTED AND APPROVED OR REJECTED ON THE JOB SITE.
- ALL PLANTS ARE TO MEET OR EXCEED AMERICAN STANDARDS FOR NURSERY STOCK, 2004 EDITION, AS SET FORTH BY AMERICAN ASSOCIATION OF NURSEYMEN.
- PLANTS AND ALL OTHER MATERIALS TO BE STORED ON SITE WILL BE PLACED WHERE THEY WILL NOT CONFLICT WITH CONSTRUCTION AND AS DIRECTED BY OWNER.
- ALL NEW LANDSCAPE PLANTINGS SHALL BE GUARANTEED FOR A PERIOD OF ONE YEAR FOLLOWING FINAL INSPECTION BY LANDSCAPE ARCHITECT. AT END OF THIS PERIOD, PLANT MATERIAL TERMED DEAD OR UNSATISFACTORY BY LANDSCAPE ARCHITECT SHALL BE REPLACED AT NO ADDITIONAL CHARGE BY THE LANDSCAPE CONTRACTOR.
- MAINTENANCE OF PLANT MATERIALS IS THE RESPONSIBILITY OF THE CONTRACTOR UNTIL PLANT MATERIALS ARE ACCEPTED BY OWNER. MAINTENANCE INCLUDES BUT IS NOT LIMITED TO WATERING, WEEDING, PEST CONTROL, AND OTHER ACTIONS AS REQUIRED TO MAINTAIN PLANT MATERIALS IN A HEALTHY CONDITION.

LEGEND

- CONSTRUCTION LIMITS
- EXISTING TREES

Plant List

Trees					
Qty.	Symbol	Scientific Name	Common Name	Size/Root	Condition
2	AM	Amelanchier x grandiflora 'Autumn Brilliance'	Serviceberry Autumn Brilliance	6' Ht.	B&B

Shrubs					
Qty.	Symbol	Scientific Name	Common Name	Size/Cond.	Condition
6	RP	Rosa 'Pink know out'	Knockout Rose	No. 3	Cont.
12	TO	Thuja occidentalis 'Aurea'	Golden Globe Arborvitae	No. 2	Cont.
3	JS	Juniperus chinensis 'Spartan'	Spartan Juniper	No. 3	Cont.
9	IT	Itea virginica 'Henry's Garnet'	Henry's Garnet Sweetspire	No. 3	Cont.

Perennials/Grasses					
Qty.	Symbol	Scientific Name	Common Name	Size/Cond.	Condition
22	CA	Calamagrostis acutiflora 'Karl Foerster'	Karl Foerster Reed Grass	No. 1	Cont.
2	PA	Panicum virgatum 'heavy metal'	Heavy Metal Switch Grass	No. 1	Cont.
6	EC	Echinacea purpurea	Purple Coneflower	No. 1	Cont.
3	IC	Iris 'Caesar's Brother'	Caesar's Brother Iris	No. 1	Cont.
15	IR	Iris versicolor	Blue Flag Iris	No. 1	Cont.
15	IG	Iris pseudacorus 'variegata'	Variegated water iris	No. 1	Cont.
8	AS	Aster novae-angliae 'Purple dome'	New England Aster Purple Dom	No. 1	Cont.
2	HE	Hemerocallis 'Happy Returns'	Happy Returns Daylily	No. 1	Cont.
4	LI	Liatis spicata	Blazing Star	No. 1	Cont.
2	MD	Monarda didyma 'Jacob Cline'	Red Bee-Balm	No. 1	Cont.
2	HR	Hemerocallis 'Rosy Returns'	Red repeat blooming daylily	No. 1	Cont.
3	ISS	Iris sibirica 'showdown'	Showdown iris	No. 1	Cont.
1	LA	Lavandula angustifolia 'Violet Intrigue'	English Lavender	No. 1	Cont.
3	ID	Iris cristata	Dwarf Crested Iris	Quart	Clump

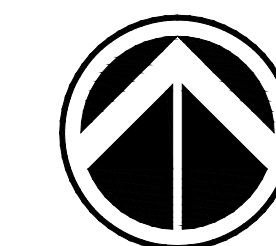

NORTH

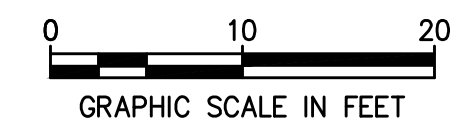

60% DESIGN/PERMIT REVIEW

NO.	REVISION DATA		DATE
	REVISIONS	NEORS	10/30/15
1			

6305 FLEET AVE. PARKING LOT
 SLAVIC VILLAGE DEVELOPMENT

PROJECT NO.: 13-00363-010
 DESIGNED BY: JT/AL
 DRAWN BY: JT/AL
 CHECKED BY: KGH
 DATE ISSUED: OCTOBER 5, 2015

LANDSCAPE PLAN

C 500