

FAIRHILL PARTNERS CAMPUS GREEN INFRASTRUCTURE IMPROVEMENTS

100% CONSTRUCTION DOCUMENTS

FEBRUARY 21, 2019

PROJECT ADDRESS
 FAIRHILL PARTNERS
 12200 FAIRHILL ROAD
 CLEVELAND, OH 44120

SHEET INDEX

- G000 TITLE SHEET
- G100 GENERAL NOTES
- G101 GENERAL NOTES
- G200 BID TABULATION

- C000 EXISTING CONDITIONS PLAN
- C100 DEMOLITION PLAN
- C200 SITE PLAN
- C201 SITE GRADING PLAN
- C202 SITE PHASING PLAN
- C500 SITE DETAILS
- C501 SITE DETAILS

- L200 PLANTING PLAN
- L201 BIORETENTION PLANTING PLAN
- L500 PLANTING DETAILS

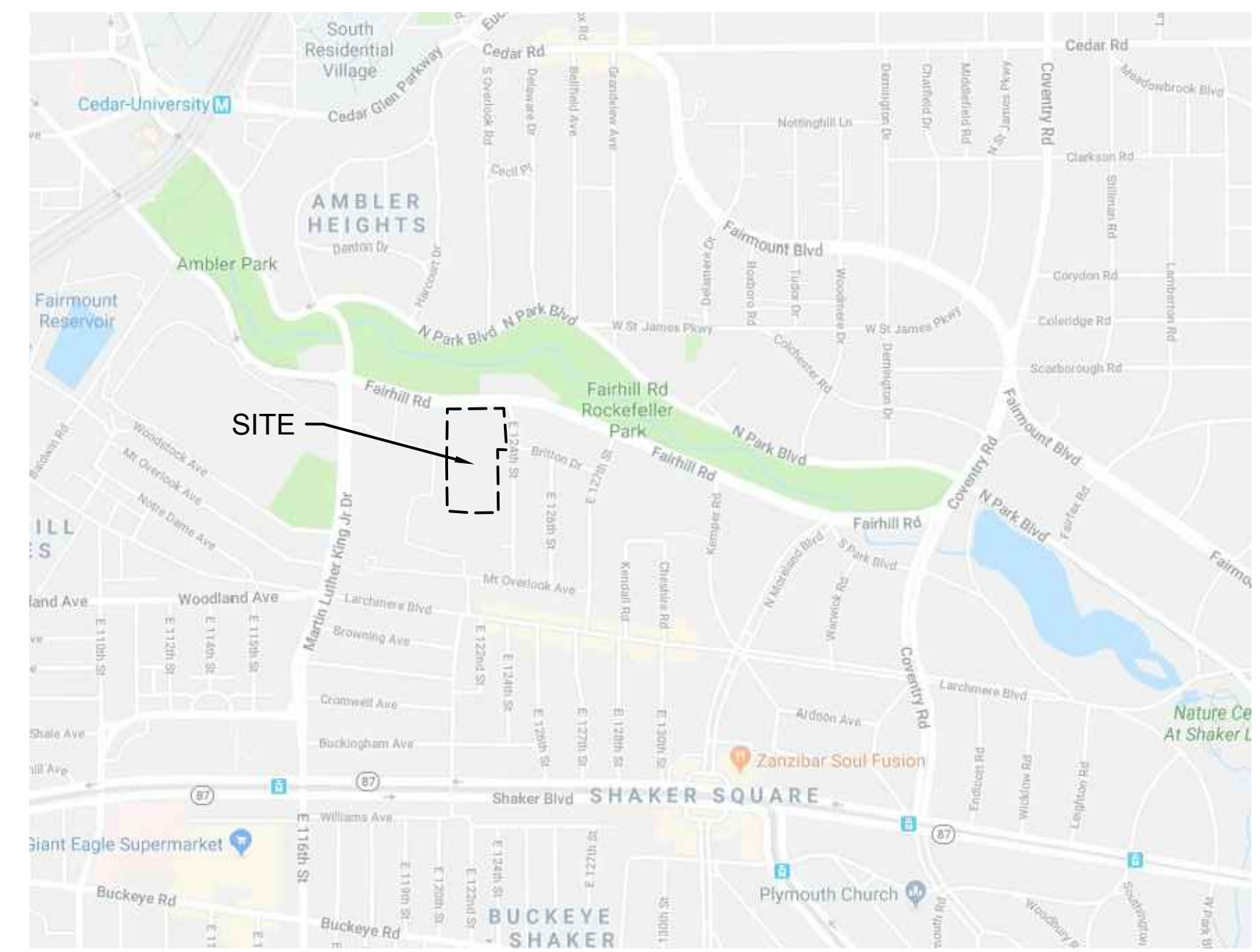

VICINITY MAP

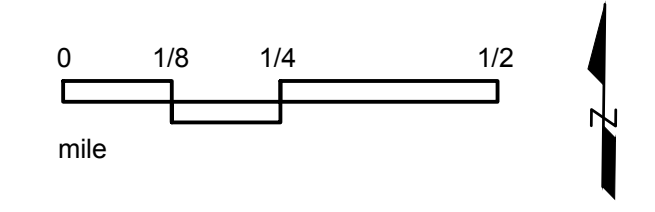

PROJECT
 FAIRHILL PARTNERS
 CAMPUS
 12200 FAIRHILL ROAD
 CLEVELAND, OH 44120



CLIENT
 FAIRHILL PARTNERS
 12200 FAIRHILL ROAD
 CLEVELAND, OH 44120

CONSULTANT
 AECOM
 1300 E. 9TH STREET, SUITE 500
 CLEVELAND, OH 44114
 216.622.2300 tel 216.622.2301 fax
 www.aecom.com

REGISTRATION

ISSUE/REVISION

NO.	DATE	DESCRIPTION
1	7/5/2018	60% REVIEW SET
2	7/17/2018	90% REVIEW SET
3	8/02/2018	100% REVIEW SET
4	8/13/2018	100% BID SET
5	2/21/2019	ISSUED FOR CONSTRUCTION
I/R	DATE	DESCRIPTION

PROJECT NUMBER
 60578006

SHEET TITLE
 TITLE SHEET

SHEET NUMBER
 G000

GENERAL NOTES AND PROJECT REQUIREMENTS

PROJECT DESCRIPTION:

THE PROJECT SITE IS LOCATED AT THE CORNER OF FAIRHILL ROAD AND E. 124TH STREET AND IS OWNED BY THE CLIENT FAIRHILL PARTNERS.

THE PROPOSED PROJECT INCLUDES REGRADING AND REPAVING OF A PORTION OF AN ASPHALT PARKING LOT, THE ADJUSTMENT OF SEVERAL CATCHBASINS AND MANHOLES, REGRADING AND RESEEDING THE EXISTING LAWN AREA TO CREATE A BIORETENTION BASIN, AND TREE PLANTINGS AROUND THE PARKING LOT.

SPECIFICATIONS:

THE STATE OF OHIO DEPARTMENT OF TRANSPORTATION, CONSTRUCTION AND MATERIAL SPECIFICATIONS 2016 EDITION, INCLUDING ALL SUPPLEMENTS THERETO, SHALL GOVERN ALL CONSTRUCTION ITEMS THAT ARE A PART OF THE PLAN UNLESS OTHERWISE NOTED.

DRAWING/SPECIFICATION DISCREPANCY

IN THE EVENT OF A DISCREPANCY BETWEEN DRAWINGS AND SPECIFICATIONS OR AMONG DRAWINGS, THE STRONGEST MATERIAL, LARGEST QUANTITY, OR BETTER QUALITY AS DETERMINED BY THE OWNER'S ARCHITECT SHALL GOVERN

BASIS FOR DESIGN:

IN THE PREPARATION OF WORKING DRAWINGS AND SPECIFICATIONS, THE ENGINEER HAS RELIED UPON THE SITE MAPPING SURVEY PROVIDED BY:

KS ASSOCIATES, INC.
CONTACT: MARK A. YEAGER, P.S.
260 BURNS ROAD, SUITE 100
ELYRIA, OH 44035
YEAGERM@KSASSOCIATES.COM
440.365.4730 X 300

A COPY OF THE SURVEY IS INCLUDED FOR REFERENCE.

CONTRACT COORDINATION & PHASING:

PERFORMANCE OF THIS CONTRACT WILL REQUIRE THE CONTRACTOR TO COORDINATE ALL ACTIVITY WITH THE PROJECT OWNER, FAIRHILL PARTNERS.

CONTRACTOR ACKNOWLEDGEMENT

BY SUBMITTING A BID, THE CONTRACTOR ACKNOWLEDGES THAT HE/SHE HAS SATISFIED HIMSELF/HERSELF AS TO THE NATURE AND LOCATION OF THE WORK, THE GENERAL AND LOCAL CONDITIONS, PARTICULARLY THOSE BEARING UPON THE HANDLING OF MATERIALS, AVAILABILITY OF LABOR AND NECESSARY UTILITIES, THE UNCERTAINTIES OF WEATHER, GROUNDWATER TABLE OR SIMILAR CONDITIONS AT THE SITE, THE CONFORMATION AND CONDITIONS OF THE SOILS AND GROUND SURFACE, THE CHARACTER OF EQUIPMENT AND FACILITIES NEEDED PRIOR TO AND DURING THE EXECUTION OF THE WORK, AND ALL OTHER MATTERS WHICH CAN IN ANY WAY AFFECT THE WORK OR COST THEREOF UNDER THIS CONTRACT. ANY FAILURE OF THE CONTRACTOR TO ACQUAINT HIMSELF/HERSELF WITH THE AVAILABLE INFORMATION CONCERNING THE CONDITIONS WILL NOT RELIEVE HIM/HER FROM RESPONSIBILITY FOR ESTIMATING PROPERLY THE DIFFICULTY AND COST OF SUCCESSFULLY PERFORMING THE WORK.

INDEMNIFICATION

THE CONTRACTOR WILL INDEMNIFY AND HOLD HARMLESS THE OWNER, THE ENGINEER, AND THEIR AGENTS AND EMPLOYEES FROM AND AGAINST ALL CLAIMS, DAMAGES, LOSSES, AND EXPENSES INCLUDING ATTORNEY'S FEES ARISING OUT OF OR RESULTING FROM PERFORMANCE OF THE WORK, PROVIDED THAT ANY SUCH CLAIMS, DAMAGES, LOSS, OR EXPENSE IS ATTRIBUTABLE TO BODILY INJURY, SICKNESS, DISEASE OR DEATH, OR INJURY TO OR DESTRUCTION OF TANGIBLE PROPERTY, INCLUDING THE LOSS OF USE RESULTING THEREFROM; AND IS CAUSED IN WHOLE OR PART BY ANY NEGLIGENT OR WILLFUL ACT OR OMISSION OF THE CONTRACTOR, AND SUBCONTRACTOR, ANYONE DIRECTLY OR INDIRECTLY EMPLOYED BY ANY OF THEM MAY BE LIABLE.

IN ANY AND ALL CLAIMS AGAINST THE OWNER, THE ENGINEER, OR ANY OF THEIR AGENTS OR EMPLOYEES, BY ANY EMPLOYEE OF THE CONTRACTOR, ANY SUBCONTRACTOR, ANYONE FOR WHO ACTS ANY OF THEM MAY BE LIABLE, THE INDEMNIFICATION OBLIGATION SHALL NOT BE LIMITED IN ANY WAY BY ANY LIMITATION ON THE AMOUNT OR TYPE OF DAMAGES, COMPENSATION, OR BENEFITS PAYABLE BY OR FOR THE CONTRACTOR OR ANY SUBCONTRACTOR UNDER WORKERS COMPENSATION ACTS, DISABILITY BENEFIT ACTS, OR OTHER EMPLOYEE BENEFITS ACTS.

THE OBLIGATIONS OF THE CONTRACTOR UNDER THIS PARAGRAPH SHALL NOT EXTEND TO THE LIABILITY OF THE ENGINEER, HIS/HER AGENTS OF EMPLOYEES ARISING OUT OF THE PREPARATION OR APPROVAL OF MAPS, PLANS, OPINIONS, REPORTS, SURVEYS, CHANGE ORDERS, DESIGNS, OR SPECIFICATIONS.

REVIEW OF PROJECT SITE

PRIOR TO BIDDING, THE CONTRACTOR SHALL, BY PERSONAL EXAMINATION, SATISFY HIMSELF/HERSELF AS TO THE LOCATION OF THE PROPOSED WORK AND TO ACQUAINT HIMSELF/HERSELF THOROUGHLY WITH THE EXISTING CONDITIONS AND THE DIFFICULTIES THAT ARE LIKELY TO BE ENCOUNTERED IN THE PERFORMANCE OF THE PROPOSED WORK.

INCLUSIVE BID

CONTRACTOR'S BID SHALL INCLUDE ALL LABOR, MATERIALS, PERMITS, AND EQUIPMENT REQUIRED TO COMPLETE THE PROJECT. COMPENSATION FOR ANY OTHER WORK, WHICH DOES NOT HAVE A SPECIFIC PAY ITEM, WILL BE INCLUDED IN THE PRICE OF THE INDIVIDUAL ITEMS IN THE BID. CONTRACTORS ARE ENCOURAGED TO PROVIDE NOTES AS TO WHERE ADDITIONAL COSTS ARE INCLUDED IN A LINE ITEM.

OSHA

COMPLIANCE WITH THE OCCUPATIONAL SAFETY AND HEALTH ACT OF 1970 IS REQUIRED OF THE CONTRACTOR AND SUBCONTRACTORS ON THE PROJECT.

SAFETY COORDINATION

CONTRACTOR WILL PROVIDE A SAFETY PLAN FOR SECURING THE WORK AND WORK SITE FOR REVIEW BY OWNER PRIOR TO COMMENCING WORK.

CONSTRUCTION SURVEY AND STAKING

THE CONTRACTOR SHALL BE RESPONSIBLE FOR PERFORMING ALL DETAIL SURVEYS NEEDED FOR CONSTRUCTION.

CONTRACTOR TO PROVIDE ALL EQUIPMENT AND LABOR TO PERFORM HORIZONTAL CONTROL OF THE WORK DURING CONSTRUCTION. STAKING SHALL BE COMPLETED BY AN OHIO LICENSED SURVEYOR. INSTALL STAKING TO SET UP PROJECT REFERENCE STATIONING AND COORDINATES AS PER PLAN. INSTALL STAKING DEFINING WORK AREAS AS DESIGNATED ON PLAN. WORK AREA STAKING TO BE COLOR CODED OR LABELED FOR THE TYPE OF WORK SPECIFIED.

THE CONTRACTOR SHALL VERIFY ALL DIMENSIONS AND ALL GRADES, LINES AND LEVELS AS INDICATED ON THE DRAWINGS AND SPECIFICATIONS, AND HE/SHE SHALL REPORT ANY ERRORS OR INCONSISTENCIES IN THE ABOVE TO ENGINEER BEFORE COMMENCING WORK OR ORDERING ANY MATERIAL.

THE CONTRACTOR SHALL BE RESPONSIBLE FOR THE PRESERVATION OF ALL STAKES AND MARKS AND SHALL REPLACE THEM AT HIS EXPENSE IF THEY ARE DAMAGED, LOST, DISPLACED OR REMOVED. THE CONTRACTOR SHALL USE COMPETENT PERSONNEL AND SUITABLE EQUIPMENT FOR THE LAYOUT WORK REQUIRED AND SHALL PROVIDE THAT IT IS DONE UNDER THE SUPERVISION OF A REGISTERED SURVEYOR.

ALL STAKING FOR LAYOUT IS TO BE APPROVED BY OWNERS REP PRIOR TO CONSTRUCTION.

IRON PINS AND MONUMENTS

THE CONTRACTOR SHALL REFERENCE ALL IRON PINS AND MONUMENTS BEFORE EXCAVATING AT OR NEAR THEM. IF ANY IRON PINS OR MONUMENTS ARE DESTROYED OR DAMAGED DURING CONSTRUCTION, NOTIFY THE OWNER IN WRITING. DAMAGED PINS OR MONUMENTS SHALL BE ACCURATELY REPLACED BY A REGISTERED SURVEYOR AT THE COMPLETION OF THE PROJECT.

UTILITIES

THE CONTRACTOR IS REQUIRED TO VERIFY LOCATIONS OF ALL PUBLIC AND PRIVATE UTILITIES PRIOR TO CONSTRUCTION. IT IS THE RESPONSIBILITY OF THE CONTRACTOR TO NOTIFY THE OWNER IMMEDIATELY IF THERE IS THE POTENTIAL FOR IMPACT TO AN EXISTING UTILITY. ANY ADJUSTMENTS TO EXISTING UTILITIES MUST BE APPROVED BY THE OWNER PRIOR TO ANY MODIFICATION. LISTED BELOW ARE THE KNOWN PUBLIC UTILITIES WITHIN THE PROJECT AREA AND THEIR RESPECTIVE OWNERS.

1. ELECTRIC – CLEVELAND PUBLIC POWER
2. WATER – CLEVELAND WATER DEPARTMENT
3. SEWER – NORTHEAST OHIO REGIONAL SEWER DISTRICT

LIMITS OF DISTURBANCE

THE LIMITS OF DISTURBANCE SHOWN ON THESE PLANS APPLY TO ALL ASPECTS OF CONSTRUCTION. THE CONTRACTOR (INCLUDING ALL WORKERS, MATERIALS, AND SUBCONTRACTORS) SHALL REMAIN WITHIN THE LIMITS OF DISTURBANCE THROUGHOUT THE PROJECT. NO CONSTRUCTION ACTIVITY SHALL OCCUR OUTSIDE THE LIMITS OF DISTURBANCE WITHOUT RECEIVING PRIOR WRITTEN APPROVAL FROM THE CLIENT OR CONSTRUCTION MANAGER.

DISTURBANCE TO EXISTING FEATURES:

CONSTRUCTION MUST NOT DAMAGE SITE FEATURES WITHIN OR BEYOND THE PROJECT AREA THAT ARE SLATED TO REMAIN. IF DAMAGE OCCURS TO ANY OF THE EXISTING FEATURES THAT ARE TO REMAIN, IT WILL BE SOLELY THE RESPONSIBILITY OF THE CONTRACTOR TO RESTORE THOSE DAMAGED ELEMENTS TO THEIR PRE-CONSTRUCTION CONDITION. A WRITTEN REQUEST SHALL BE MADE TO THE OWNER IF EXISTING SITE FEATURES ARE TO BE DISTURBED (NOT EXPLICITLY CALLED OUT ON THE DEMOLITION PLAN). THE CONTRACTOR MUST HAVE WRITTEN APPROVAL FROM THE OWNER PRIOR TO PROCEEDING.

PROTECTION OF EXISTING TREES AND VEGETATION:

1. CARE SHOULD BE TAKEN TO ONLY REMOVE THE TREES AND OTHER PLANT MATERIAL IDENTIFIED ON THE PLANS. TREES IDENTIFIED FOR REMOVAL SHALL BE FLAGGED AND APPROVED BY OWNER PRIOR TO COMMENCEMENT OF WORK. IF THE CONTRACTOR DEEMS IT NECESSARY TO REMOVE ADDITIONAL MATERIAL BEYOND WHAT IS CALLED FOR IN THE PLANS, HE/SHE SHALL HAVE WRITTEN APPROVAL FROM THE OWNER.
2. ALL TREES LOCATED OUTSIDE THE LIMITS OF DISTURBANCE SHALL BE PRESERVED. THE CONTRACTOR IS RESPONSIBLE FOR PROTECTING ALL TREES TO BE PRESERVED FROM HIS/HER ACTIVITIES. THIS SHALL INCLUDE THE PROTECTION OF TREE ROOTS FROM VEHICULAR AND PEDESTRIAN TRAFFIC AND MATERIAL STOCKPILING.
3. ALL TREES SHOWN TO BE RETAINED WITHIN THE LIMITS OF CONSTRUCTION ON THE PLANS, SHALL BE PROTECTED DURING CONSTRUCTION WITH FENCING. SEE: TREE PROTECTION DETAILS.
4. TREE PROTECTION FENCES SHALL BE INSTALLED PRIOR TO THE COMMENCEMENT OF ANY SITE PREPARATION WORK (CLEARING, GRUBBING, OR GRADING) AND SHALL BE MAINTAINED THROUGHOUT ALL PHASES OF THE CONSTRUCTION PROJECT. CONTRACTOR IS RESPONSIBLE FOR REMOVAL ONLY AFTER THE PROJECT IS DEEMED TO BE SUBSTANTIALLY COMPLETE. CONTRACTOR IS RESPONSIBLE FOR PROTECTING ALL REMAINING TREES ON SITE FROM CONSTRUCTION STRESS AND DAMAGE UNTIL THE PROJECT IS FULLY COMPLETE.
5. EROSION AND SEDIMENTATION CONTROL BARRIERS SHALL BE INSTALLED AND MAINTAINED IN A MANNER WHICH DOES NOT RESULT IN SEDIMENT BUILD-UP WITHIN TREE DRILINES.
6. FENCES SHALL COMPLETELY SURROUND THE TREE OR CLUSTERS OF TREES, LOCATED AT THE OUTERMOST LIMITS OF THE TREE BRANCHES (DRILINE) OR CRITICAL ROOT ZONE (CRZ), WHICHEVER IS GREATER; AND SHALL BE MAINTAINED THROUGHOUT THE CONSTRUCTION PROJECT IN ORDER TO PREVENT THE FOLLOWING: SOIL COMPACTION IN CRZ AREA RESULTING FROM VEHICULAR TRAFFIC OR STORAGE OF EQUIPMENT OR MATERIAL. CRZ DISTURBANCES DUE TO GRADE CHANGES OR TRENCHING, OR WOUNDS TO EXPOSED ROOTS, TRUNK, OR LIMBS BY MECHANICAL EQUIPMENT.
7. ALL GRADING WITHIN CRZ AREAS SHALL BE DONE BY HAND OR WITH SMALL EQUIPMENT TO MINIMIZE ROOT DAMAGE. PRIOR TO GRADING, RELOCATE PROTECTIVE FENCING (IF REQUIRED) TO 2 FEET BEHIND THE GRADE CHANGE AREA.
8. ANY ROOTS EXPOSED BY CONSTRUCTION ACTIVITY SHALL BE PRUNED FLUSH WITH THE SOIL AND BACKFILLED WITH GOOD QUALITY TOP SOIL WITHIN TWO DAYS. IF EXPOSED ROOT AREAS CANNOT BE BACKFILLED WITHIN 2 DAYS, 4" OF MULCH OR OTHER ORGANIC MATERIAL WHICH REDUCES SOIL TEMPERATURE AND MINIMIZES WATER LOSS DUE TO EVAPORATION SHALL BE PLACED TO COVER THE ROOTS UNTIL BACKFILL CAN OCCUR.
9. NO LANDSCAPE TOPSOIL DRESSING GREATER THAN FOUR (4) INCHES SHALL BE PERMITTED WITHIN THE DRILINE OR CRZ OF TREES, WHICHEVER IS GREATER. NO TOPSOIL IS PERMITTED ON ROOT FLARES OF ANY TREE.
10. PRUNING TO PROVIDE CLEARANCE FOR STRUCTURES, VEHICULAR TRAFFIC, AND CONSTRUCTION EQUIPMENT SHALL TAKE PLACE BEFORE CONSTRUCTION BEGINS. ALL PRUNING MUST BE PERFORMED IN ACCORDANCE WITH THE INTERNATIONAL SOCIETY OF ARBORICULTURE (ISA) PRUNING TECHNIQUES AND UNDER THE SUPERVISION OF AN ISA CERTIFIED ARBORIST.

CONSTRUCTION NOISE

ACTIVITIES AND LAND USE ADJACENT TO THE PROJECT SITE MAY BE AFFECTED BY CONSTRUCTION NOISE. IN ORDER TO MINIMIZE ANY ADVERSE CONSTRUCTION NOISE IMPACTS, LIMIT THE USE OF POWER-OPERATED, CONSTRUCTION-TYPE DEVICES BETWEEN THE HOURS OF 7AM AND 5PM MONDAY THRU FRIDAY OR AS SPECIFIED BY LOCAL CODIFIED ORDINANCE REQUIREMENT. IN ADDITION, DO NOT OPERATE AT ANY TIME ANY DEVICE IN SUCH A MANNER THAT THE NOISE CREATED SUBSTANTIALLY EXCEEDS THE NOISE CUSTOMARILY AND NECESSARILY ATTENDANT TO THE REASONABLE AND EFFICIENT PERFORMANCE OF SUCH EQUIPMENT.

WORKING HOURS

WORKING HOURS SHOULD BE IN ACCORDANCE WITH THOSE SPECIFIED LOCAL CODIFIED ORDINANCES. IF NO WORK HOURS ARE INDICATED THE ALLOWABLE WORK HOURS WILL BE BETWEEN 7AM AND 5PM, MONDAY THRU FRIDAY. NO WORK SHALL BE PERFORMED ON SATURDAY OR SUNDAY WITHOUT PRIOR WRITTEN APPROVAL FROM OWNER. IF THE CONTRACTOR NEEDS TO WORK ON A WEEKEND OR A HOLIDAY, HE/SHE SHALL SUBMIT HIS/HER REQUEST STATING THE REASONS FOR WORKING THOSE DAYS TO THE OWNER.

ACCESS ROAD MAINTENANCE

THE CONTRACTOR IS REQUIRED TO MAINTAIN ALL ACCESS ROADWAYS LEADING TO AND FROM THE CONSTRUCTION SITE. IT IS REQUIRED THAT THE CONTRACTOR ENSURE THAT THE ROADWAYS ARE KEPT FREE OF MUD, DUST, AND DEBRIS, THROUGHOUT CONSTRUCTION. AS NECESSARY, THE CONTRACTOR SHALL SWEEP THE ROADWAY TO REMOVE MUD, DIRT, AND DEBRIS. IT WILL BE THE RESPONSIBILITY OF THE CONTRACTOR TO REPAIR ANY ROADWAY DAMAGE BEYOND THE TYPICAL WEAR AND TEAR AT THE

COMPLETION OF CONSTRUCTION. IF IT IS THE CASE THAT SIGNIFICANT ROADWAY DAMAGE OCCURS TO THE DEGREE WHERE NORMAL TRAFFIC FLOW IS IMPACTED, IMMEDIATE REPAIRS TO RESTORE TRAFFIC FLOW SHALL BE PERFORMED. ALL REPAIRS TO THE ROADWAY SHALL BE PROPERLY PERMITTED AND AGREED TO BY THE OWNER.

CONSTRUCTION STOCKPILING AND STAGING AREA

THE CONSTRUCTION STOCKPILING AND STAGING SHOULD BE LOCATED AS SHOWN ON THE PLANS UNLESS AN ALTERNATE LOCATION IS AGREED TO IN WRITING WITH THE OWNER.

MODIFICATIONS

ANY MODIFICATIONS OR CHANGES TO THE WORK TO WHAT IS INDICATED ON THE DRAWINGS, MUST HAVE PRIOR WRITTEN APPROVAL BY THE OWNER.

NON-RUBBER TIRE VEHICLES

NO NON-RUBBER TIRE VEHICLES SHALL BE USED ON PAVED PARKING LOT OR DRIVES ADJACENT TO THE PROJECT AREA. EXCEPTIONS MAY BE GRANTED BY THE OWNER WHERE SHORT DISTANCES AND SPECIAL CIRCUMSTANCES ARE INVOLVED. GRANTING OF EXCEPTIONS MUST BE IN WRITING AND ANY RESULTING DAMAGE MUST BE REPAIRED TO THE SATISFACTION OF OWNER OF THE FACILITY. THE CONTRACTOR SHALL USE EXTREME CARE WHEN OPERATING NON-RUBBER TIRE VEHICLES ON STREETS, DRIVEWAYS, OR SIDEWALKS TO AVOID MARKING OR DAMAGING THE PAVEMENTS. PROTECTION OF THE PAVEMENT FROM DAMAGE RESULTING FROM THE TRACKS OF NON-RUBBER TIRE VEHICLES UTILIZED IN CONSTRUCTION ACTIVITY SHALL BE REQUIRED. METAL PLATES, RUBBER MATS, OR OTHER MEANS AS APPROVED BY THE RESPECTIVE OWNERS SHALL BE USED TO PROTECT THE PAVEMENT. THE COST OF THIS WORK SHALL BE INCLUDED IN THE UNIT PRICE BID FOR THE VARIOUS ITEMS OF THE CONTRACT.

PERMITS AND REGULATIONS

THE CONTRACTOR IS RESPONSIBLE FOR OBTAINING ALL LOCAL PERMITS PRIOR TO COMMENCING CONSTRUCTION. ALL WORK MUST COMPLY WITH APPLICABLE FEDERAL, STATE, AND LOCAL REGULATIONS IN ALL RESPECTS, INCLUDING COMPLIANCE WITH THE OCCUPATIONAL SAFETY AND HEALTH ADMINISTRATION REGULATIONS.

PRIVATE PROPERTY ACCESS

THERE SHALL BE NO ACCESS TO ADJACENT PUBLIC OR PRIVATE PROPERTIES UNLESS THERE IS A WRITTEN APPROVAL BY THE OWNER AND PROPERTY OWNER.

PROPERTY RESTORATION

THE CONTRACTOR IS RESPONSIBLE FOR THE PROTECTION AND RESTORATION OF ALL PRIVATE AND PUBLIC PROPERTY IMPACTED BY THE CONTRACTOR'S OPERATIONS TO A CONDITION AS GOOD OR BETTER THEN IT WAS INITIALLY FOUND. THE ACCEPTANCE OF THIS WORK WILL BE APPROVED BY THE PROPERTY OWNER.

WORK LIMITS

THE CONTRACTOR SHALL CONFINE ALL HIS/HER ACTIVITIES TO THE PROJECT SITES UNDER DEVELOPMENT OR THE EXISTING RIGHT-OF-WAYS, CONSTRUCTION, AND/OR PERMANENT EASEMENTS. THE CONTRACTOR SHALL NOT TRESPASS UPON OTHER PRIVATE PROPERTY WITHOUT THE WRITTEN CONSENT OF THE OWNER.

SAFETY

THE CONTRACTOR SHALL SOLELY BE RESPONSIBLE FOR COMPLYING WITH ALL FEDERAL, STATE, AND LOCAL SAFETY REQUIREMENTS, TOGETHER WITH EXERCISING PRECAUTIONS AT ALL TIMES FOR THE PROTECTION OF PERSONS INCLUDING EMPLOYEES AND PROPERTY. IT IS ALSO THE CONTRACTOR'S RESPONSIBILITY TO INITIATE, MAINTAIN, AND SUPERVISE ALL SAFETY REQUIREMENTS, PRECAUTIONS, AND PROGRAMS IN CONNECTION WITH THE WORK.

THE CONTRACTOR SHALL BE SOLELY RESPONSIBLE FOR SECURING THE PROJECT SITE FROM THE GENERAL PUBLIC BOTH DURING AND AFTER HIS/HER WORKING HOURS. THE CONTRACTOR SHALL PROVIDE, ERECT, AND MAINTAIN ALL LIGHTS, SIGNS, FENCES, OR ANY OTHER SAFETY DEVICE TO PREVENT UNAUTHORIZED PERSONNEL FROM HAZARDOUS OR DANGEROUS CONDITIONS ON THE PROJECT SITE. THE COST OF SUCH WORK SHALL BE INCLUDED IN THE VARIOUS ITEMS BID FOR FURNISHING AND INSTALLING MATERIALS ON THIS PROJECT.

ALL WORK NEAR EXISTING POWERLINES SHALL BE PERFORMED IN CONFORMANCE WITH THE REQUIREMENTS OF THE FOLLOWING STATUTES, REGULATIONS AND SAFETY CODES AND GUIDELINES:

- NATIONAL ELECTRICAL SAFETY CODE
- OSHA REGULATIONS GOVERNING WORKING CLEARANCES FROM ENERGIZED LINES. OSHA STANDARD 29 CFR 1926.550 SUBPART N IS SPECIFIC TO CRANES, DERRICKS, HOISTS. ALL VEHICLES, EQUIPMENT, AND LOADS SHALL MAINTAIN THE MINIMUM CLEARANCES FROM ENERGIZED WIRES SPECIFIED IN THIS STANDARD.

SOIL EROSION AND SEDIMENT CONTROL

THE TOTAL DISTURBED AREA OF THE PROJECT IS 42,500 SF WHICH IS LESS THAN THE ONE ACRE MINIMUM THRESHOLD REQUIREMENT FOR A SWPPP. THEREFORE NO SWPPP IS REQUIRED.

CONSTRUCTION SCHEDULE

UPON AWARD OF CONTRACT, THE CONTRACTOR SHALL DEVELOP A DETAILED SCHEDULE FOR THE WORK TO IDENTIFY THE START AND END DATES FOR EACH TASK. WORK CANNOT COMMENCE UNTIL THE OWNER HAS GIVEN WRITTEN APPROVAL OF THE SCHEDULE.

PRE-CONSTRUCTION MEETING

A PRE-CONSTRUCTION MEETING WITH THE CONTRACTOR AND OWNER'S REPRESENTATIVES WILL OCCUR PRIOR TO CONSTRUCTION ACTIVITY TO WALK THE SITE AND REVIEW THE DRAWINGS.

AECOM

PROJECT

FAIRHILL PARTNERS CAMPUS

12200 FAIRHILL ROAD
CLEVELAND, OH 44120

Fairhill
partners



CLIENT

FAIRHILL PARTNERS

12200 FAIRHILL ROAD
CLEVELAND, OH 44120

CONSULTANT

AECOM
1300 E. 9TH STREET, SUITE 500
CLEVELAND, OH 44114
216.622.2300 tel 216.622.2301 fax
www.aecom.com

REGISTRATION

ISSUE/REVISION

1	7/5/2018	60% REVIEW SET
2	7/17/2018	90% REVIEW SET
3	8/02/2018	100% REVIEW SET
4	8/13/2018	100% BID SET
5	2/21/2019	ISSUED FOR CONSTRUCTION
U/R	DATE	DESCRIPTION

PROJECT NUMBER

60578006

SHEET TITLE

GENERAL NOTES

SHEET NUMBER

G100

ITEM 624. MOBILIZATION:

CONTRACTOR SHALL FURNISH ALL EQUIPMENT, LABOR, AND MATERIALS NECESSARY TO PERFORM MOBILIZATION AS PER PLAN AND AS PER ODOT CMS ITEM 624. THIS ITEM INCLUDES EQUIPMENT MOBILIZATION, DEMOBILIZATION, AND PROJECT PHASING BARRIERS AND SIGNAGE.

PAYMENT FOR THE ABOVE WILL BE MADE AT THE CONTRACT UNIT PRICE FOR ITEM 624, MOBILIZATION.

ITEM SPECIAL. TEMPORARY CONSTRUCTION SIGN:

CONTRACTOR SHALL FURNISH ALL EQUIPMENT, LABOR, AND MATERIALS NECESSARY TO PERFORM TEMPORARY CONSTRUCTION SIGN AS PER PLAN. THIS ITEM INCLUDES SIGN, SIGN POSTS, SIGN GRAPHICS, INSTALLATION AND REMOVAL.

PAYMENT FOR THE ABOVE WILL BE MADE AT THE CONTRACT UNIT PRICE FOR ITEM SPECIAL, TEMPORARY CONSTRUCTION SIGN.

ITEM 253. PAVEMENT DEMOLITION. AREA 'A':

CONTRACTOR SHALL FURNISH ALL EQUIPMENT, LABOR, AND MATERIALS NECESSARY TO PERFORM PAVEMENT DEMOLITION AS PER ODOT CMS 253 AND AS PER PLAN. THIS ITEM INCLUDES REMOVAL OF PAVEMENT, BASE COURSE, AND HAUL AWAY.

PAYMENT FOR THE ABOVE WILL BE MADE AT THE CONTRACT UNIT PRICE FOR ITEM 253, PAVEMENT DEMOLITION, AREA 'A'.

ITEM 203. EXCAVATION. AREA 'A':

CONTRACTOR SHALL FURNISH ALL EQUIPMENT, LABOR, AND MATERIALS NECESSARY TO PERFORM EXCAVATION AS PER ODOT CMS ITEM 203, AND AS PER PLAN. THIS ITEM INCLUDES EXCAVATION, ANY REQUIRED EMBANKMENT, ANY REQUIRED BACKFILL, AND REMOVAL OF EXCESS SOIL FROM THE SITE.

PAYMENT FOR THE ABOVE WILL BE MADE AT THE CONTRACT UNIT PRICE FOR ITEM 203, EXCAVATION 'A'.

ITEM 611. MANHOLE, CATCH BASIN, OR INLET, ADJUSTED TO GRADE:

CONTRACTOR SHALL FURNISH ALL EQUIPMENT, LABOR, AND MATERIALS NECESSARY TO PERFORM MANHOLE, CATCH BASIN, OR INLET, ADJUSTED TO GRADE AS PER ODOT CMS ITEM 611 AND AS PER PLAN. THIS ITEM INCLUDES REMOVAL, NEW CASTINGS, AND RECONSTRUCTION TO GRADE.

PAYMENT FOR THE ABOVE WILL BE MADE AT THE CONTRACT UNIT PRICE FOR ITEM 611 MANHOLE, CATCH BASIN, OR INLET, ADJUSTED TO GRADE.

~~**ITEM 608. CONCRETE CURB, FLUSH:** NOT IN CONTRACT~~

~~CONTRACTOR SHALL FURNISH ALL EQUIPMENT, LABOR, AND MATERIALS NECESSARY TO PERFORM CONCRETE CURB, FLUSH AS PER ODOT CMS 608 AND AS PER PLAN.~~

~~PAYMENT FOR THE ABOVE WILL BE MADE AT THE CONTRACT UNIT PRICE FOR ITEM 608, CONCRETE CURB, FLUSH.~~

ITEM 640. PAVEMENT STRIPING:

CONTRACTOR SHALL FURNISH ALL EQUIPMENT, LABOR, AND MATERIALS NECESSARY TO PERFORM PAVEMENT STRIPING AS PER ODOT CMS 640 AND AS PER PLAN. THIS ITEM INCLUDES RESTRIPIING THE PARADE GROUND PARKING LOTS, BOTH EXISTING AND NEW PAVEMENTS.

PAYMENT FOR THE ABOVE WILL BE MADE AT THE CONTRACT UNIT PRICE FOR ITEM 640, PAVEMENT STRIPING.

ITEM 605. UNDERDRAIN

CONTRACTOR SHALL FURNISH ALL EQUIPMENT, LABOR, AND MATERIALS NECESSARY TO INSTALL THE UNDERDRAIN AS PER PLAN. THIS ITEM INCLUDES THE 4 INCH PVC UNDERDRAIN, CLEANOUT, MONITORING WELL, UNDERDRAIN OUTLET, CONNECTION TO THE CATCH BASIN, AS WELL AS REQUIRED FITTINGS AND APPURTENANCES.

PAYMENT FOR THE ABOVE WILL MADE AT THE CONTRACT UNIT PRICE FOR ITEM 605, UNDERDRAIN.

ITEM SPECIAL. BIORETENTION SOIL. AREA 'A':

CONTRACTOR SHALL FURNISH ALL EQUIPMENT, LABOR, AND MATERIALS NECESSARY TO PERFORM BIORETENTION SOIL AS PER PLAN. THIS ITEM INCLUDES FURNISHING AND INSTALLING BIORETENTION SOIL.

PAYMENT FOR THE ABOVE WILL BE MADE AT THE CONTRACT UNIT PRICE FOR ITEM SPECIAL, BIORETENTION SOIL.

ITEM SPECIAL. BIORETENTION STONE. AREA 'A':

CONTRACTOR SHALL FURNISH ALL EQUIPMENT, LABOR, AND MATERIALS NECESSARY TO PERFORM BIORETENTION STONE AS PER PLAN. THIS ITEM INCLUDES FURNISHING AND INSTALLING THE BIORETENTION FILTER LAYER AND GRAVEL JACKET AS PER PLAN.

PAYMENT FOR THE ABOVE WILL BE MADE AT THE CONTRACT UNIT PRICE FOR ITEM SPECIAL, BIORETENTION STONE.

ITEM SPECIAL. PARKING BLOCK:

CONTRACTOR SHALL FURNISH ALL EQUIPMENT, LABOR, AND MATERIALS NECESSARY TO INSTALL PARKING BLOCKS AS PER PLAN.

PAYMENT FOR THE ABOVE WILL BE MADE AT THE CONTRACT UNIT PRICE FOR ITEM SPECIAL, PARKING BLOCK.

~~**ITEM SPECIAL. INTERPRETIVE SIGN:** NOT IN CONTRACT~~

~~CONTRACTOR SHALL FURNISH ALL EQUIPMENT, LABOR, AND MATERIALS NECESSARY TO INSTALL THE INTERPRETIVE SIGN AS PER PLAN. THIS ITEM INCLUDES ALL ASSEMBLY AND INSTALLATION OF POST, SIGN, AND SIGN GRAPHICS AS PER PLAN.~~

~~PAYMENT FOR THE ABOVE WILL BE MADE AT THE CONTRACT UNIT PRICE FOR ITEM SPECIAL, INTERPRETIVE SIGN.~~

ITEM 659. LAWN SEEDING:

CONTRACTOR SHALL FURNISH ALL EQUIPMENT, LABOR, AND MATERIALS NECESSARY TO PERFORM LAWN SEEDING AS PER ODOT CMS ITEM 659 AND AS PER PLAN. THIS ITEM INCLUDES SOIL PREPARATION, SUBSOIL TILLING, PERMANENT AND TEMPORARY SEEDING. SATISFACTORY GRASS ESTABLISHMENT SHALL REACH 90% DENSITY COVERAGE WITH BARE SPOTS LESS THAN 6 INCHES SQUARE.

PAYMENT FOR THE ABOVE WILL BE MADE AT THE CONTRACT UNIT PRICE FOR ITEM 659, LAWN SEEDING.

~~**BID ALTERNATES NOT IN CONTRACT**~~

~~**ITEM 608. CONCRETE CURB, FLUSH:**~~

~~CONTRACTOR SHALL FURNISH ALL EQUIPMENT, LABOR, AND MATERIALS NECESSARY TO PERFORM CONCRETE CURB, FLUSH AS PER ODOT CMS 608 AND AS PER PLAN.~~

~~PAYMENT FOR THE ABOVE WILL BE MADE AT THE CONTRACT UNIT PRICE FOR ITEM 608, CONCRETE CURB, FLUSH.~~

~~**ITEM 203. EXCAVATION. AREA 'B':**~~

~~CONTRACTOR SHALL FURNISH ALL EQUIPMENT, LABOR, AND MATERIALS NECESSARY TO PERFORM EXCAVATION AREA 'B' AS PER ODOT CMS 203 AND AS PER PLAN. THIS ITEM INCLUDES EXCAVATION, ANY REQUIRED EMBANKMENT, ANY REQUIRED BACKFILL, AND REMOVAL OF EXCESS SOIL FROM THE SITE.~~

~~PAYMENT FOR THE ABOVE WILL BE MADE AT THE CONTRACT UNIT PRICE FOR ITEM 203, EXCAVATION AREA 'B'.~~

~~**ITEM SPECIAL. BIORETENTION SOIL. AREA 'B':**~~

~~CONTRACTOR SHALL FURNISH ALL EQUIPMENT, LABOR, AND MATERIALS NECESSARY TO PERFORM BIORETENTION SOIL AS PER PLAN. THIS ITEM INCLUDES FURNISHING AND INSTALLING BIORETENTION SOIL.~~

~~PAYMENT FOR THE ABOVE WILL BE MADE AT THE CONTRACT UNIT PRICE FOR ITEM SPECIAL, BIORETENTION SOIL, AREA 'B'.~~

~~**ITEM SPECIAL. BIORETENTION STONE. AREA 'B':**~~

~~CONTRACTOR SHALL FURNISH ALL EQUIPMENT, LABOR, AND MATERIALS NECESSARY TO PERFORM BIORETENTION STONE AS PER PLAN. THIS ITEM INCLUDES FURNISHING AND INSTALLING THE BIORETENTION FILTER LAYER AND GRAVEL JACKET AS PER PLAN.~~

~~PAYMENT FOR THE ABOVE WILL BE MADE AT THE CONTRACT UNIT PRICE FOR ITEM SPECIAL, BIORETENTION STONE, AREA 'B'.~~



PROJECT

FAIRHILL PARTNERS CAMPUS

12200 FAIRHILL ROAD
CLEVELAND, OH 44120



CLIENT

FAIRHILL PARTNERS

12200 FAIRHILL ROAD
CLEVELAND, OH 44120

CONSULTANT

AECOM
1300 E. 9TH STREET, SUITE 500
CLEVELAND, OH 44114
216.622.2300 tel 216.622.2301 fax
www.aecom.com

REGISTRATION

ISSUE/REVISION

NO.	DATE	DESCRIPTION
1	7/5/2018	60% REVIEW SET
2	7/17/2018	90% REVIEW SET
3	8/02/2018	100% REVIEW SET
4	8/13/2018	100% BID SET
5	2/21/2019	ISSUED FOR CONSTRUCTION
I/R	DATE	DESCRIPTION

PROJECT NUMBER

60578006

SHEET TITLE

GENERAL NOTES

SHEET NUMBER

G101

PROJECT

**FAIRHILL PARTNERS
CAMPUS**

12200 FAIRHILL ROAD
CLEVELAND, OH 44120



CLIENT

FAIRHILL PARTNERS

12200 FAIRHILL ROAD
CLEVELAND, OH 44120

CONSULTANT

AECOM
1300 E. 9TH STREET, SUITE 500
CLEVELAND, OH 44114
216.622.2300 tel 216.622.2301 fax
www.aecom.com

REGISTRATION

ISSUE/REVISION

1	7/5/2018	60% REVIEW SET
2	7/17/2018	90% REVIEW SET
3	8/02/2018	100% REVIEW SET
4	8/13/2018	100% BID SET
5	2/21/2019	ISSUED FOR CONSTRUCTION

I/R	DATE	DESCRIPTION
-----	------	-------------

PROJECT NUMBER

60578006

SHEET TITLE

BID TABULATION

SHEET NUMBER

G200

ITEM	SHEET NUMBERS					ITEM	GRAND TOTAL	UNIT	DESCRIPTION
	C100	C200	C201	L200	L201				
623	1					623	1	LS	CONSTRUCTION STAKING
SPECIAL	1					SPECIAL	1	EA	TEMPORARY CONSTRUCTION SIGN
624	1					624	1	LS	MOBILIZATION
252	440					252	440	CY	PAVEMENT DEMOLITION, HAUL AWAY, AREA 'A'
651	215					651	215	CY	TOPSOIL STRIPPING AND STOCKPILING (4")
203	1074					203	1074	CY	EXCAVATION, AREA 'A'
611			8			611	8	EA	CATCH BASIN, MANHOLE ADJUST TO GRADE
SPECIAL			3			SPECIAL	3	EA	CATCH BASIN GRATE REPLACEMENT
609	560					609	560	LF	CONCRETE CURB, FLUSH
252		1978				252	1978	SY	ASPHALT PAVEMENT, AREA 'A' (10")
SPECIAL		50				SPECIAL	50	EA	PARKING BLOCK
641		1				641	1	LS	PAVEMENT STRIPING
605			230			605	230	LF	4" UNDERDRAIN
SPECIAL	1					SPECIAL	BY NEGROSD		INTERPRETIVE SIGN
SPECIAL		95				SPECIAL	95	CY	BIORETENTION 'A' SOIL
SPECIAL		94				SPECIAL	94	CY	BIORETENTION 'A' STONE & FILTER LAYERS
652		215				652	215	CY	TOPSOIL SPREADING (4")
661					2	661	2	EA	DEC. TREE, ACER RUBRUM
661				16		661	16	EA	DEC. TREE, AMELANCHIER CANADENSIS
661				2		661	2	EA	DEC. TREE, PRUNUS AVIUM 'KRISTIN'
661				2		661	2	EA	DEC. TREE, PRUNUS AVIUM 'HEDELFINGEN'
661					1	661	1	EA	DEC. TREE, QUERCUS RUBRA
659				1922		659	1922	SY	SEEDING, LAWN
671				1733		671	1733	SY	EROSION CONTROL MAT
BID ALTERNATES									
252	147					252	147	CY	PAVEMENT DEMOLITION, HAUL AWAY, AREA 'B'
252	440					252	440	SY	ASPHALT PAVEMENT, AREA 'B'
202	2					202	2	EA	CURB CUT
609	82					609	82	LF	CONCRETE CURB, FLUSH
611	7		2			611	7	EA	CATCH BASIN GRATE REPLACEMENT
201	83					201	83	CY	BIORETENTION 'B' EXCAVATION
SPECIAL	42					SPECIAL	42	CY	BIORETENTION 'B' SOIL
SPECIAL	21					SPECIAL	21	CY	BIORETENTION 'B' STONE
661	60			60		661	60	EA	PERENNIAL, CAREX LURIDA
661	40			40		661	40	EA	PERENNIAL, CAREX VULPINOIDEA
661	74			74		661	74	EA	PERENNIAL, IRIS SIBIRICA 'CAESAR'S BROTHER'
661	130			130		661	130	EA	PERENNIAL, LIATRIS SPICATA
661	165			165		661	165	EA	PERENNIAL, RUDBECKIA FULGIDA VAR. SULLIVANTII 'GOLDFURM'

ISSUE/REVISION		
I/R	DATE	DESCRIPTION
1	7/5/2018	60% REVIEW SET
2	7/17/2018	90% REVIEW SET
3	8/02/2018	100% REVIEW SET
4	8/13/2018	100% BID SET
5	2/21/2019	ISSUED FOR CONSTRUCTION

PROJECT NUMBER
 60578006

SHEET TITLE
 EXISTING CONDITIONS PLAN

SHEET NUMBER
 C000

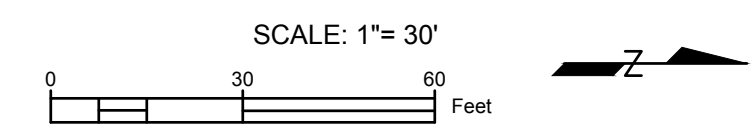
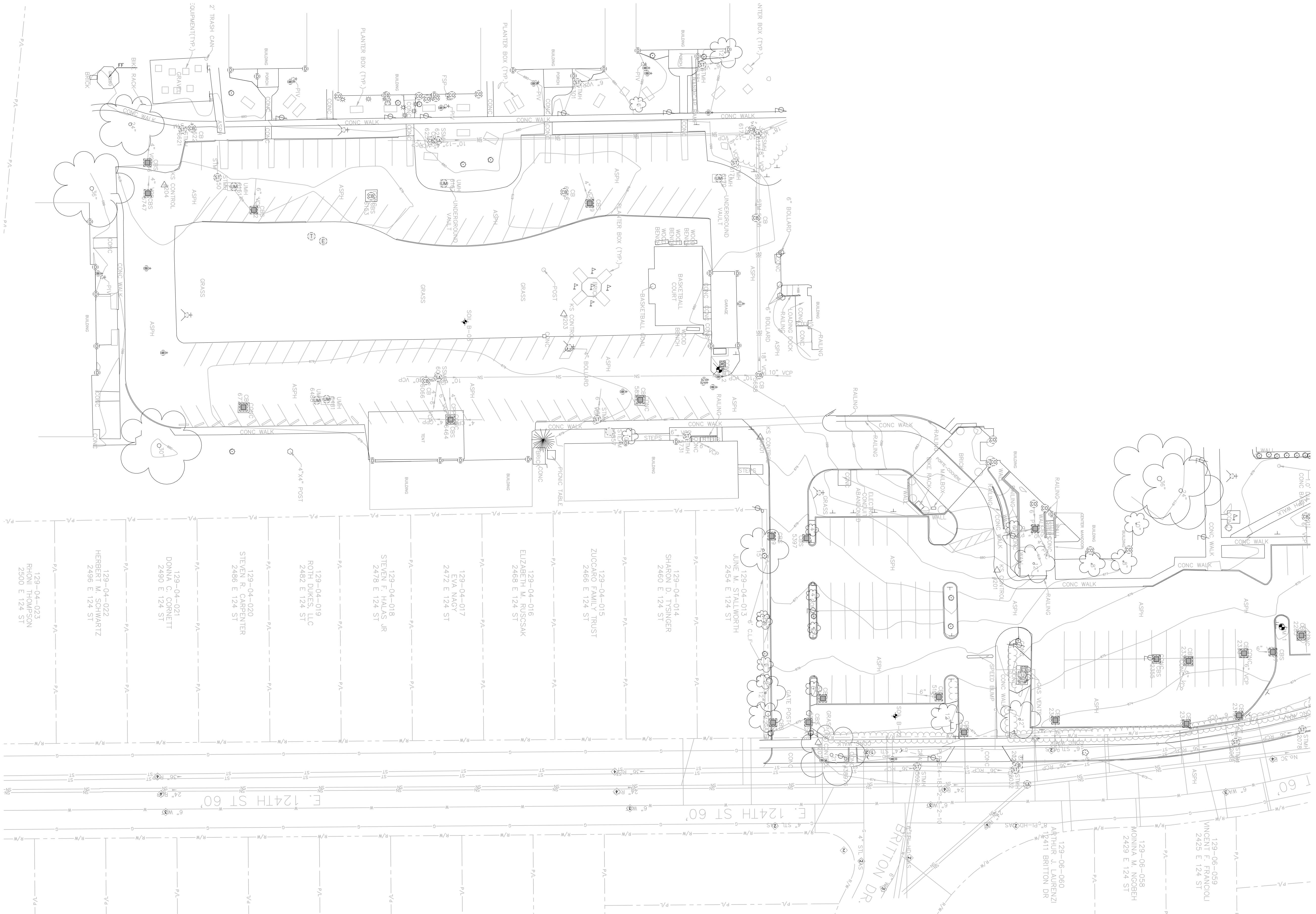

SITE SURVEY PREPARED BY:
 KS Associates, Inc.
 260 Burns Road, Suite 100
 Cuyahoga Falls, OH 44035
 P 440 365 4730
 F 440 365 4790
 www.ksassociates.com

Last saved by: CHRISTA RADOSAVLJEVIC(2018-06-07) Last Plotted: 2019-02-28
 Project Management Initials: Designer: _____ Checked: _____ Approved: _____
 ANS I D 22' x 34'
 Filename: G:\CLEVELAND\DCS\PROJECTS\BOL160578006_FAIRPARTG1900_CAD_GIS\910_CAD\20-SHEETS\C000_EXISTING CONDITIONS.DWG

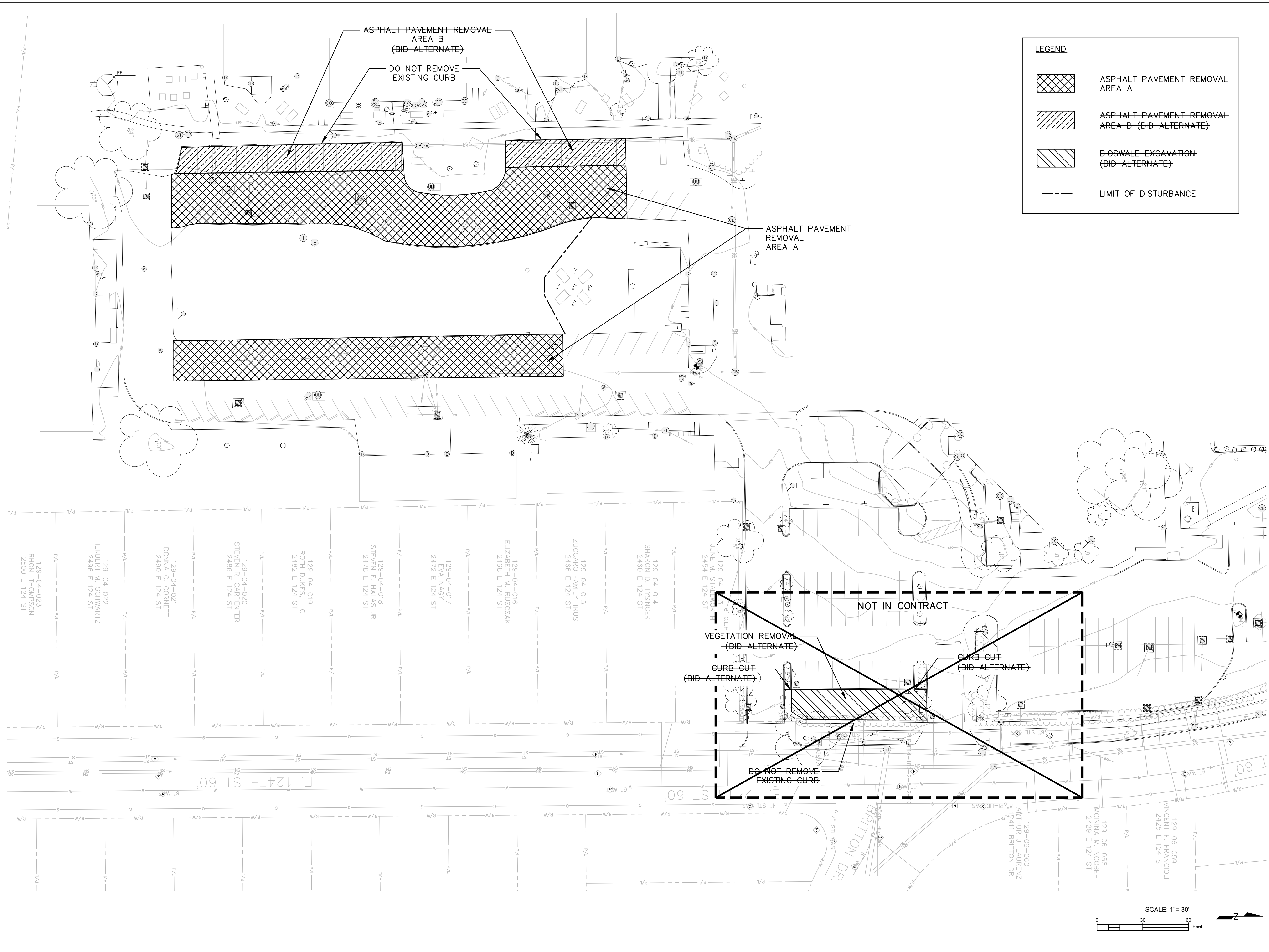

LEGEND

- ASPHALT PAVEMENT REMOVAL AREA A
- ASPHALT PAVEMENT REMOVAL AREA B (BID-ALTERNATE)
- LIMIT OF DISTURBANCE



PROJECT
FAIRHILL PARTNERS CAMPUS
 12200 FAIRHILL ROAD
 CLEVELAND, OH 44120



CLIENT
FAIRHILL PARTNERS
 12200 FAIRHILL ROAD
 CLEVELAND, OH 44120

CONSULTANT
 AECOM
 1300 E. 9TH STREET, SUITE 500
 CLEVELAND, OH 44114
 216.622.2300 tel 216.622.2301 fax
 www.aecom.com

REGISTRATION

ISSUE/REVISION

1/R	DATE	DESCRIPTION
1	7/5/2018	60% REVIEW SET
2	7/17/2018	90% REVIEW SET
3	8/02/2018	100% REVIEW SET
4	8/13/2018	100% BID SET
5	2/21/2019	ISSUED FOR CONSTRUCTION

PROJECT NUMBER
 60578006

SHEET TITLE
 DEMOLITION PLAN

SHEET NUMBER
 C100

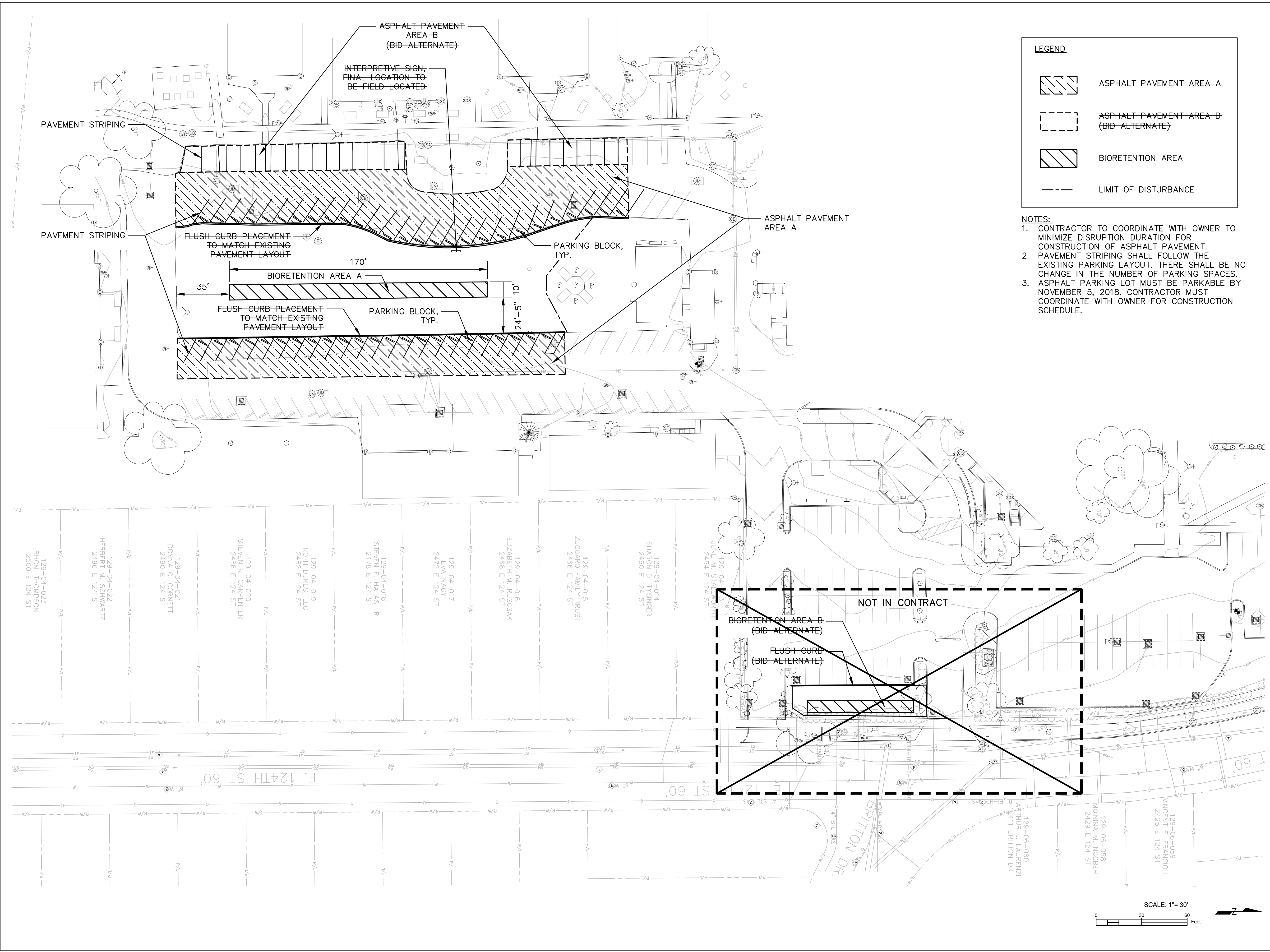

ISSUE/REVISION

1	7/5/2018	60% REVIEW SET
2	7/17/2018	90% REVIEW SET
3	8/02/2018	100% REVIEW SET
4	8/13/2018	100% BID SET
5	2/21/2019	ISSUED FOR CONSTRUCTION

I/R	DATE	DESCRIPTION

Last saved by: CHRISTA RADOSAVLJEVI(2019-02-21) Last Plotted: 2019-02-28
 File name: G:\CLEVELAND\DCS\PROJECTS\BOL60578006_FAIRPARTNERS\CAD_GIS\910_CAD\20-SHEETS\C200_SITE_PLAN.DWG
 Project Management Initials: Designer: _____ Checked: _____ Approved: _____ ANS I D 22" x 34"

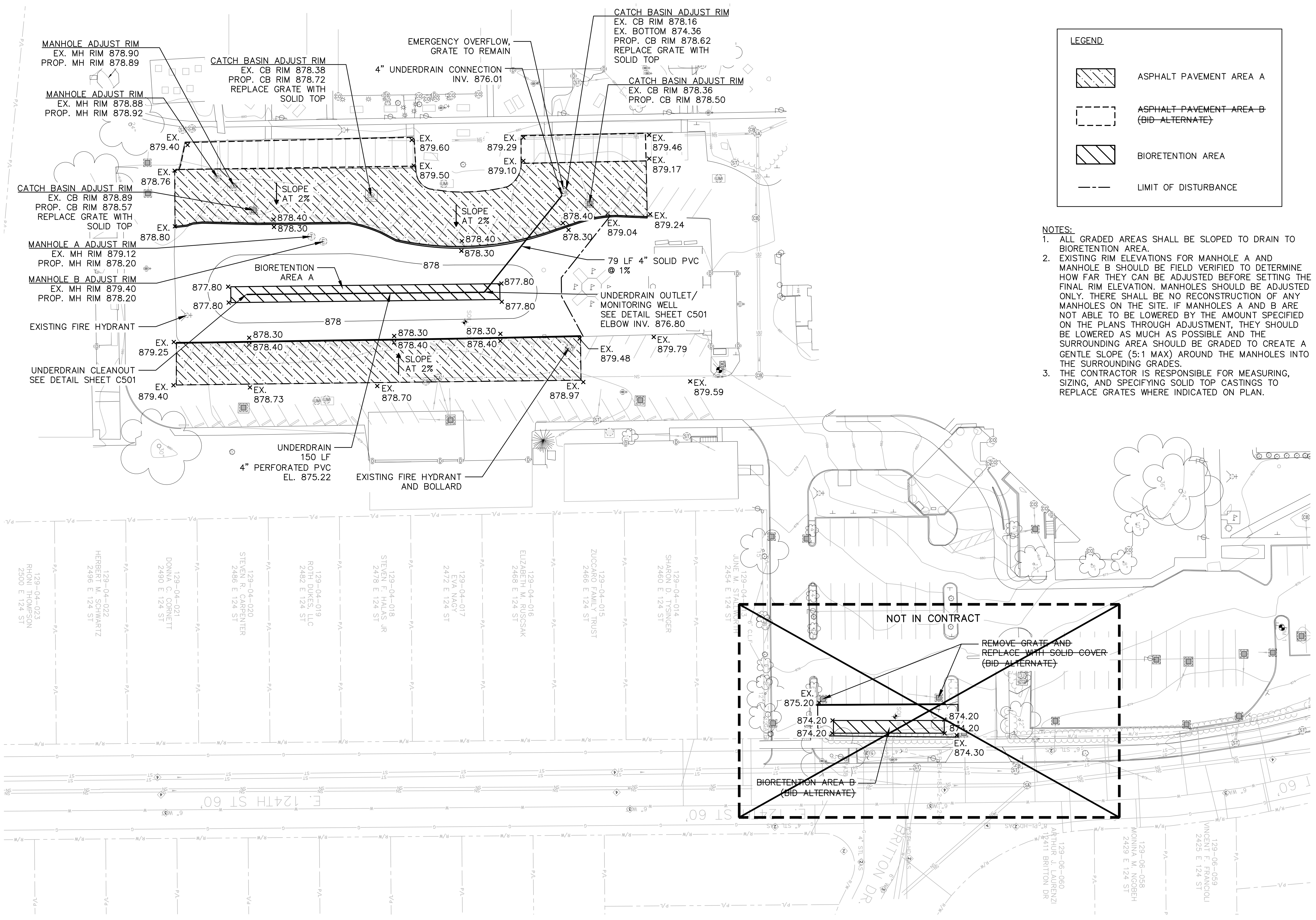

LEGEND

- ASPHALT PAVEMENT AREA A
- ASPHALT PAVEMENT AREA B (BID-ALTERNATE)
- BIORETENTION AREA
- LIMIT OF DISTURBANCE

- NOTES:**
- ALL GRADED AREAS SHALL BE SLOPED TO DRAIN TO BIORETENTION AREA.
 - EXISTING RIM ELEVATIONS FOR MANHOLE A AND MANHOLE B SHOULD BE FIELD VERIFIED TO DETERMINE HOW FAR THEY CAN BE ADJUSTED BEFORE SETTING THE FINAL RIM ELEVATION. MANHOLES SHOULD BE ADJUSTED ONLY. THERE SHALL BE NO RECONSTRUCTION OF ANY MANHOLES ON THE SITE. IF MANHOLES A AND B ARE NOT ABLE TO BE LOWERED BY THE AMOUNT SPECIFIED ON THE PLANS THROUGH ADJUSTMENT, THEY SHOULD BE LOWERED AS MUCH AS POSSIBLE AND THE SURROUNDING AREA SHOULD BE GRADED TO CREATE A GENTLE SLOPE (5:1 MAX) AROUND THE MANHOLES INTO THE SURROUNDING GRADES.
 - THE CONTRACTOR IS RESPONSIBLE FOR MEASURING, SIZING, AND SPECIFYING SOLID TOP CASTINGS TO REPLACE GRATES WHERE INDICATED ON PLAN.



PROJECT
FAIRHILL PARTNERS CAMPUS
 12200 FAIRHILL ROAD
 CLEVELAND, OH 44120



CLIENT
FAIRHILL PARTNERS
 12200 FAIRHILL ROAD
 CLEVELAND, OH 44120

CONSULTANT
 AECOM
 1300 E. 9TH STREET, SUITE 500
 CLEVELAND, OH 44114
 216.622.2300 tel 216.622.2301 fax
 www.aecom.com

REGISTRATION

ISSUE/REVISION

1	7/5/2018	60% REVIEW SET
2	7/17/2018	90% REVIEW SET
3	8/02/2018	100% REVIEW SET
4	8/13/2018	100% BID SET
5	2/21/2019	ISSUED FOR CONSTRUCTION

I/R	DATE	DESCRIPTION

PROJECT NUMBER
 60578006

SHEET TITLE
 SITE GRADING PLAN

SHEET NUMBER
 C201

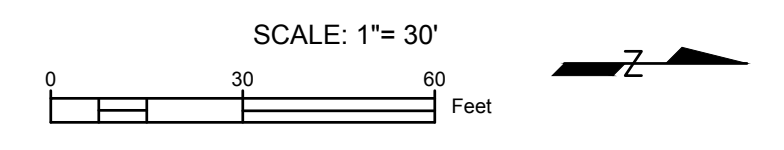

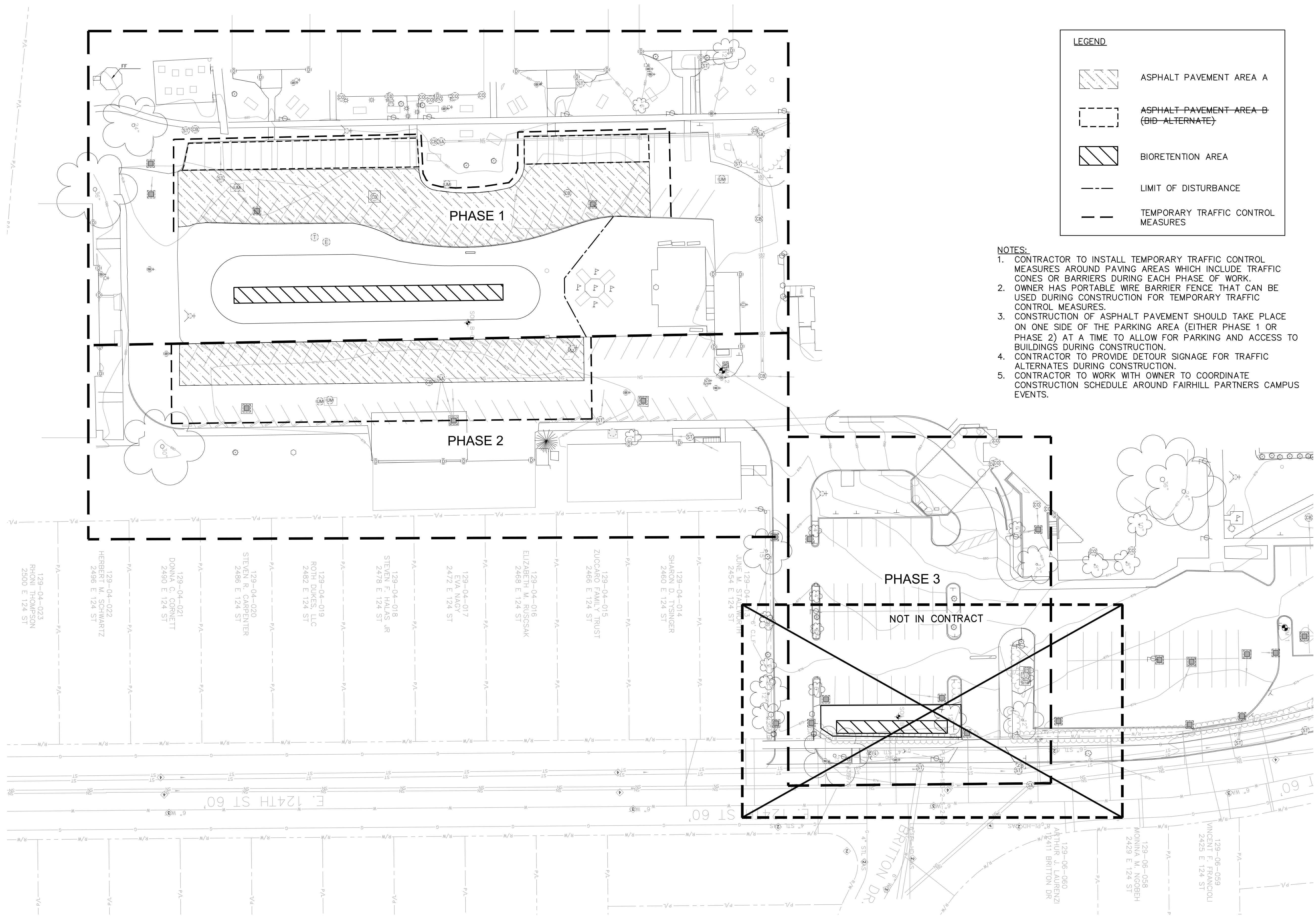

LEGEND	
	ASPHALT PAVEMENT AREA A
	ASPHALT PAVEMENT AREA B (BID ALTERNATE)
	BIORETENTION AREA
	LIMIT OF DISTURBANCE
	TEMPORARY TRAFFIC CONTROL MEASURES

- NOTES:**
1. CONTRACTOR TO INSTALL TEMPORARY TRAFFIC CONTROL MEASURES AROUND PAVING AREAS WHICH INCLUDE TRAFFIC CONES OR BARRIERS DURING EACH PHASE OF WORK.
 2. OWNER HAS PORTABLE WIRE BARRIER FENCE THAT CAN BE USED DURING CONSTRUCTION FOR TEMPORARY TRAFFIC CONTROL MEASURES.
 3. CONSTRUCTION OF ASPHALT PAVEMENT SHOULD TAKE PLACE ON ONE SIDE OF THE PARKING AREA (EITHER PHASE 1 OR PHASE 2) AT A TIME TO ALLOW FOR PARKING AND ACCESS TO BUILDINGS DURING CONSTRUCTION.
 4. CONTRACTOR TO PROVIDE DETOUR SIGNAGE FOR TRAFFIC ALTERNATES DURING CONSTRUCTION.
 5. CONTRACTOR TO WORK WITH OWNER TO COORDINATE CONSTRUCTION SCHEDULE AROUND FAIRHILL PARTNERS CAMPUS EVENTS.

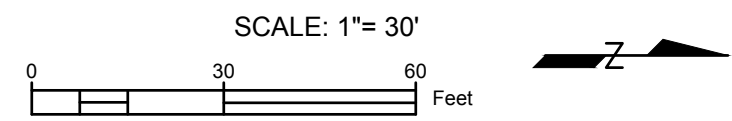

PROJECT
FAIRHILL PARTNERS CAMPUS
 12200 FAIRHILL ROAD
 CLEVELAND, OH 44120



CLIENT
FAIRHILL PARTNERS
 12200 FAIRHILL ROAD
 CLEVELAND, OH 44120

CONSULTANT
 AECOM
 1300 E. 9TH STREET, SUITE 500
 CLEVELAND, OH 44114
 216.622.2300 tel 216.622.2301 fax
 www.aecom.com

REGISTRATION

ISSUE/REVISION		
I/R	DATE	DESCRIPTION
1	7/5/2018	60% REVIEW SET
2	7/17/2018	90% REVIEW SET
3	8/02/2018	100% REVIEW SET
4	8/13/2018	100% BID SET
5	2/21/2019	ISSUED FOR CONSTRUCTION

PROJECT NUMBER
 60578006

SHEET TITLE
 SITE PHASING PLAN

SHEET NUMBER
 C202

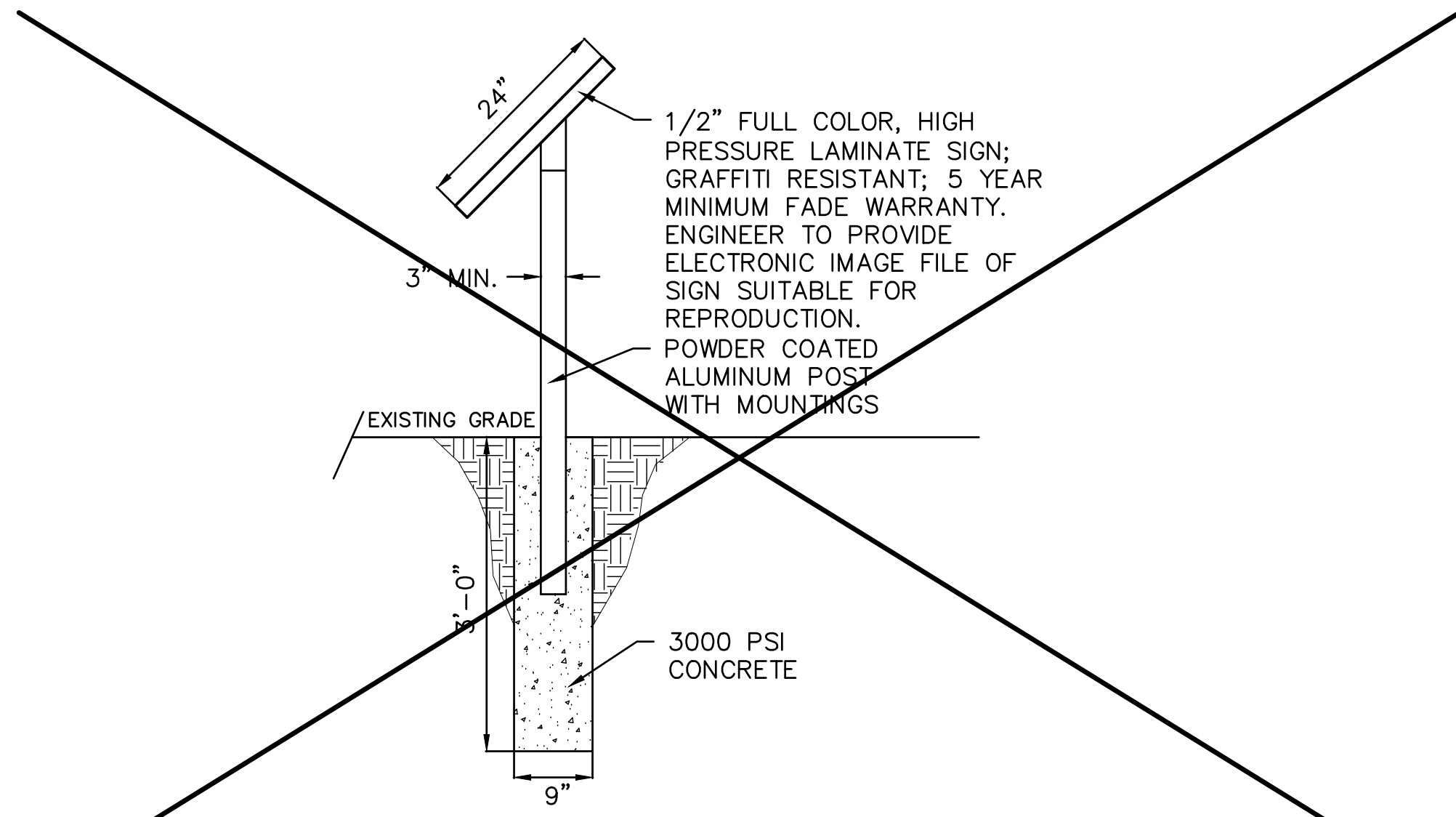

1 INTERPRETIVE SIGN NOT IN CONTRACT
SCALE: NTS

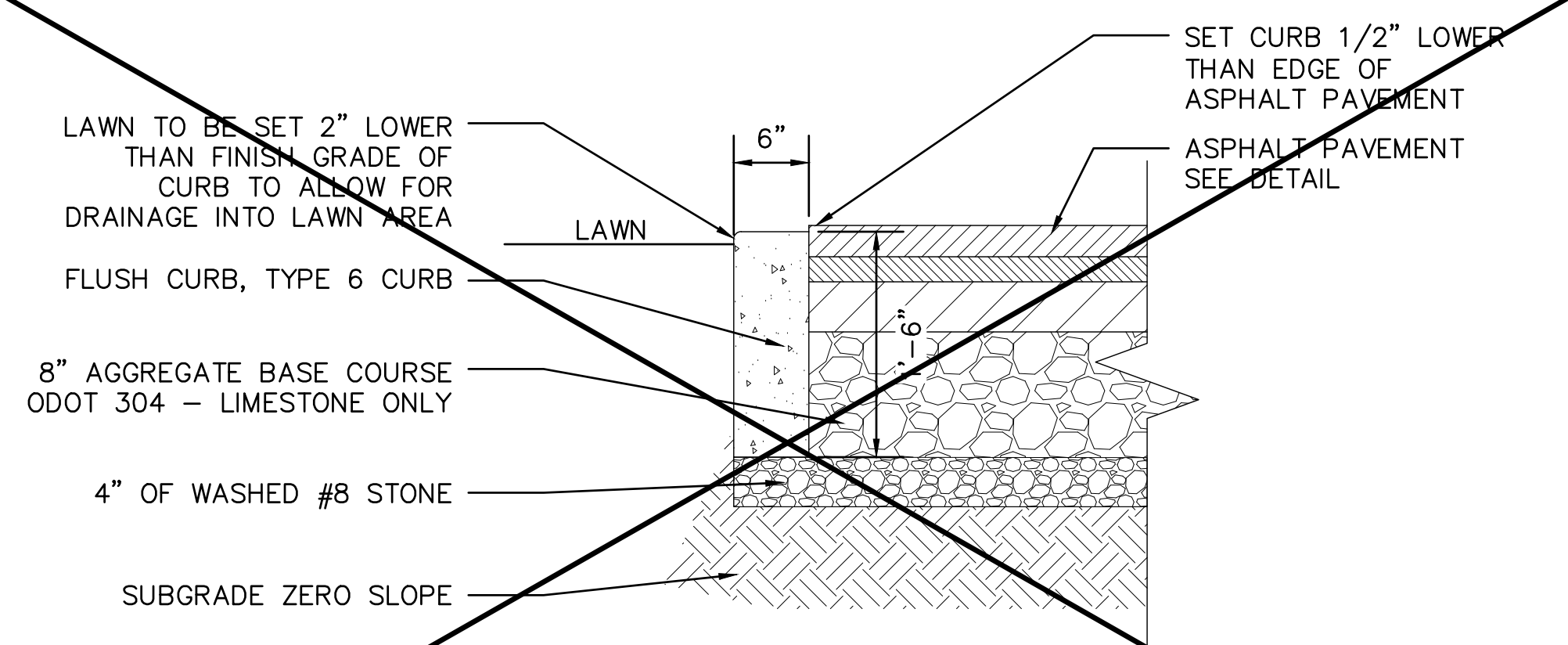

NOTES:
1. TOP OF CURB TO BE FINISHED FLAT OR GENTLY SLOPING AWAY FROM PAVEMENT TO ALLOW FOR DRAINAGE FROM THE ADJACENT ASPHALT PAVEMENT.

2 FLUSH CURB NOT IN CONTRACT
SCALE: NTS

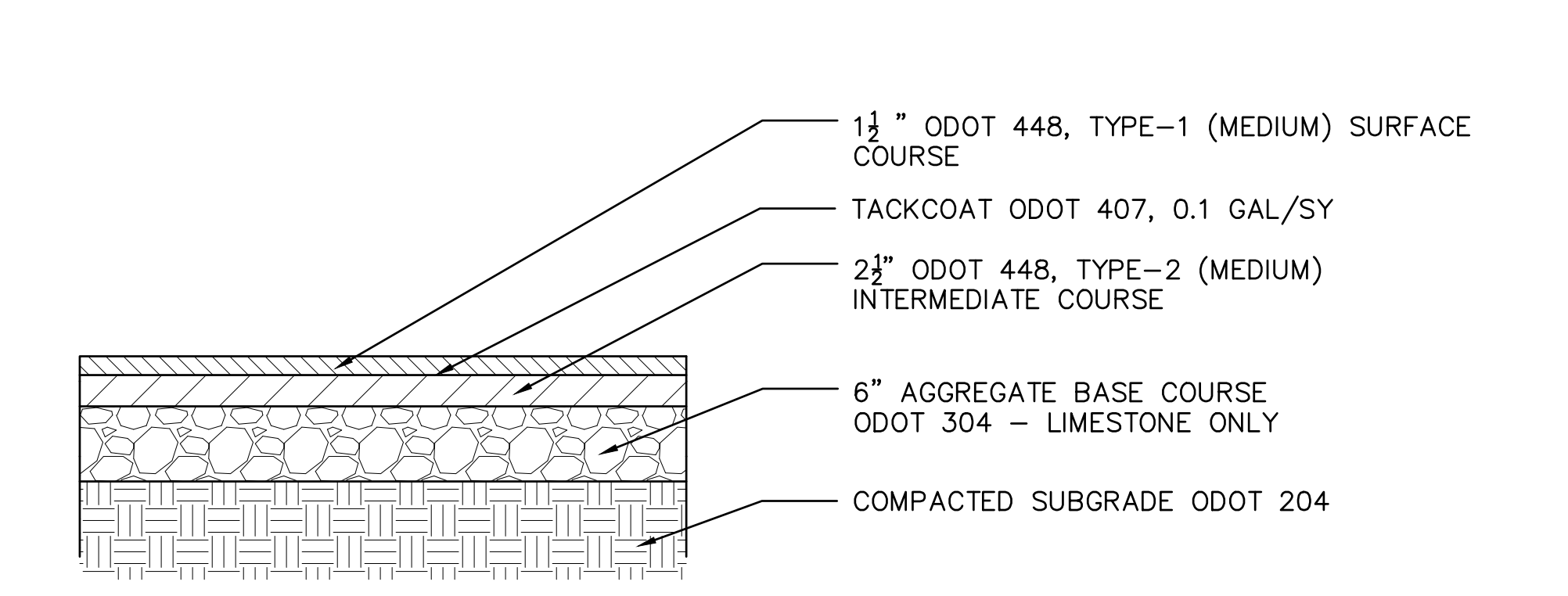

NOTES:
1. PROOFROLL THE SUBGRADE AFTER COMPACTION WITH A TRI-AXLE TRUCK LOADED WITH 20 TONS.
2. COMPACT AGGREGATE BASE TO 98% OF DRY DENSITY BASED ON A STANDARD PROCTOR.

3 ASPHALT PAVEMENT
SCALE: NTS

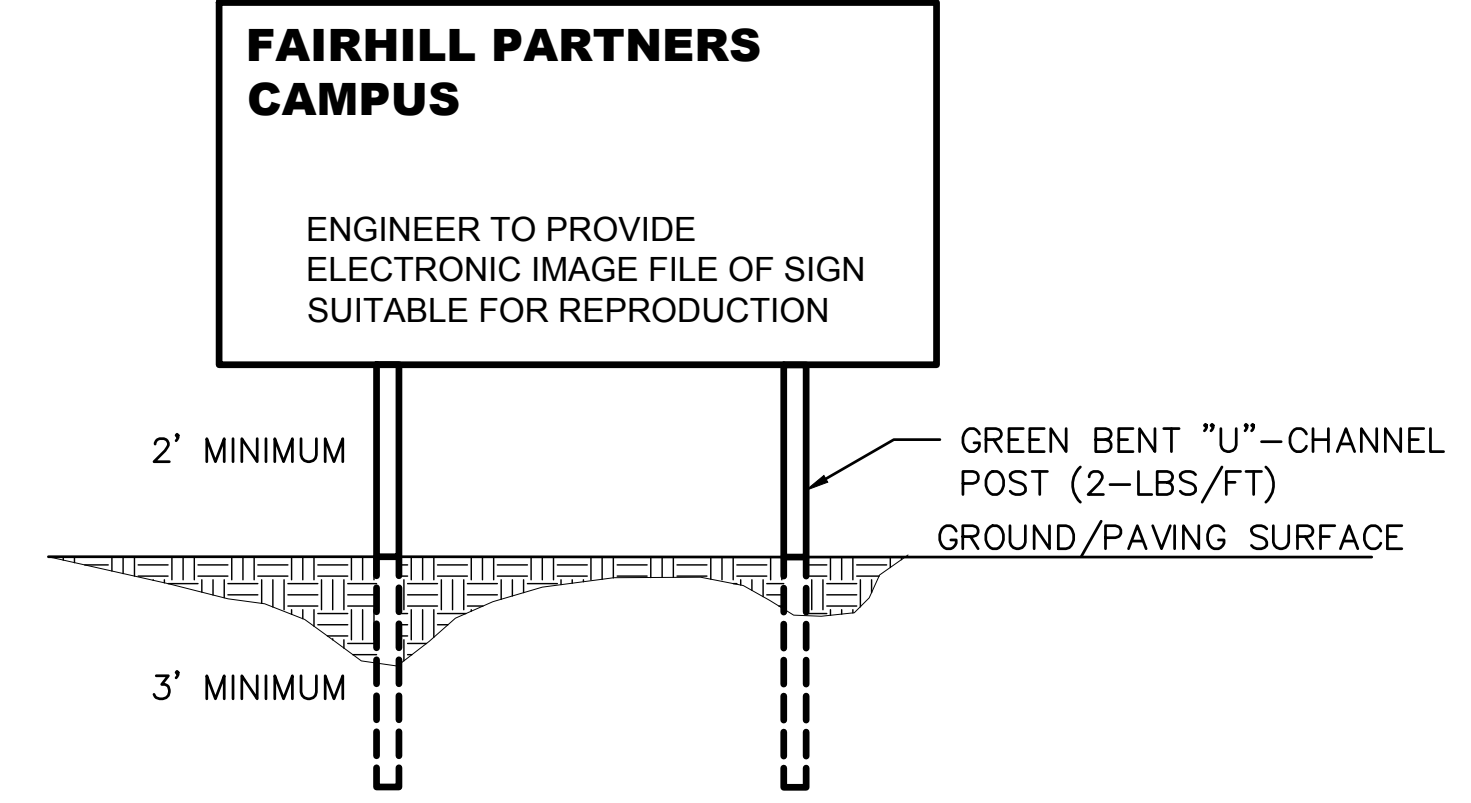

NOTES:
1. SIGN TO BE RAIN PROOF
2. CONTRACTOR TO REMOVE SIGN AT COMPLETION OF CONSTRUCTION
3. MINIMUM SIGN DIMENSIONS: (2'X4'X3/4") EXTERIOR MOUNTED TO PLYWOOD (A-B GRADE)

4 TEMPORARY CONSTRUCTION SIGN
SCALE: NTS

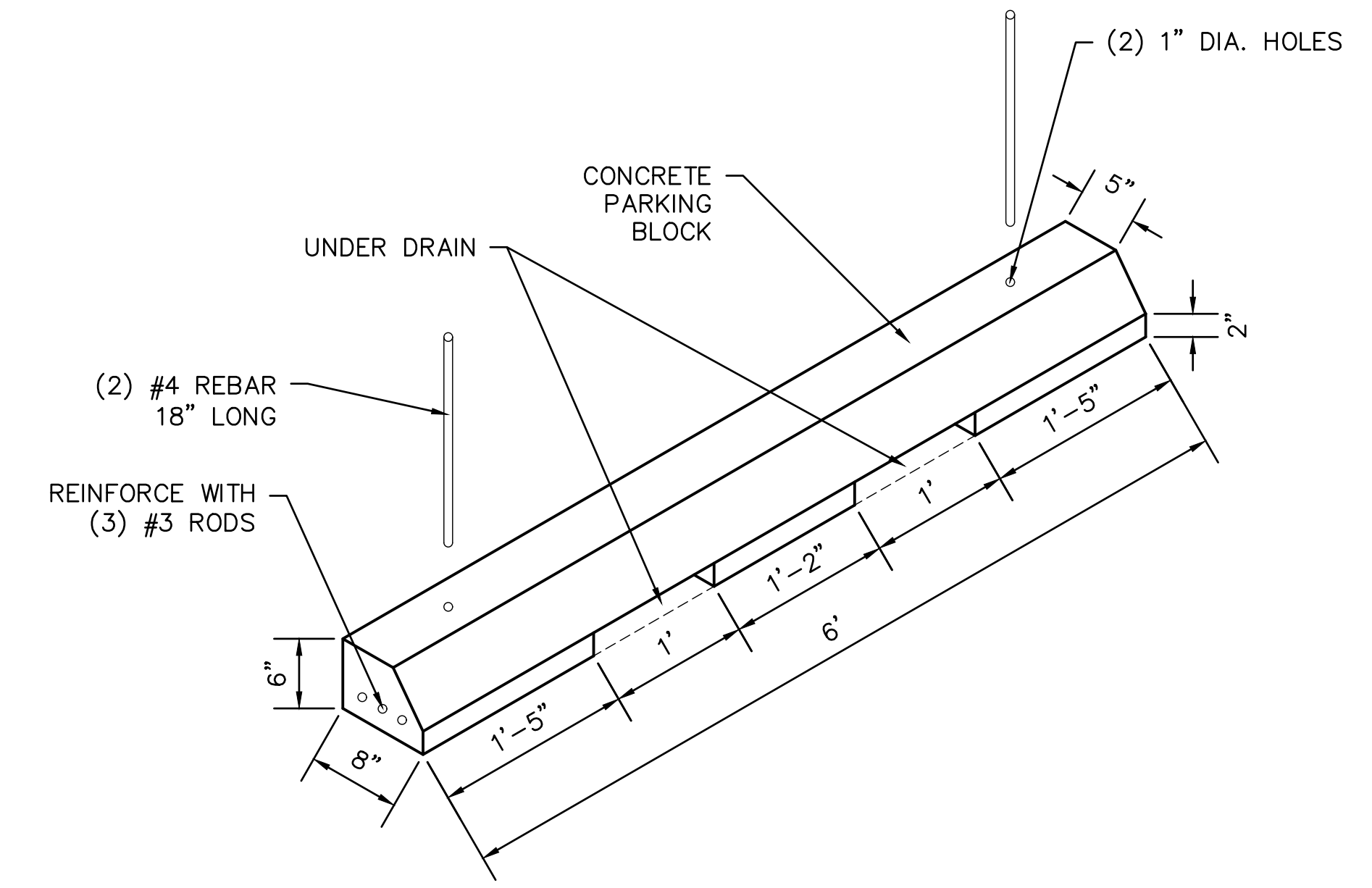

5 PARKING BLOCK
SCALE: NTS

ISSUE/REVISION	DATE	DESCRIPTION
1	7/5/2018	60% REVIEW SET
2	7/17/2018	90% REVIEW SET
3	8/02/2018	100% REVIEW SET
4	8/13/2018	100% BID SET
5	2/21/2019	ISSUED FOR CONSTRUCTION
I/R	DATE	DESCRIPTION

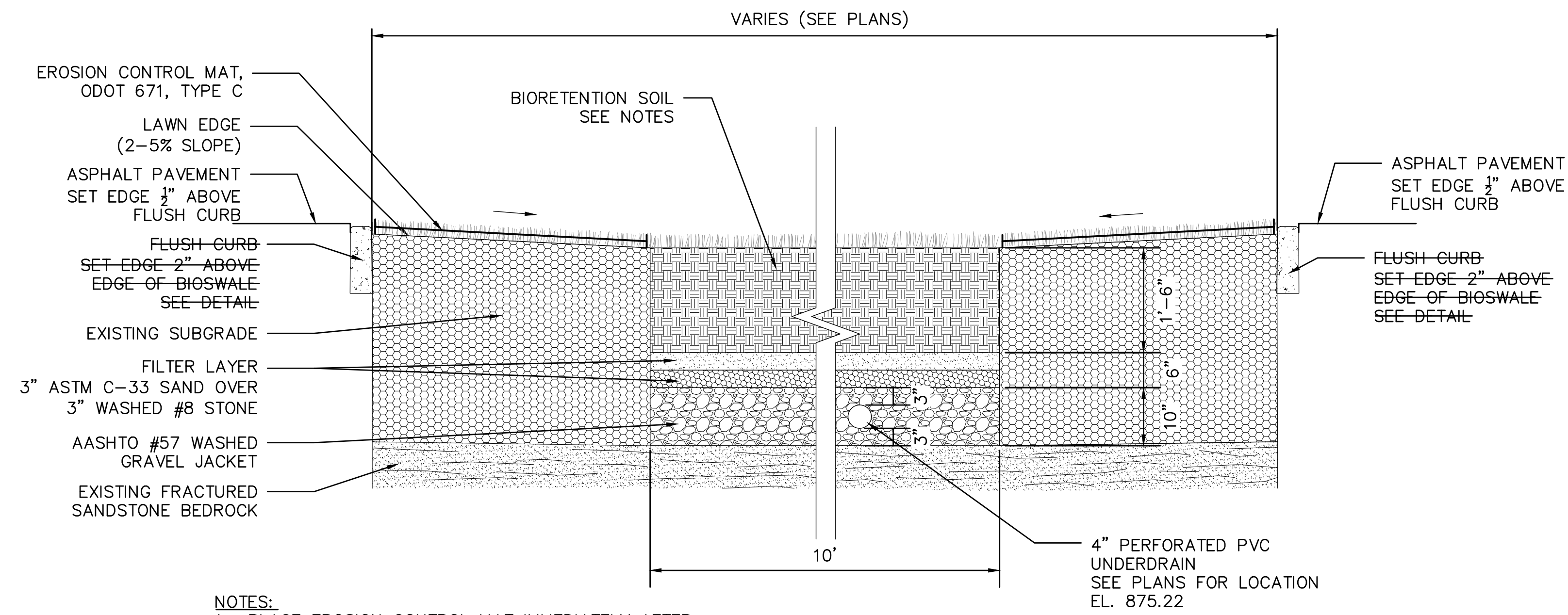

- NOTES:**
1. PLACE EROSION CONTROL MAT IMMEDIATELY AFTER INSTALLATION OF BIORETENTION AREA.
 2. CONTRACTOR TO EXCAVATE TO FRACTURED SANDSTONE BEDROCK AND EXPOSE TOP SURFACE. BIORETENTION AREA TO SIT DIRECTLY ON EXPOSED SURFACE OF BEDROCK. THE NORTHERN 1/3 OF BIORETENTION AREA MAY REQUIRE A MAXIMUM OF 6" OF BEDROCK EXCAVATION.

1 BIORETENTION AREA A
SCALE: NTS

- BIORETENTION SOIL NOTES:**
1. BIORETENTION SOIL SHALL BE A MIX OF SAND, WELL-DECOMPOSED ORGANIC MATTER (E.G. COMPOST) AND TOPSOIL TO OBTAIN SOIL MEDIA MEETING THESE REQUIREMENTS:
 - TEXTURE CLASS: LOAMY SAND HAVING NO LESS THAN 80% SAND AND NO GREATER THAN 10% CLAY CONSIDERING ONLY THE MINERAL FRACTION OF THE SOIL
 - pH: 5.2 - 8.0
 - SOLUBLE SALTS: 500 PPM MAXIMUM
 - DECOMPOSED ORGANIC MATTER: 3-5% BY WEIGHT (NOTE: THIS TRANSLATES TO 8-20% ORGANIC MATTER BY VOLUME)
 - PHOSPHORUS: NOT TO EXCEED 60 MG/KG
 - SAND SHALL BE CLEAN SAND MEETING ASTM C-33
 2. MIXING OF BIORETENTION SOIL SHALL BE PERFORMED OFF-SITE. THE BIORETENTION SOIL MEDIA SHALL BE DELIVERED TO THE SITE PRE-MIXED AT THE TIME OF INSTALLATION.

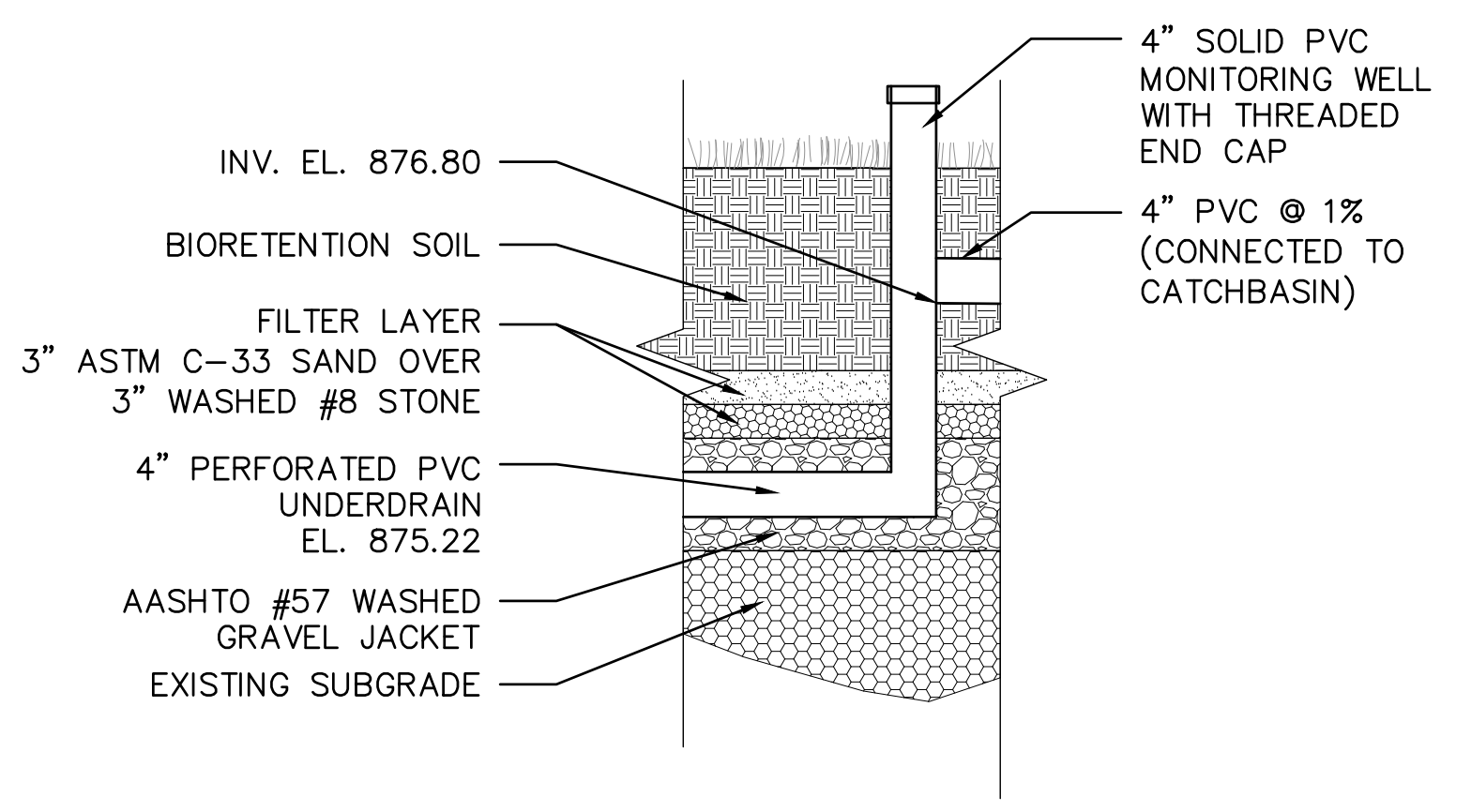

3 UNDERDRAIN OUTLET/MONITORING WELL
SCALE: NTS

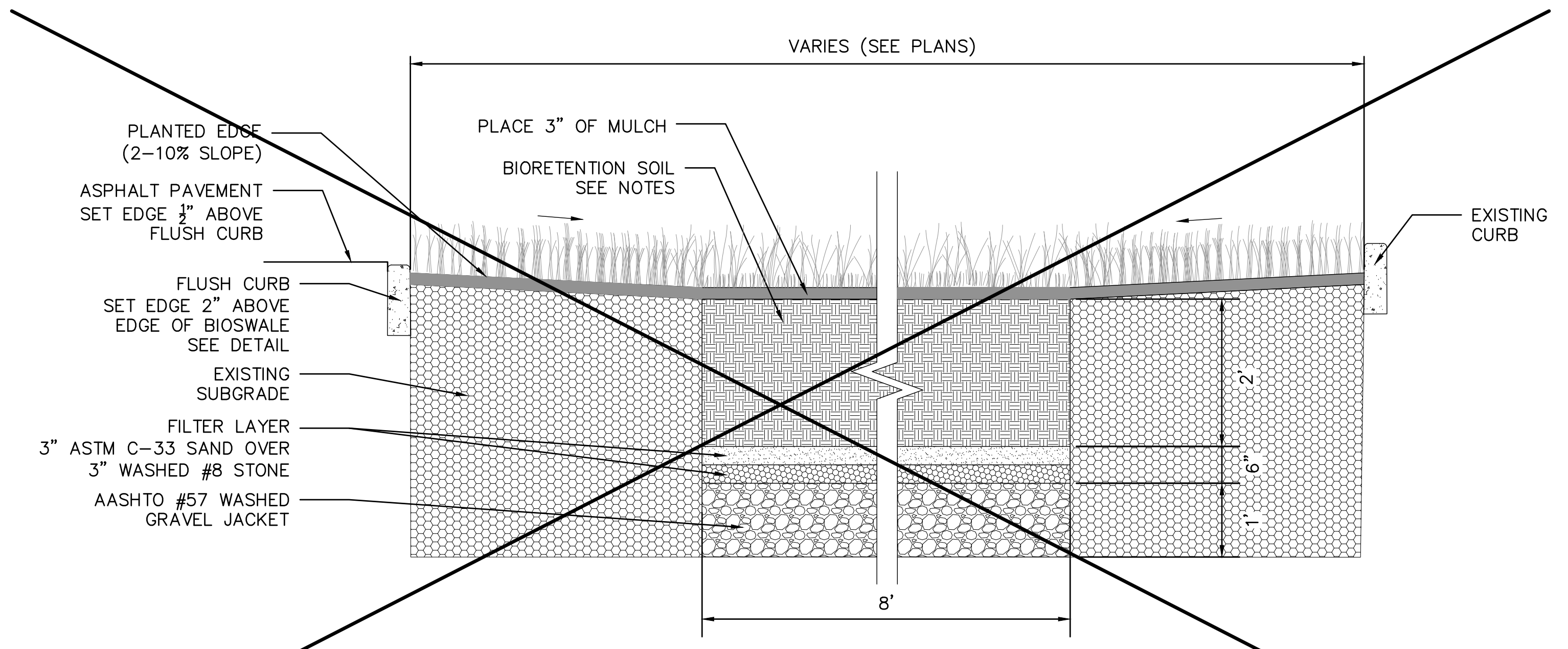

2 BIORETENTION AREA B (BID ALTERNATE)
SCALE: NTS

NOT IN CONTRACT

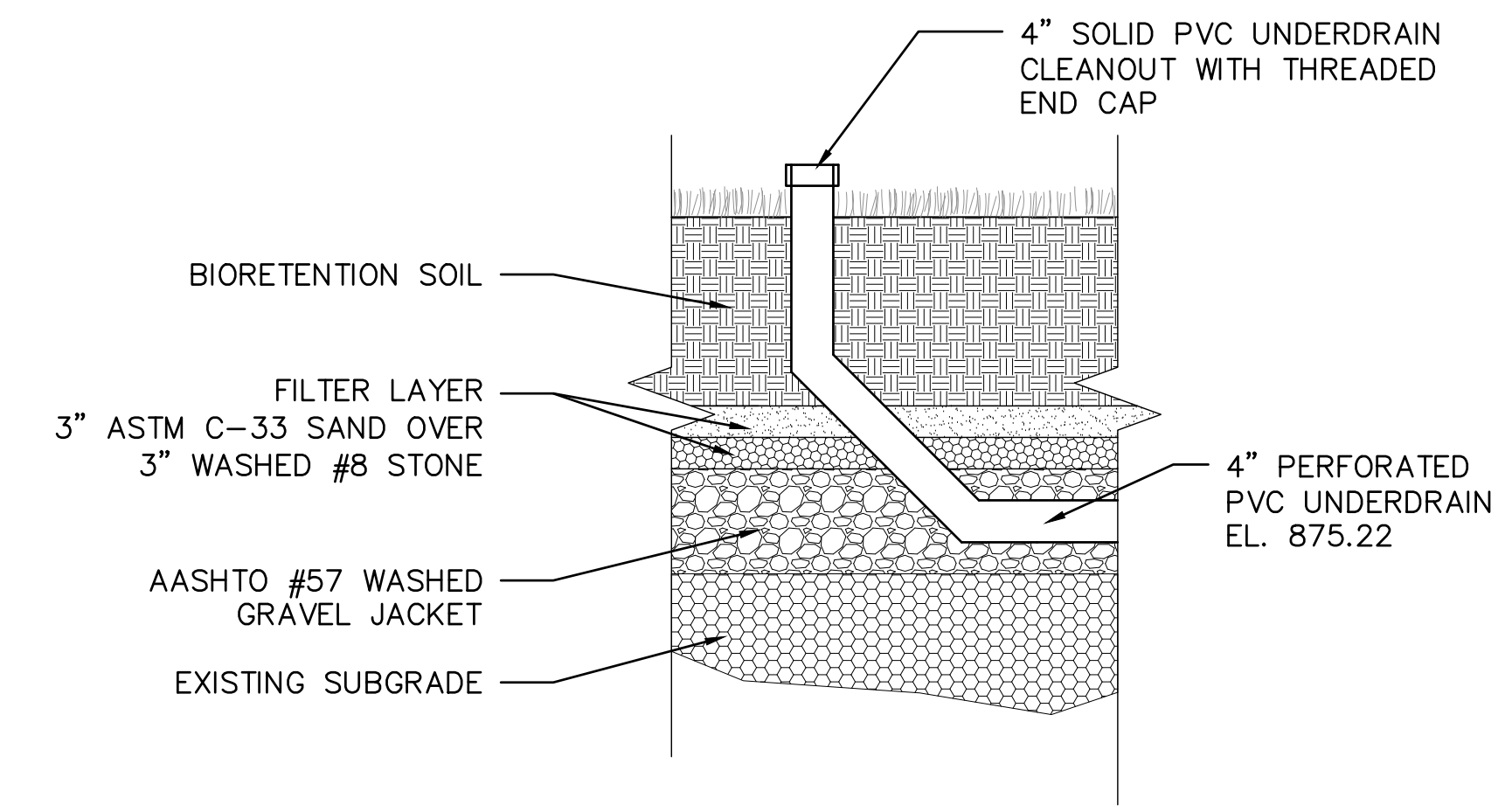

4 UNDERDRAIN CLEANOUT
SCALE: NTS



PROJECT
FAIRHILL PARTNERS CAMPUS
 12200 FAIRHILL ROAD
 CLEVELAND, OH 44120



CLIENT
FAIRHILL PARTNERS
 12200 FAIRHILL ROAD
 CLEVELAND, OH 44120

CONSULTANT
 AECOM
 1300 E. 9TH STREET, SUITE 500
 CLEVELAND, OH 44114
 216.622.2300 tel 216.622.2301 fax
 www.aecom.com

REGISTRATION

ISSUE/REVISION	DATE	DESCRIPTION
1	7/5/2018	60% REVIEW SET
2	7/17/2018	90% REVIEW SET
3	8/02/2018	100% REVIEW SET
4	8/13/2018	100% BID SET
5	2/21/2019	ISSUED FOR CONSTRUCTION
I/R	DATE	DESCRIPTION

PROJECT NUMBER
60578006

SHEET TITLE
SITE DETAILS

SHEET NUMBER
C501

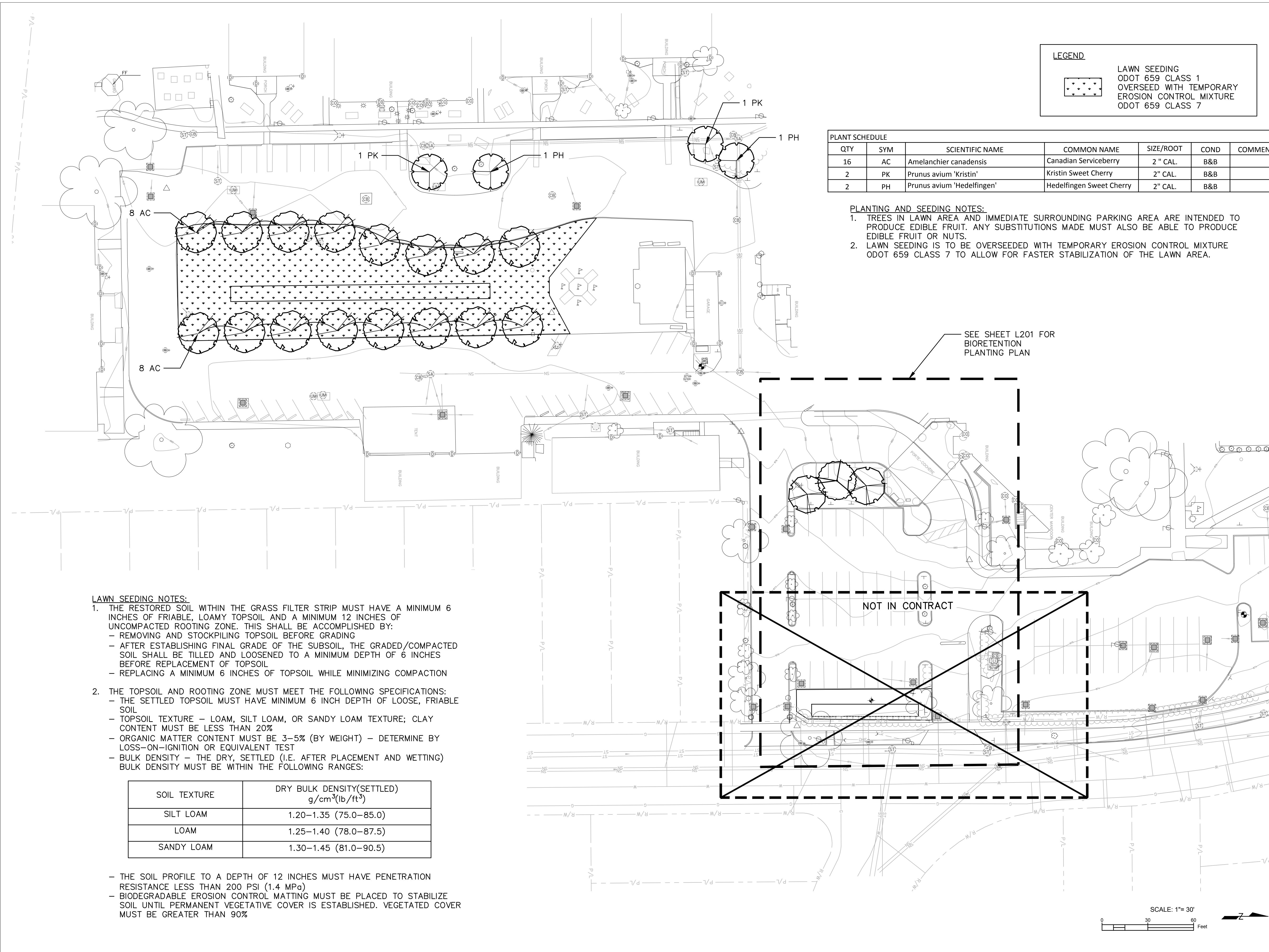

LEGEND

	LAWN SEEDING ODOT 659 CLASS 1 OVERSEED WITH TEMPORARY EROSION CONTROL MIXTURE ODOT 659 CLASS 7
--	------------------------------------------------------------------------------------------------------------

PLANT SCHEDULE

QTY	SYM	SCIENTIFIC NAME	COMMON NAME	SIZE/ROOT	COND	COMMENTS
16	AC	<i>Amelanchier canadensis</i>	Canadian Serviceberry	2" CAL.	B&B	
2	PK	<i>Prunus avium 'Kristin'</i>	Kristin Sweet Cherry	2" CAL.	B&B	
2	PH	<i>Prunus avium 'Hedelfingen'</i>	Hedelfingen Sweet Cherry	2" CAL.	B&B	

- PLANTING AND SEEDING NOTES:**
- TREES IN LAWN AREA AND IMMEDIATE SURROUNDING PARKING AREA ARE INTENDED TO PRODUCE EDIBLE FRUIT. ANY SUBSTITUTIONS MADE MUST ALSO BE ABLE TO PRODUCE EDIBLE FRUIT OR NUTS.
 - LAWN SEEDING IS TO BE OVERSEED WITH TEMPORARY EROSION CONTROL MIXTURE ODOT 659 CLASS 7 TO ALLOW FOR FASTER STABILIZATION OF THE LAWN AREA.

- LAWN SEEDING NOTES:**
- THE RESTORED SOIL WITHIN THE GRASS FILTER STRIP MUST HAVE A MINIMUM 6 INCHES OF FRIABLE, LOAMY TOPSOIL AND A MINIMUM 12 INCHES OF UNCOMPACTED ROOTING ZONE. THIS SHALL BE ACCOMPLISHED BY:
 - REMOVING AND STOCKPILING TOPSOIL BEFORE GRADING
 - AFTER ESTABLISHING FINAL GRADE OF THE SUBSOIL, THE GRADED/COMPACTED SOIL SHALL BE TILLED AND LOOSENED TO A MINIMUM DEPTH OF 6 INCHES BEFORE REPLACEMENT OF TOPSOIL
 - REPLACING A MINIMUM 6 INCHES OF TOPSOIL WHILE MINIMIZING COMPACTION
 - THE TOPSOIL AND ROOTING ZONE MUST MEET THE FOLLOWING SPECIFICATIONS:
 - THE SETTLED TOPSOIL MUST HAVE MINIMUM 6 INCH DEPTH OF LOOSE, FRIABLE SOIL
 - TOPSOIL TEXTURE – LOAM, SILT LOAM, OR SANDY LOAM TEXTURE; CLAY CONTENT MUST BE LESS THAN 20%
 - ORGANIC MATTER CONTENT MUST BE 3–5% (BY WEIGHT) – DETERMINE BY LOSS-ON-IGNITION OR EQUIVALENT TEST
 - BULK DENSITY – THE DRY, SETTLED (I.E. AFTER PLACEMENT AND WETTING) BULK DENSITY MUST BE WITHIN THE FOLLOWING RANGES:

SOIL TEXTURE	DRY BULK DENSITY (SETTLED) g/cm ³ (lb/ft ³)
SILT LOAM	1.20–1.35 (75.0–85.0)
LOAM	1.25–1.40 (78.0–87.5)
SANDY LOAM	1.30–1.45 (81.0–90.5)

- THE SOIL PROFILE TO A DEPTH OF 12 INCHES MUST HAVE PENETRATION RESISTANCE LESS THAN 200 PSI (1.4 MPa)
- BIODEGRADABLE EROSION CONTROL MATTING MUST BE PLACED TO STABILIZE SOIL UNTIL PERMANENT VEGETATIVE COVER IS ESTABLISHED. VEGETATED COVER MUST BE GREATER THAN 90%

ISSUE/REVISION

I/R	DATE	DESCRIPTION
1	7/5/2018	60% REVIEW SET
2	7/17/2018	90% REVIEW SET
3	8/02/2018	100% REVIEW SET
4	8/13/2018	100% BID SET
5	2/21/2019	ISSUED FOR CONSTRUCTION

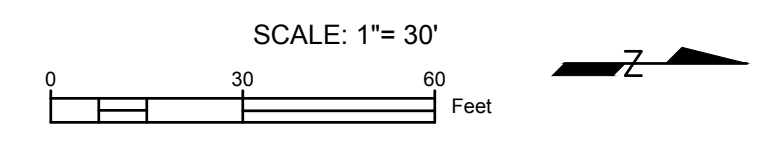

ISSUE/REVISION

I/R	DATE	DESCRIPTION
1	7/5/2018	60% REVIEW SET
2	7/17/2018	90% REVIEW SET
3	8/02/2018	100% REVIEW SET
4	8/13/2018	100% BID SET
5	2/21/2019	ISSUED FOR CONSTRUCTION

PROJECT NUMBER
 60578006

SHEET TITLE
 BIORETENTION PLANTING
 PLAN

SHEET NUMBER
 L201

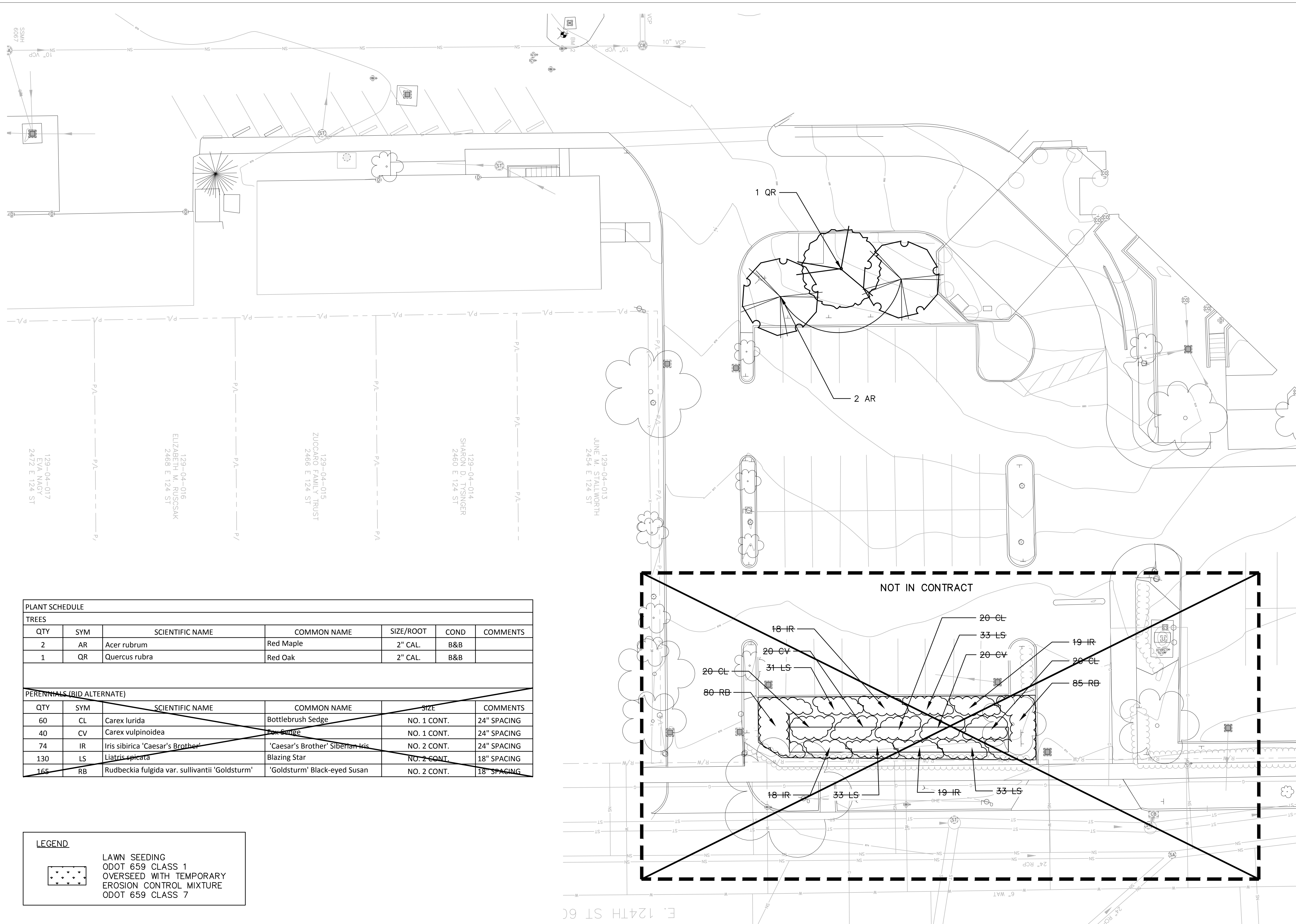

PLANT SCHEDULE						
TREES						
QTY	SYM	SCIENTIFIC NAME	COMMON NAME	SIZE/ROOT	COND	COMMENTS
2	AR	<i>Acer rubrum</i>	Red Maple	2" CAL.	B&B	
1	QR	<i>Quercus rubra</i>	Red Oak	2" CAL.	B&B	
PERENNIALS (BID ALTERNATE)						
QTY	SYM	SCIENTIFIC NAME	COMMON NAME	SIZE	COMMENTS	
60	CL	<i>Carex lurida</i>	Bottlebrush Sedge	NO. 1 CONT.	24" SPACING	
40	CV	<i>Carex vulpinoidea</i>	Pow Sedge	NO. 1 CONT.	24" SPACING	
74	IR	<i>Iris sibirica</i> 'Caesar's Brother'	'Caesar's Brother' Siberian Iris	NO. 2 CONT.	24" SPACING	
130	LS	<i>Liatris spicata</i>	Blazing Star	NO. 2 CONT.	18" SPACING	
165	RB	<i>Rudbeckia fulgida</i> var. <i>sullivantii</i> 'Goldsturm'	'Goldsturm' Black-eyed Susan	NO. 2 CONT.	18" SPACING	

LEGEND

	LAWN SEEDING
	ODOT 659 CLASS 1
	OVERSEED WITH TEMPORARY EROSION CONTROL MIXTURE
	ODOT 659 CLASS 7

Project Management Initials: _____ Designer: _____ Checked: _____ Approved: _____
 ANS I D 22' x 34'
 Last saved by: CHRISTA.RADOSAVLJEVI(2019-02-20) Last Plotted: 2019-02-28
 Filename: G:\CLEVELAND\DCS\PROJECTS\BOL\60578006_FAIRPARTNERS\CAD_GIS\910_CAD\20-SHEET\200_PLANTING PLANDWG

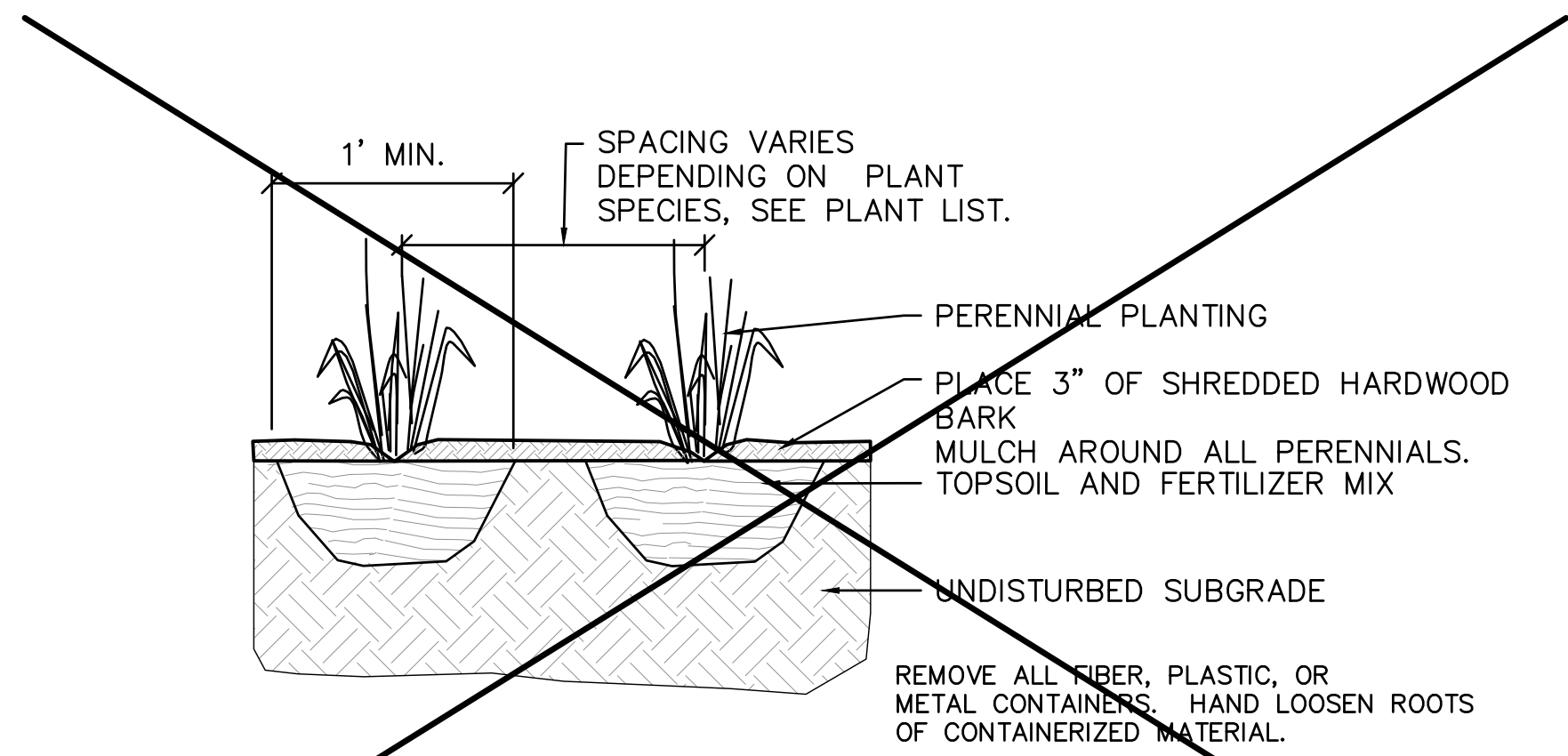

1 PERENNIAL PLANTING (BID ALTERNATE) NOT IN CONTRACT
SCALE: NTS

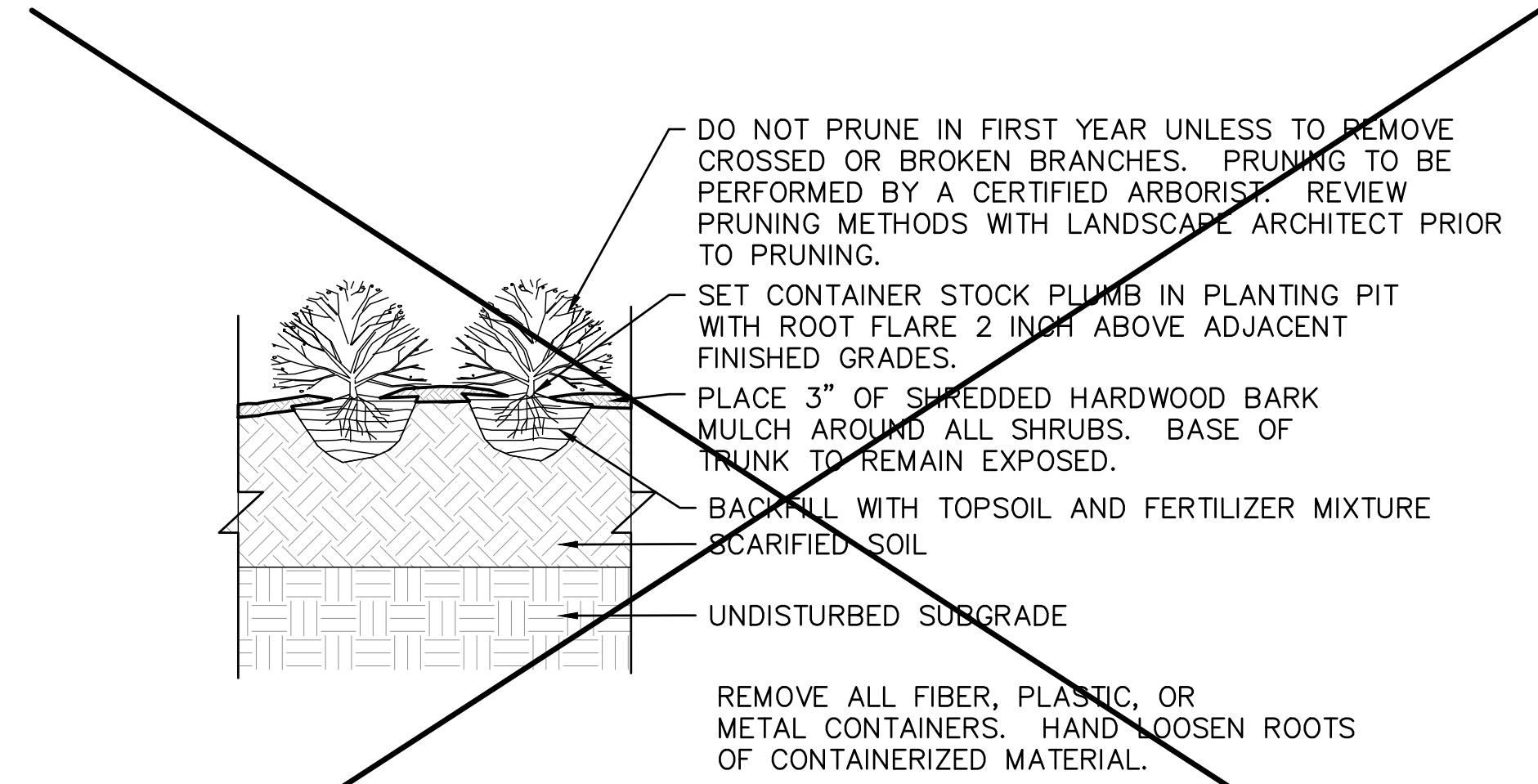

2 SHRUB PLANTING NOT IN CONTRACT
SCALE: NTS

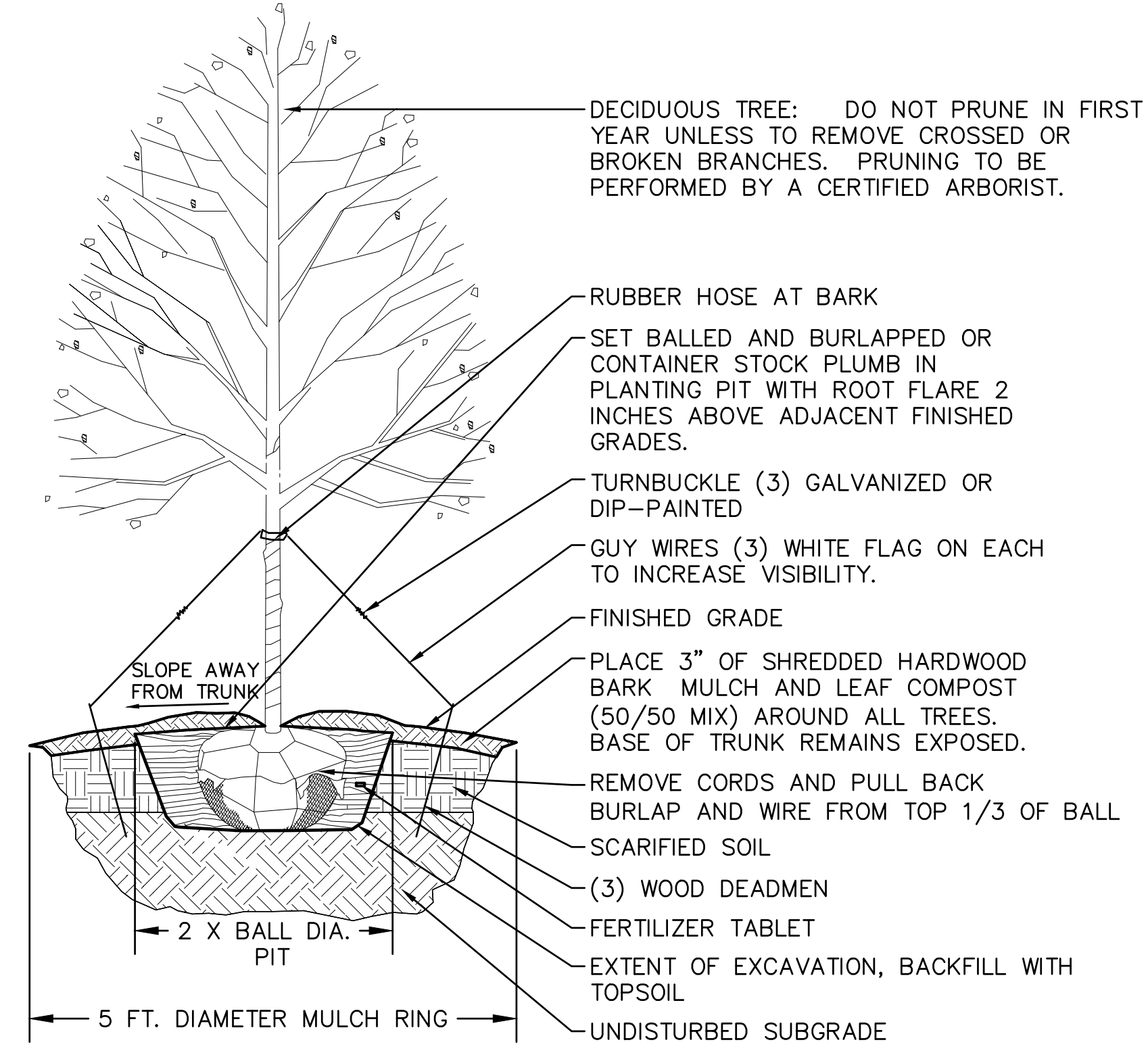

3 DECIDUOUS TREE PLANTING
SCALE: NTS

ISSUE/REVISION

I/R	DATE	DESCRIPTION
1	7/5/2018	60% REVIEW SET
2	7/17/2018	90% REVIEW SET
3	8/02/2018	100% REVIEW SET
4	8/13/2018	100% BID SET
5	2/21/2019	ISSUED FOR CONSTRUCTION