















**SWPPP LEGEND**

- PERIMETER CONTROL: 3x3 GRID ON CONCRETE FLOOR FLOOR SOCS
- CONSTRUCTION LIMITS
- MELT PROTECTION
- CONSTRUCTION DRAINAGE
- CONCRETE WASHOUT
- VEHICLE FILING
- TEMPORARY STABILIZATION\*
- PERMANENT STABILIZATION\*

\* SEEING AREAS INDICATED ON PLANS ARE TEMPORARY ONLY. CONTRACTOR SHALL APPLY PERMANENT AND TEMPORARY STABILIZATION AS PER THE NOTES ON SHEET C7.2 IMMEDIATELY UPON PROTECT.

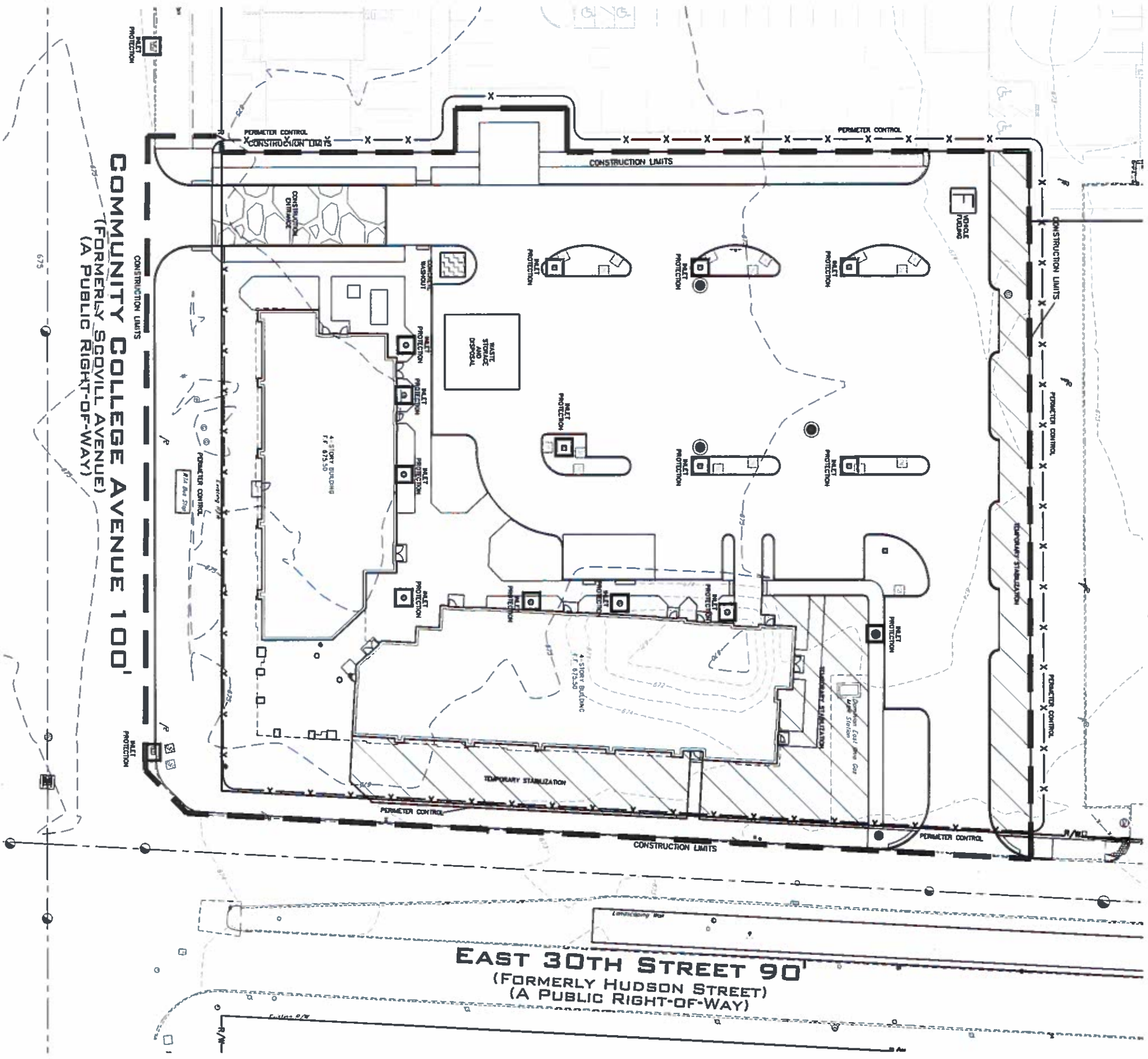

**EAST 30TH STREET 90'**  
(FORMERLY HUDSON STREET)  
(A PUBLIC RIGHT-OF-WAY)

**COMMUNITY COLLEGE AVENUE 100'**  
(FORMERLY SCOVILL AVENUE)  
(A PUBLIC RIGHT-OF-WAY)

**SWPPP NOTES:**  
CONTRACTOR SHALL MAINTAIN MEL PROTECT IN ACCORDANCE WITH THE CITY OF CLEVELAND CONSTRUCTION ORDINANCES AND THE Ohio EPA CONSTRUCTION CENTER PERMIT #PC0000004.  
REDEVELOPMENT PHASE I PROPERTY AREA 87,085 SF, 1,9992 ACRES.  
AREA WITHIN CONSTRUCTION LIMITS 100,472 SF, 2,2713 ACRES.  
LOCATION OF WASTE STORAGE AND DISPOSAL SHOWN ON THE PLANS SHALL BE VERIFIED BY CONTRACTOR. LOCATION MAY BE CHANGED AND THE SWPPP AUTHORIZED LOCATION OF WASTE FILING SHOWN ON THE PLANS SHALL BE VERIFIED BY THE CONTRACTOR. CONTRACTOR SHALL MAINTAIN MEL PROTECT THROUGHOUT CONSTRUCTION. CONTRACTOR SHALL MAINTAIN MEL PROTECT THROUGHOUT CONSTRUCTION. CONTRACTOR SHALL MAINTAIN MEL PROTECT THROUGHOUT CONSTRUCTION.  
A COPY OF THE SWPPP AND ALL ADDENDUMS TO THE SWPPP SHALL BE KEPT ON THE SITE.  
ALL EROSION AND SEDIMENT CONTROL MEASURES SHALL BE INSTALLED AS PER THE SWPPP. CONTRACTOR SHALL MAINTAIN ALL EROSION AND SEDIMENT CONTROL MEASURES THROUGHOUT CONSTRUCTION.  
EROSION CONTROL BARRIERS WITH WARNING SHALL BE USED ON SLOPES GREATER THAN 5%.  
ONCE THE SITE HAS BEEN STABILIZED AND PROPER AUTHORIZATION HAS BEEN OBTAINED, CONSTRUCTION BARRIERS MAY BE REMOVED.

- CONSTRUCTION SCHEDULE**
1. INSTALL TEMPORARY STORM CONSTRUCTION ENTRANCE
  2. INSTALL PERIMETER CONTROL
  3. CLEAR AND GRUB WITHIN CONSTRUCTION LIMITS
  4. MASS GRADE
  5. INSTALL GEMENT IN/OUT WASHOUT AREA
  6. INSTALL BUILDING FOUNDATION
  7. INSTALL CONCRETE FOUNDATION
  8. INSTALL CONCRETE FOUNDATION
  9. INSTALL CONCRETE FOUNDATION
  10. INSTALL SUPERVIATION CELLS
  11. FINAL GRADE
  12. LANDSCAPE AND APPLY PERMANENT STABILIZATION AS PER THE SWPPP.
  13. AFTER PROPER AUTHORIZATION HAS BEEN OBTAINED FROM THE CITY ENGINEER, REMOVE EROSION AND/OR SEDIMENT BARRIERS.



**CEDAR EXTENSION REDEVELOPMENT PHASE I**

CUYAHOGA METROPOLITAN HOUSING AUTHORITY  
EAST 30TH STREET CLEVELAND, OHIO

**SWPPP CONSTRUCTION**

**RIVERSTONE**  
Cityarchitecte  
3428 Euclid Avenue  
Suite 500 Cleveland, Ohio 44115  
Phone 216.861.2444  
Fax 216.861.8712  
www.cityarch.com

Project No. **02913**  
Revision Project 1336  
Sheet Number

**C7.2**  
Copyright © 2015











