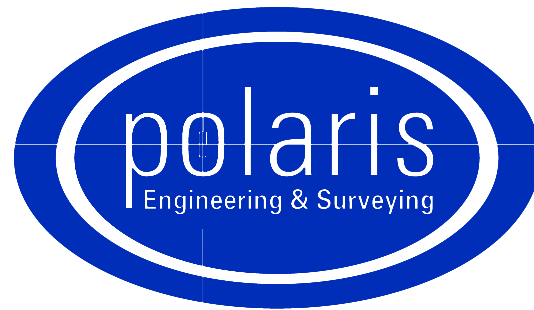

# IMPROVEMENT PLANS FOR FAMILY MINISTRIES CENTER 3389 FULTON ROAD

CITY OF CLEVELAND - CUYAHOGA COUNTY - OHIO

NOVEMBER 17, 2016

**DESIGNED BY:**

	<p><b>POLARIS ENGINEERING &amp; SURVEYING, INC.</b> 34600 CHARDON ROAD - SUITE D WILLOUGHBY HILLS, OHIO 44094 (440) 944-4433 (440) 944-3722 (Fax) www.polaris-es.com</p>
---	--

**DEVELOPED BY:**

**FAMILY MINISTRY CENTER  
3389 FULTON ROAD  
CLEVELAND, OHIO 44109  
PHONE: (216) 398-8420  
CONTACT: JULIE BUSCH JONES**

**DRAWING INDEX**

DESCRIPTION	SHEET NO.
TITLE SHEET	1
TOPOGRAPHIC SURVEY	2
OVERALL EXHIBIT	3
SITE EXHIBIT	4
DEMOLITION PLAN	5
EXISTING PARKING	6
PROPOSED PARKING	7
UTILITY	8
CROSS-SECTIONS & DETAILS	9-11
PROPOSED GRADING	12

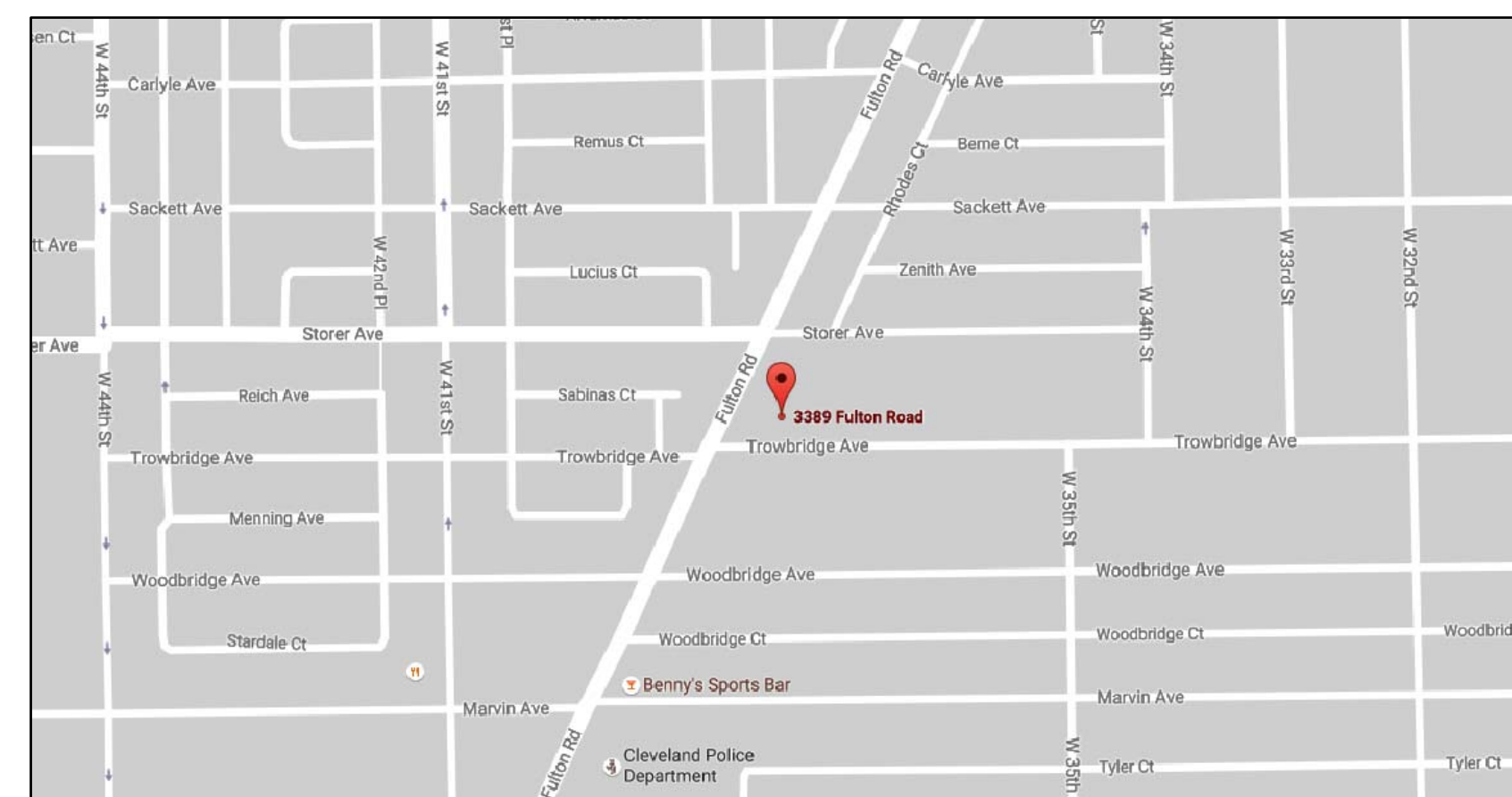

**VICINITY MAP**  
N.T.S.

TITLE SHEET



*Kevin T. Hoffman*  
KEVIN HOFFMAN P.E. #74831

CONTRACT No.	
15225	
SHEET	OF
01	12



SYMBOL LEGEND	
⊙	Ex. Clean Out
⊠	Ex. Catch Basin
■	Prop. Catch Basin
▬	Ex. Curb Inlet
▬	Prop. Curb Inlet
○	Ex. Yard Drain
○	Ex. Manhole
○	Ex. Sanitary Manhole
○	Prop. Sanitary Manhole
○	Ex. Storm Manhole
○	Prop. Storm Manhole
⊕	Storm Inlet MH
W	Ex. Water Valve
⊗	Prop. WL Valve
W	Water Meter
⊕	Ex. Fire Hydrant
⊕	Prop. Hydrant
⊕	Well
⊕	Gas Valve
⊕	Gas Meter
MB	Mailbox
⊕	Guy Wire
⊕	Power Pole
⊕	Light Power Pole
⊕	Light Pole
⊕	Traffic Signal Pole
⊕	Traffic Signal Box
⊕	Cable TV Box
⊕	Electrical Box
⊕	Telephone (SAC) Box
⊕	Tree
⊕	Pine Tree
⊕	Bush
⊕	Yard Light
⊕	Gasline Marker
⊕	Power Transformer
⊕	SCB Sprinkler Control Box
⊕	SH Sprinkler Head
⊕	Sign
⊕	Test Bore
⊕	Guard Post

**TOPOGRAPHIC CERTIFICATION:**  
 I, THE UNDERSIGNED, HEREBY CERTIFY THAT THIS TOPOGRAPHY, INDICATED BY 1' CONTOURS, AND ELEVATIONS SHOWN HEREON, REPRESENT AN ACTUAL FIELD SURVEY MADE UNDER MY SUPERVISION ON THE 21ST DAY OF SEPTEMBER, 2015, AND THAT THE ELEVATIONS WERE TAKEN AT APPROPRIATE INTERVALS AND THAT AS OF THAT DATE THEY EXISTED AS INDICATED HEREON. VERTICAL DATUM IS BASED ON NAVD88.

*Richard A. Thompson, Jr.*  
 RICHARD A. THOMPSON, JR., P.S. #7388  



2 WORKING DAYS BEFORE YOU DIG CALL 8-1-1  
 OHIO UTILITIES PROTECTION SERVICE NON-MEMBERS MUST BE CALLED DIRECT  
 O.U.P.S. REFERENCE  
 A-526-401-908 -924 and 940

**EXISTING UNDERGROUND UTILITIES NOTE:**  
 THE SIZE AND LOCATION, BOTH HORIZONTAL AND VERTICAL OF THE UNDERGROUND UTILITIES SHOWN HEREON, HAVE BEEN OBTAINED BY A SEARCH OF AVAILABLE RECORDS. THE EXACT LOCATION OF UNDERGROUND FEATURES CANNOT BE ACCURATELY, COMPLETELY, AND RELIABLY DEPICTED HEREON. VERIFICATION BY FIELD OBSERVATION HAS BEEN CONDUCTED, WHERE PRACTICAL. HOWEVER, POLARIS ENGINEERING & SURVEYING, INC. DOES NOT GUARANTEE THE COMPLETENESS NOR ACCURACY THEREOF.

NOTE: THIS SURVEY SUBJECT TO CHANGE UPON RECEIPT OF ANY ADDITIONAL AVAILABLE UNDERGROUND UTILITY INFORMATION.

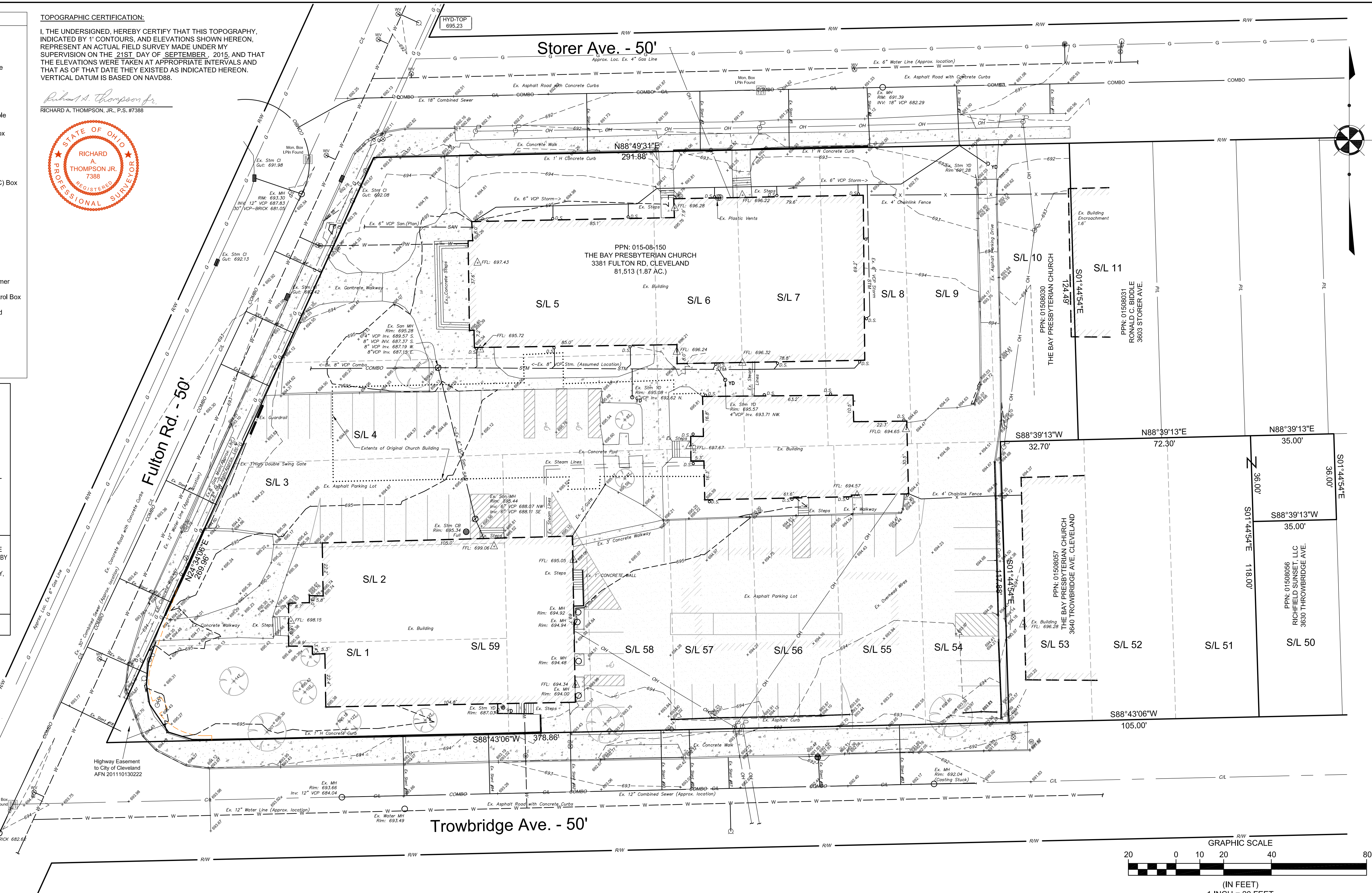

REV. No.	DATE	BY

DATE:	11/17/16
SCALE: HOR.	1"=20'
VERT.	N/A
FOLDER:	Survey
FILENAME:	Survey Base
TAB:	02-Topographic
DRAWN:	RMK

**Family Ministries Center**  
**3389 Fulton Road**  
 CLEVELAND - CUYAHOGA COUNTY - OHIO

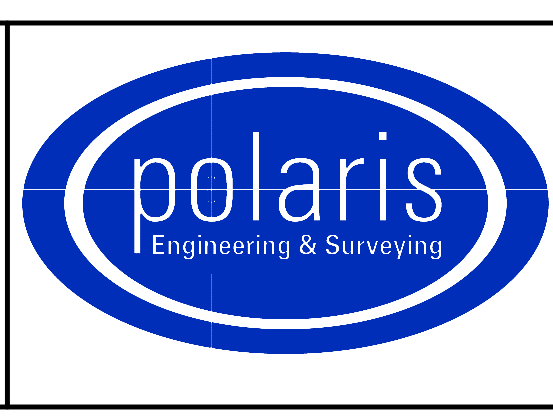

**POLARIS ENGINEERING & SURVEYING, INC.**  
 34600 CHARDON ROAD - SUITE D  
 WILLOUGHBY HILLS, OHIO 44094  
 (440) 944-4433 (440) 944-3722 (Fax)  
 www.polaris-es.com

**TOPOGRAPHIC SURVEY**

CONTRACT No.	
15225	
SHEET	OF
02	12



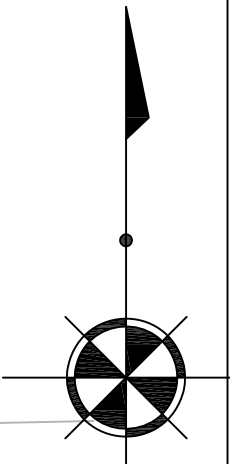
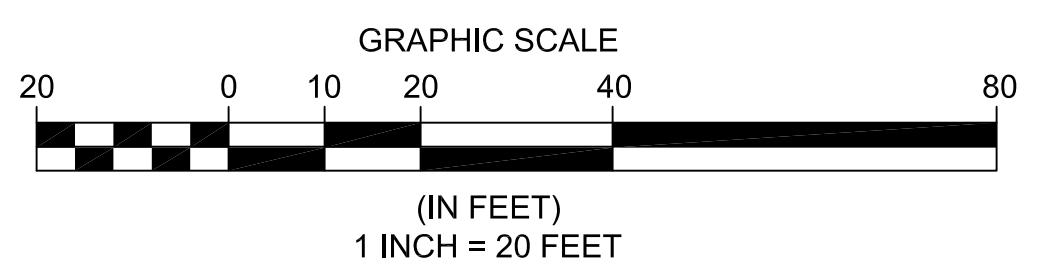

REV. No.	DATE	BY

DATE: 11/17/16  
 SCALE: HOR. 1"=20'  
 VERT. N/A  
 FOLDER: DWG/Site Plans  
 FILENAME: Site Plan  
 TAB: 03-Exhibits  
 DRAWN: KTH

**Family Ministry Center**  
 3389 Fulton Road  
 Cleveland, Ohio 44109

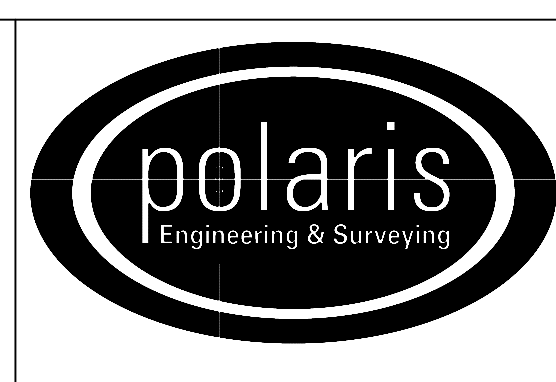

**POLARIS ENGINEERING & SURVEYING, INC.**  
 34600 CHARDON ROAD - SUITE D  
 WILLOUGHBY HILLS, OHIO 44094  
 (440) 944-4433 (440) 944-3722 (Fax)  
 www.polaris-es.com

**OVERALL EXHIBIT**

CONTRACT No.	
15225	
SHEET	OF
03	12



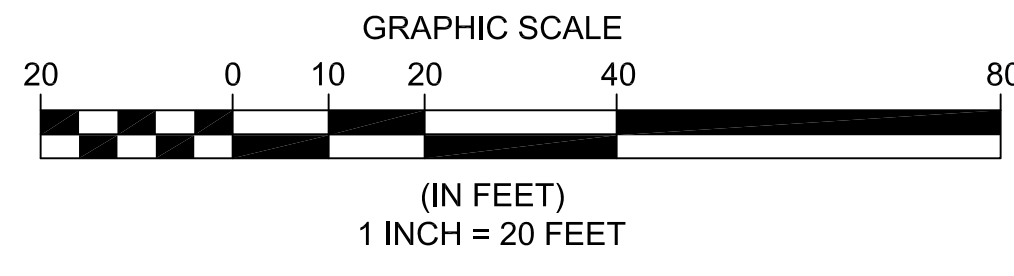
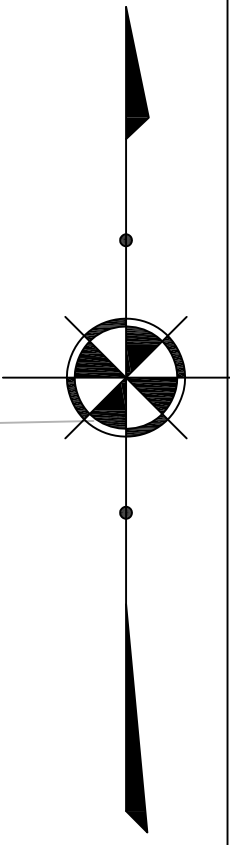
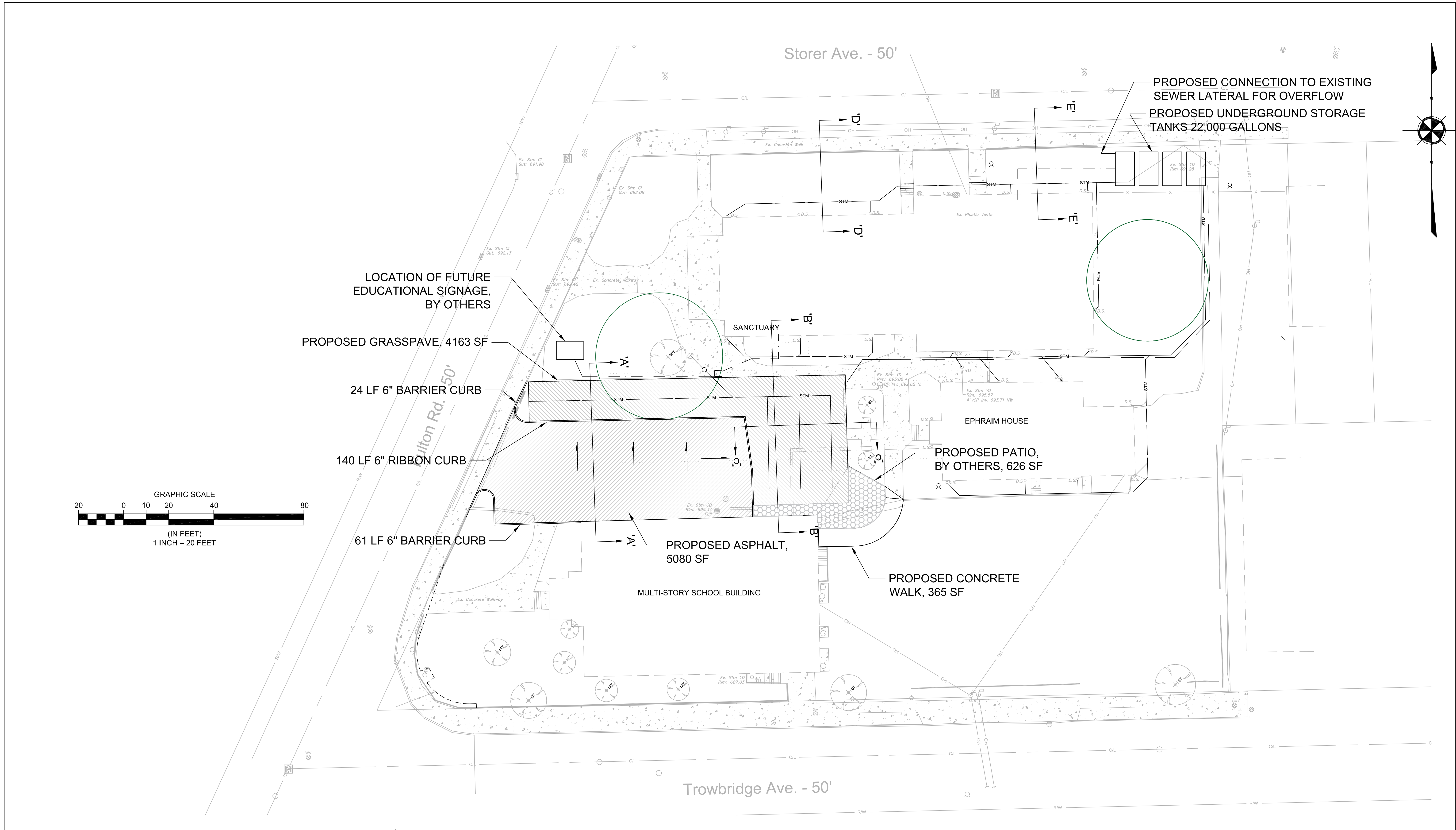

REV. No.	DATE	BY

DATE: 11/17/16  
 SCALE: HOR. 1" = 20'  
 VERT. N/A  
 FOLDER: DWG/Site Plans  
 FILENAME: Site Plan  
 TAB: 04-PR\_Site  
 DRAWN: KTH

**Family Ministry Center**  
 3389 Fulton Road  
 Cleveland, Ohio 44109

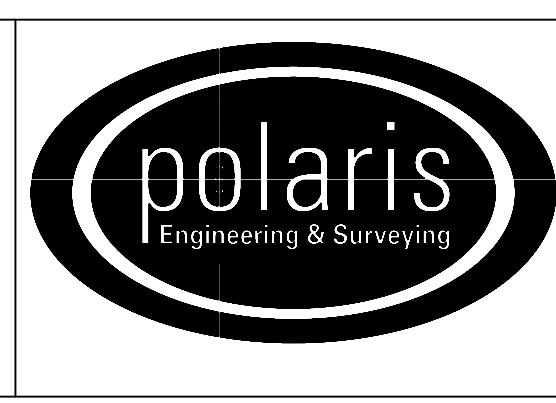

**POLARIS ENGINEERING & SURVEYING, INC.**  
 34600 CHARDON ROAD - SUITE D  
 WILLOUGHBY HILLS, OHIO 44094  
 (440) 944-4433 (440) 944-3722 (Fax)  
 www.polaris-es.com

**SITE EXHIBIT**

CONTRACT No.	
15225	
SHEET	OF
04	12



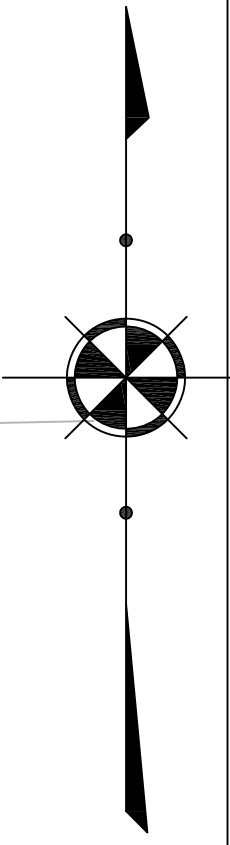
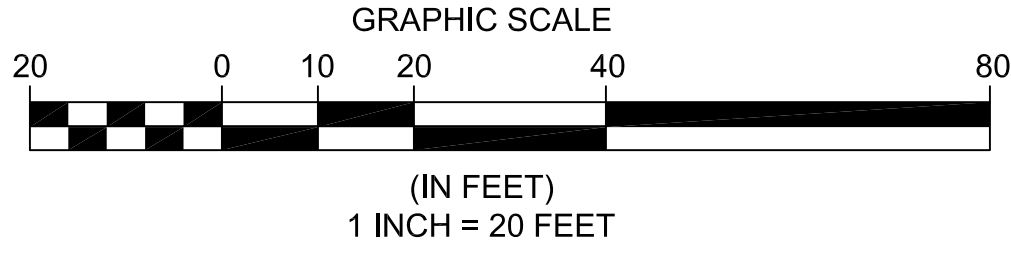
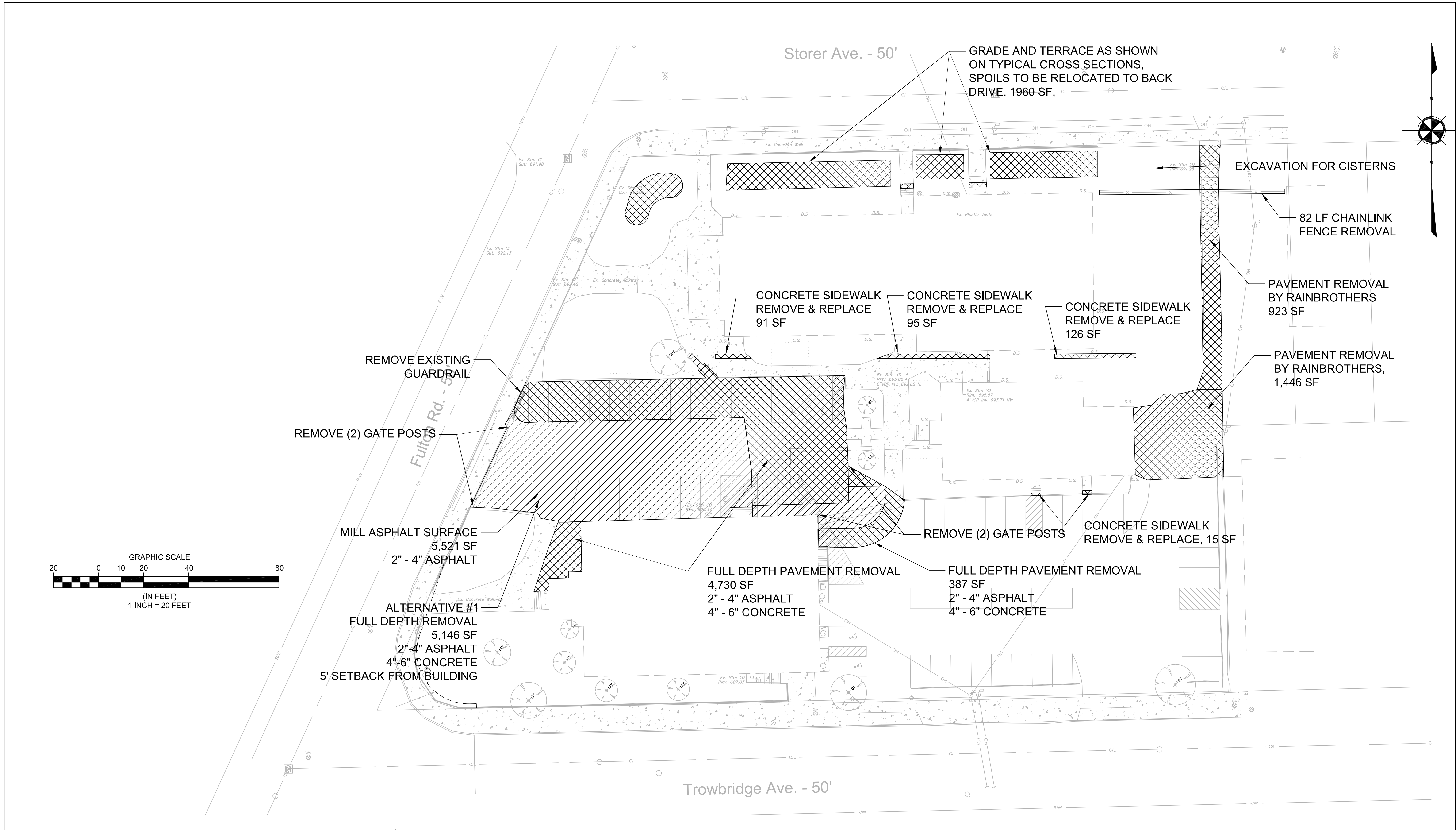

REV. No.	DATE	BY

DATE: 11/17/16  
 SCALE: HOR. 1" = 20'  
 VERT. N/A  
 FOLDER: DWG/Site Plans  
 FILENAME: Site Plan  
 TAB: 05-Removal  
 DRAWN: KTH

**Family Ministry Center**  
 3389 Fulton Road  
 Cleveland, Ohio 44109

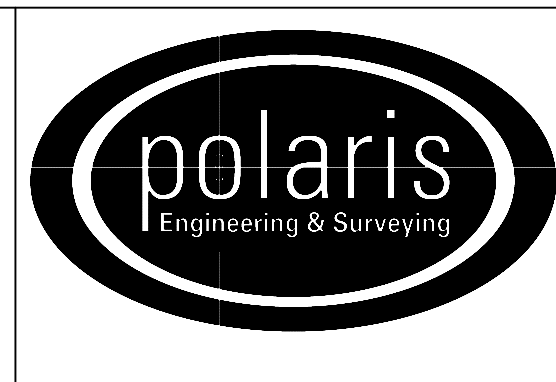

**POLARIS ENGINEERING & SURVEYING, INC.**  
 34600 CHARDON ROAD - SUITE D  
 WILLOUGHBY HILLS, OHIO 44094  
 (440) 944-4433 (440) 944-3722 (Fax)  
 www.polaris-es.com

**REMOVAL AND  
 DEMOLITION PLAN**

CONTRACT No.	
15225	
SHEET	OF
05	12



REV. No.	DATE	BY

DATE: 11/17/16  
 SCALE: HOR. 1"=10'  
 VERT. N/A  
 FOLDER: DWG/Site Plans  
 FILENAME: Site Plan  
 TAB: 06-Existing Parking  
 DRAWN: KTH

**Family Ministry Center**  
 3389 Fulton Road  
 Cleveland, Ohio 44109

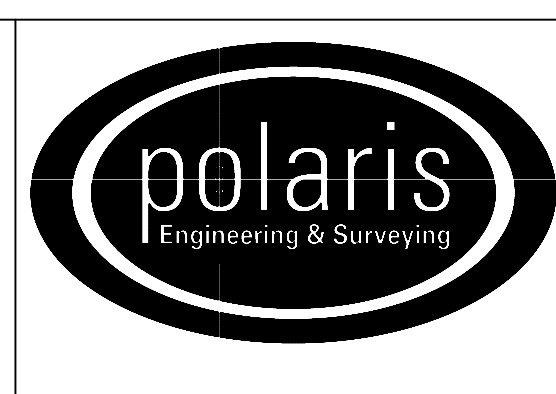

**POLARIS ENGINEERING & SURVEYING, INC.**  
 34600 CHARDON ROAD - SUITE D  
 WILLOUGHBY HILLS, OHIO 44094  
 (440) 944-4433 (440) 944-3722 (Fax)  
 www.polaris-es.com

**EXISTING PARKING EXHIBIT**

CONTRACT No.	
15225	
SHEET	OF
06	12



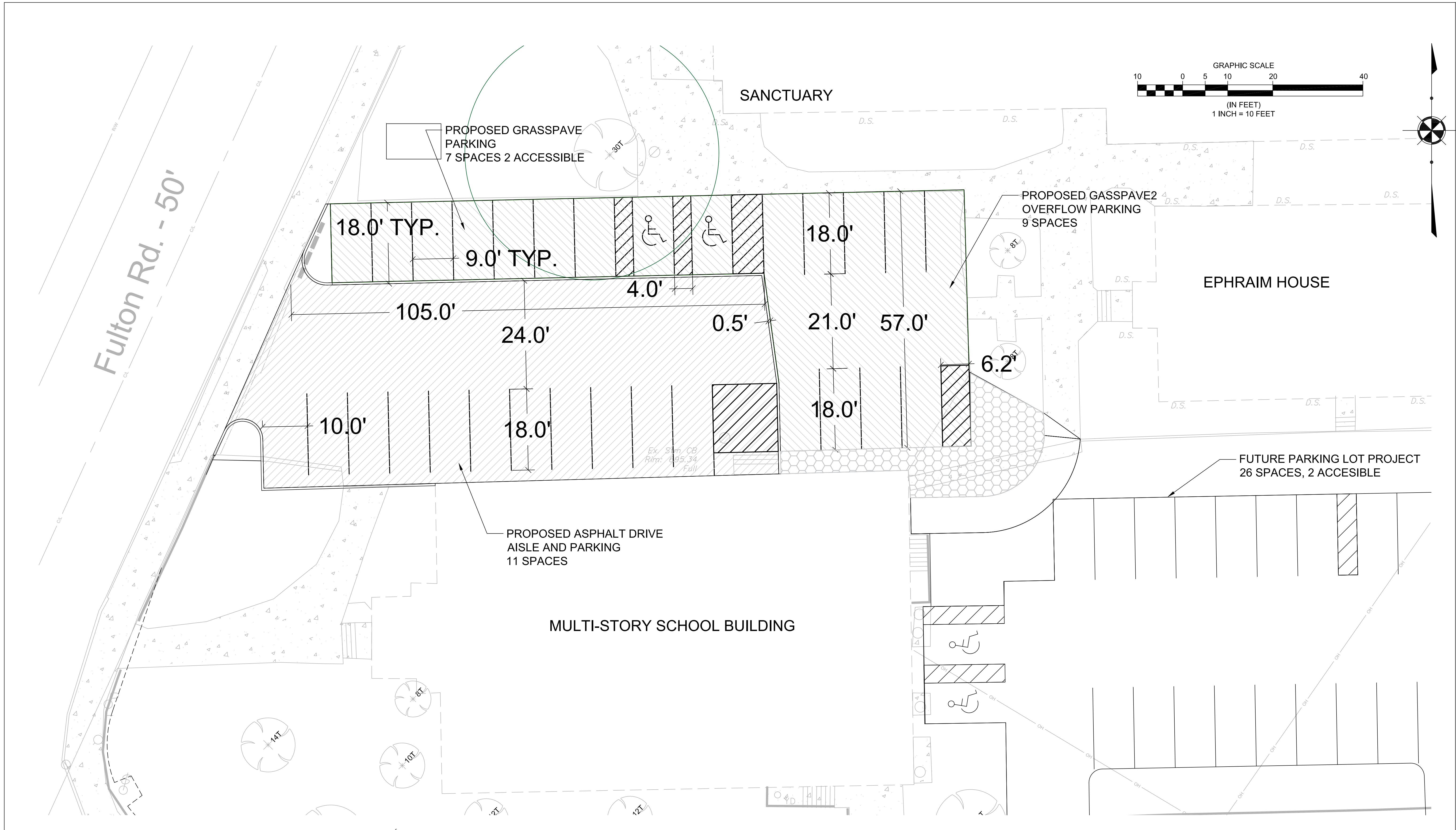

REV. No.	DATE	BY

DATE: 11/17/16  
 SCALE: HOR. 1"=10'  
 VERT. N/A  
 FOLDER: DWG/Site Plans  
 FILENAME: Site Plan  
 TAB: 07-PR Parking  
 DRAWN: KTH

**Family Ministry Center**  
 3389 Fulton Road  
 Cleveland, Ohio 44109

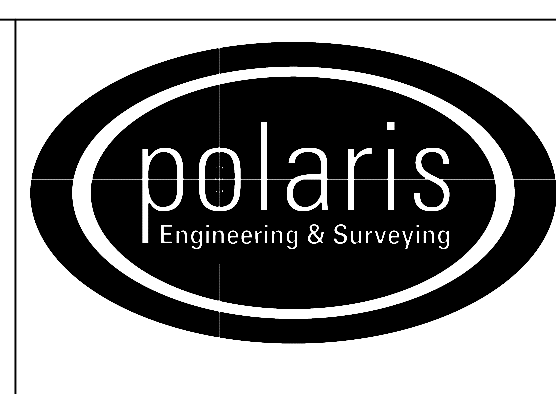

**POLARIS ENGINEERING & SURVEYING, INC.**  
 34600 CHARDON ROAD - SUITE D  
 WILLOUGHBY HILLS, OHIO 44094  
 (440) 944-4433 (440) 944-3722 (Fax)  
 www.polaris-es.com

**PROPOSED PARKING EXHIBIT**

CONTRACT No.	
15225	
SHEET	OF
07	12



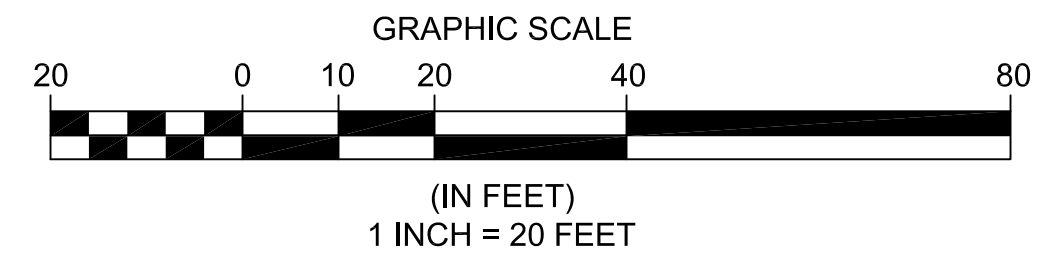
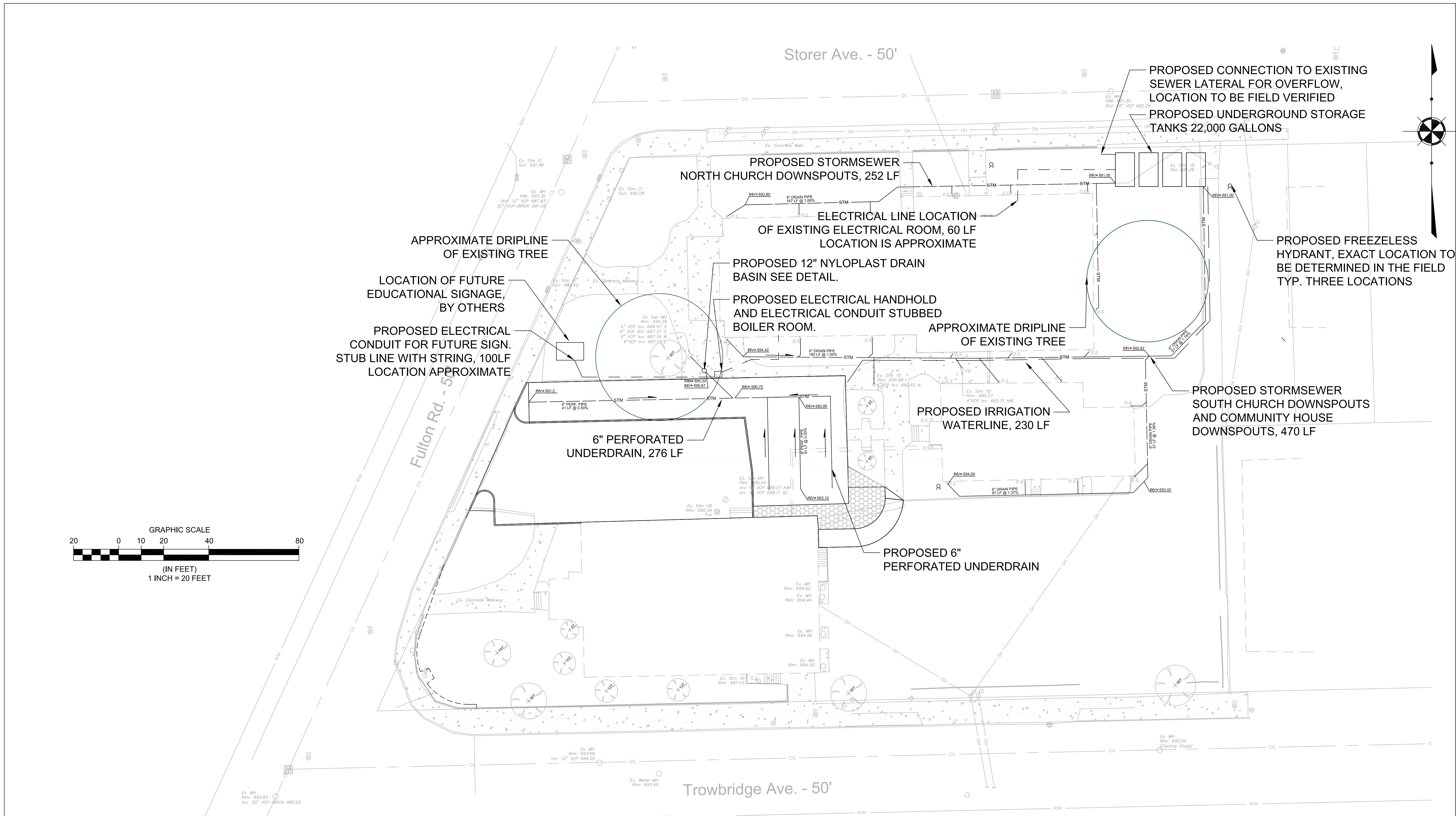

REV. No.	DATE	BY

DATE: 11/17/16  
 SCALE: HOR. 1"=20'  
 VERT. N/A  
 FOLDER: DWG/Site Plans  
 FILENAME: Site Plan  
 TAB: 08-PR Utility  
 DRAWN: KTH

**Family Ministry Center**  
 3389 Fulton Road  
 Cleveland, Ohio 44109

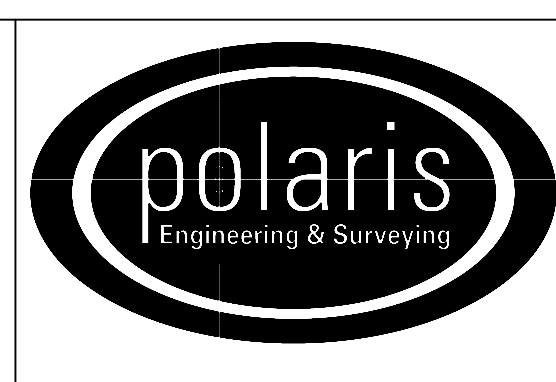

**POLARIS ENGINEERING & SURVEYING, INC.**  
 34600 CHARDON ROAD - SUITE D  
 WILLOUGHBY HILLS, OHIO 44094  
 (440) 944-4433 (440) 944-3722 (Fax)  
 www.polaris-es.com

**UTILITY**

CONTRACT No.	
15225	
SHEET	OF
08	12



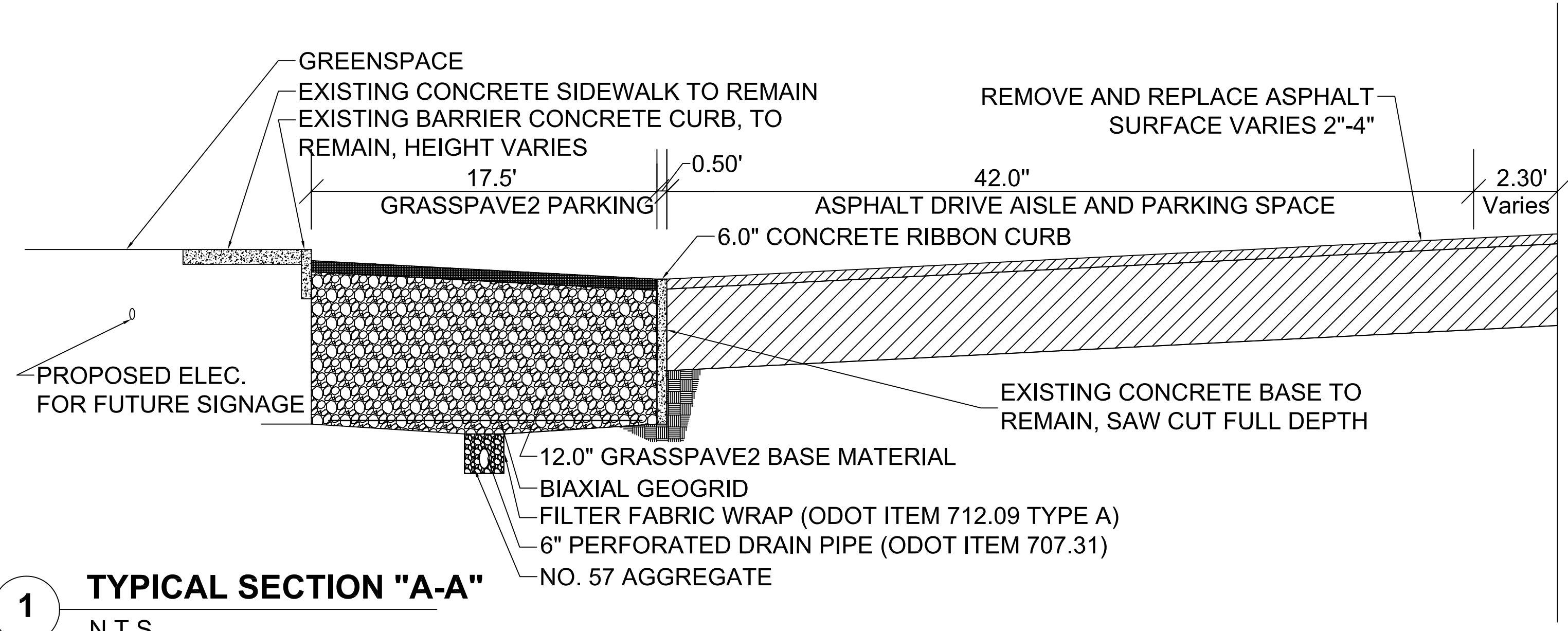

**1** TYPICAL SECTION "A-A"  
N.T.S

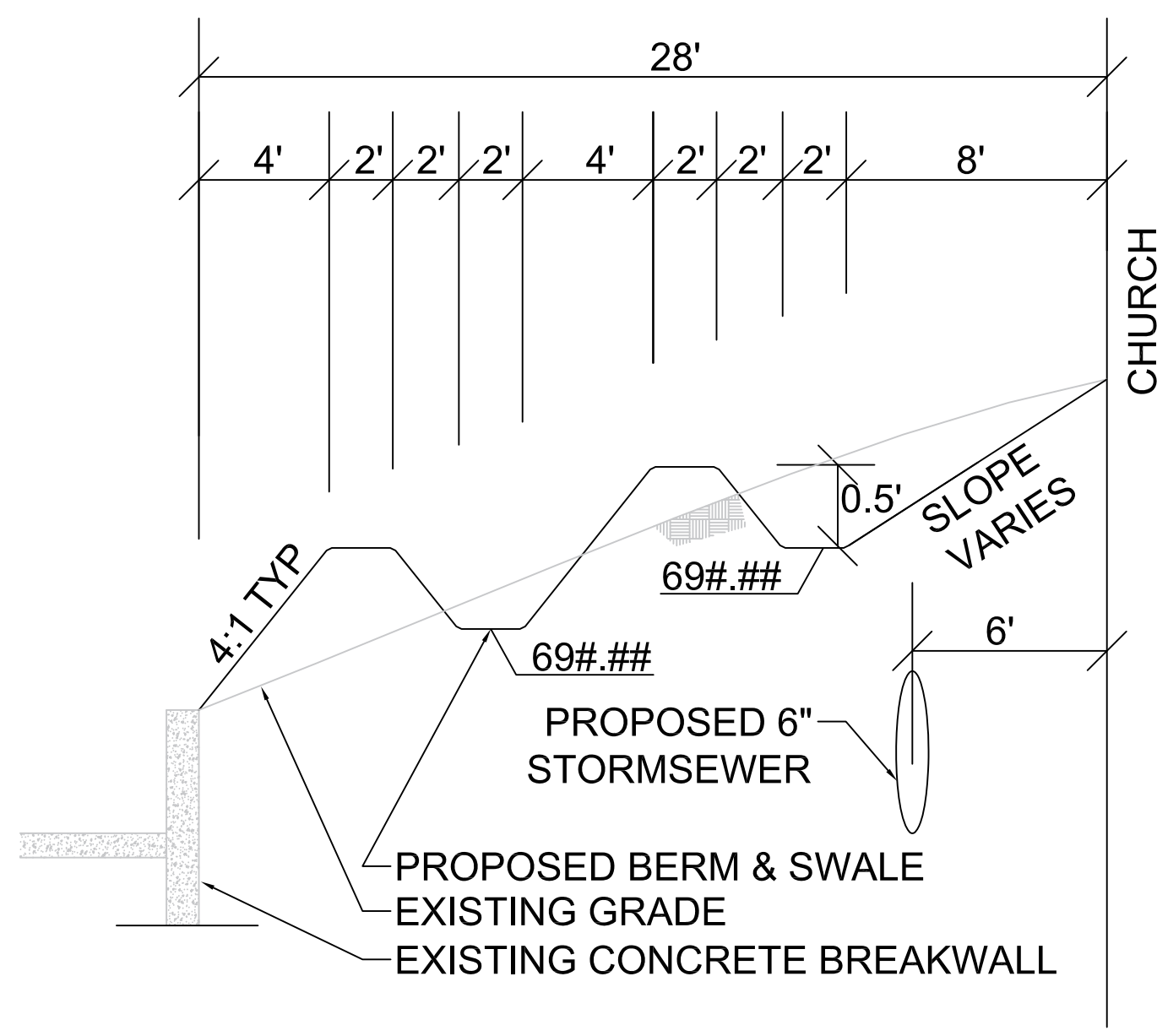

**3** Typical Section "D-D"  
N.T.S

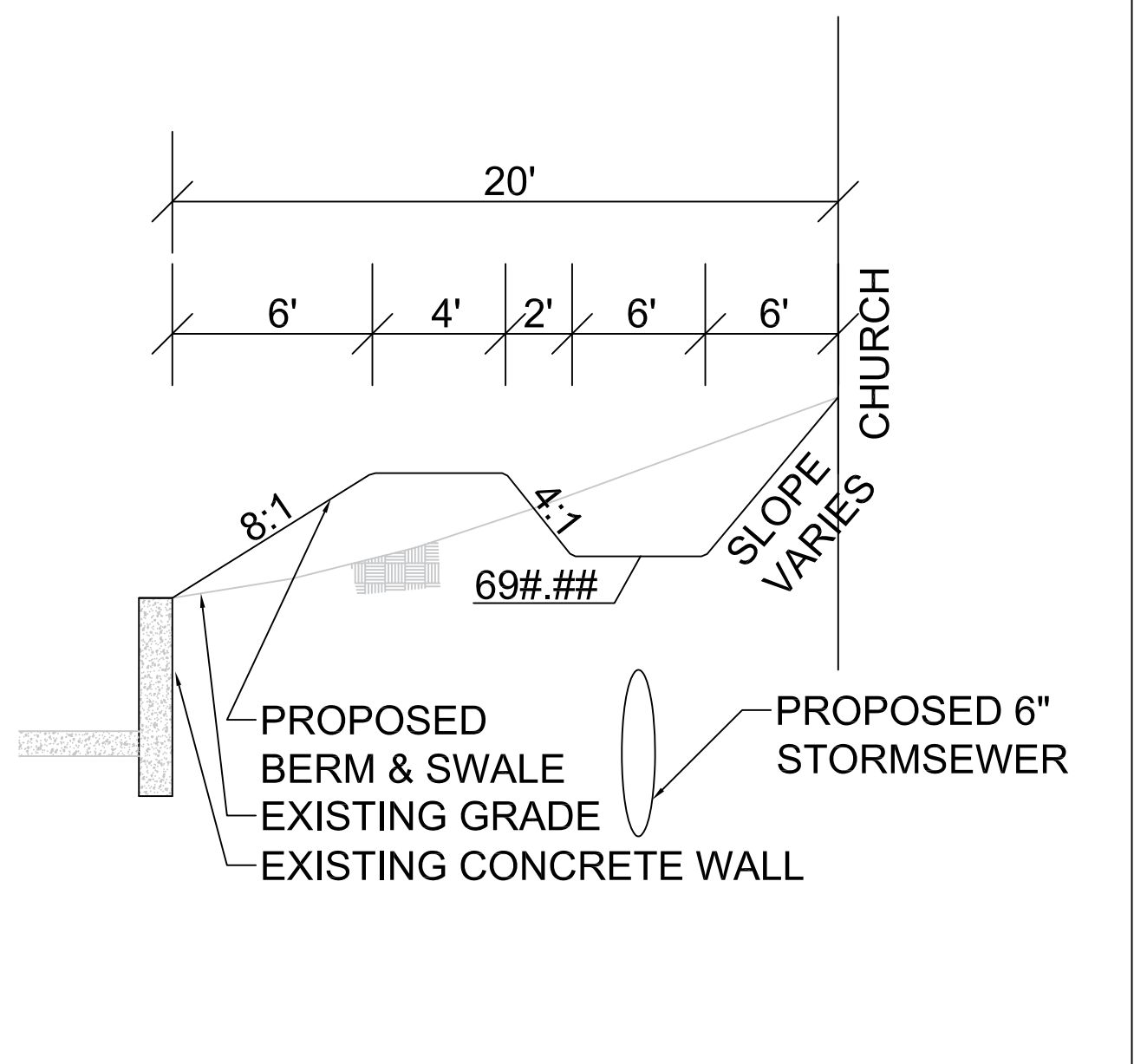

**4** Typical Section "E-E"  
N.T.S

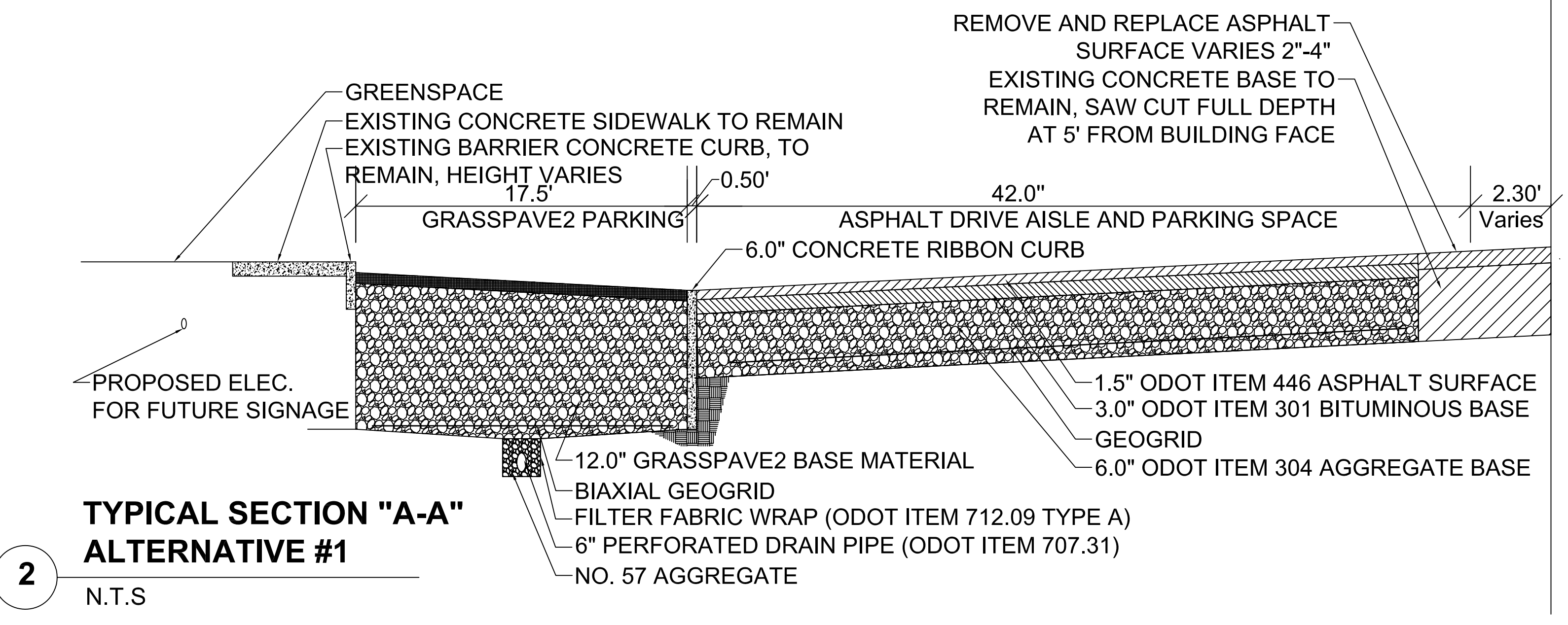

**2** TYPICAL SECTION "A-A" ALTERNATIVE #1  
N.T.S

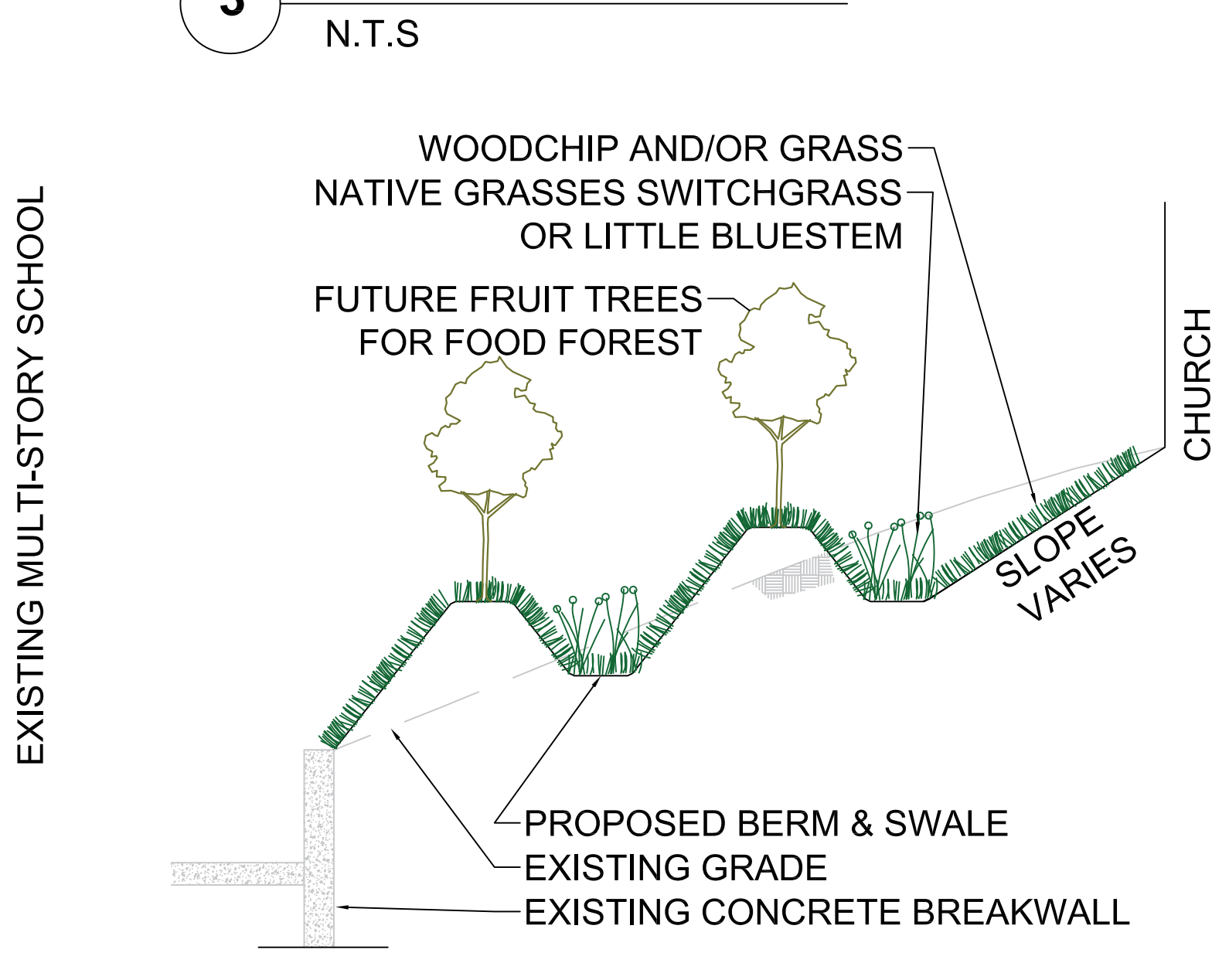

**5** RAIN GARDEN/FOOD FOREST VEGETATION  
N.T.S

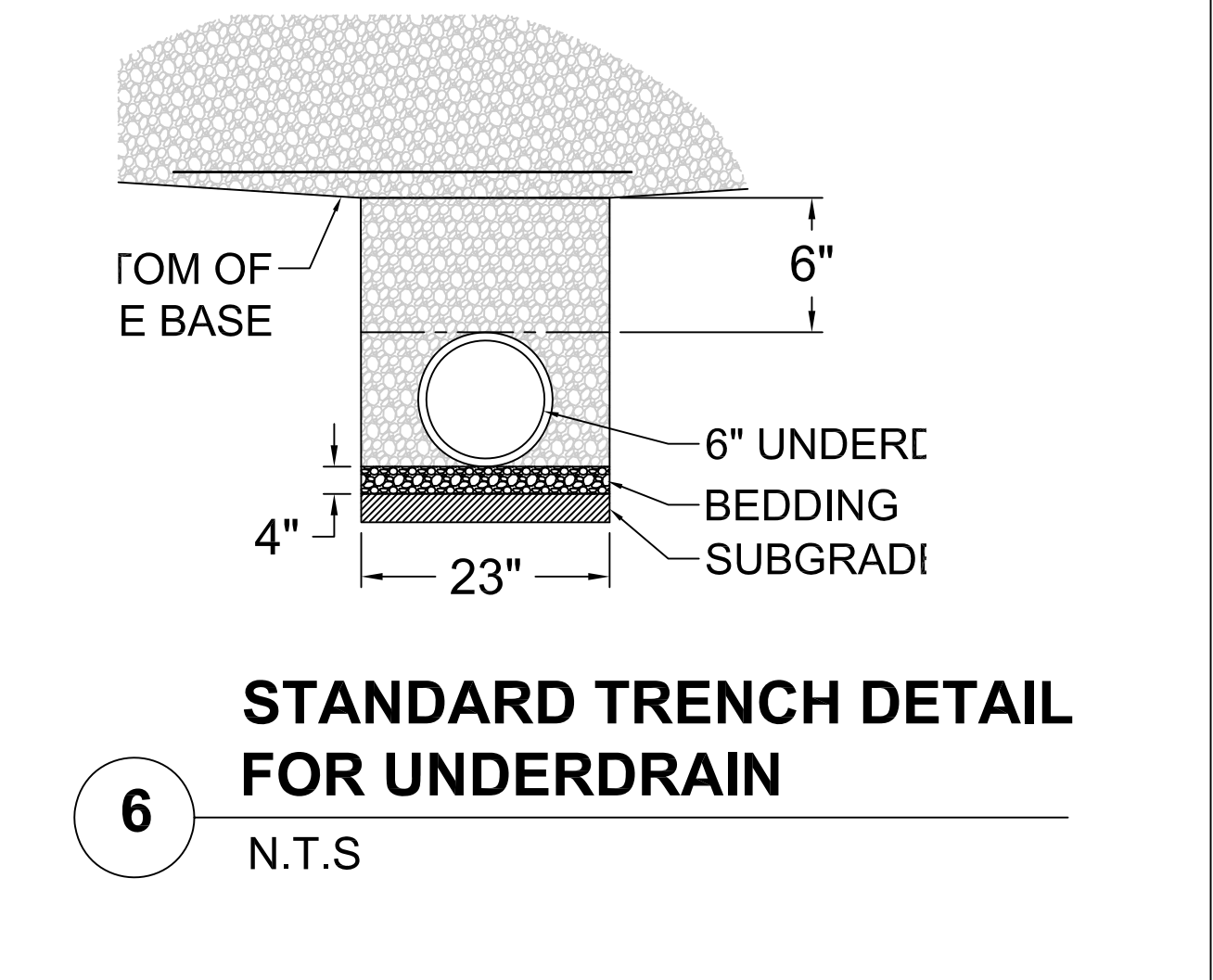

**6** STANDARD TRENCH DETAIL FOR UNDERDRAIN  
N.T.S

REV. No.	DATE	BY	DATE: 11/17/16
			SCALE: HOR. 1"=20'
			VERT. N/A
			FOLDER: DWG/Site Plans
			FILENAME: Site Plan
			TAB: 09-PR TypDet
			DRAWN: KTH

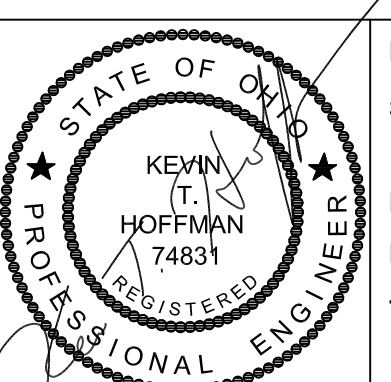

**Family Ministry Center**  
3389 Fulton Road  
Cleveland, Ohio 44109

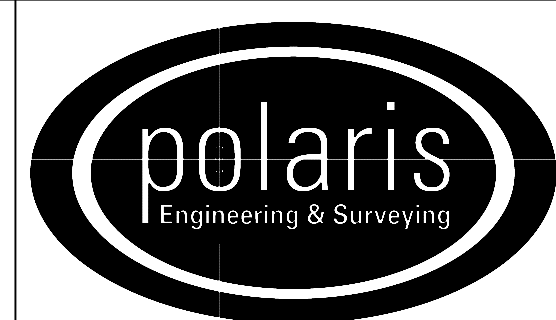

POLARIS ENGINEERING & SURVEYING, INC.  
34600 CHARDON ROAD - SUITE D  
WILLOUGHBY HILLS, OHIO 44094  
(440) 944-4433 (440) 944-3722 (Fax)  
www.polaris-es.com

**TYPICAL CROSS-SECTIONS AND DETAILS**

CONTRACT No.	
15225	
SHEET	OF
09	12



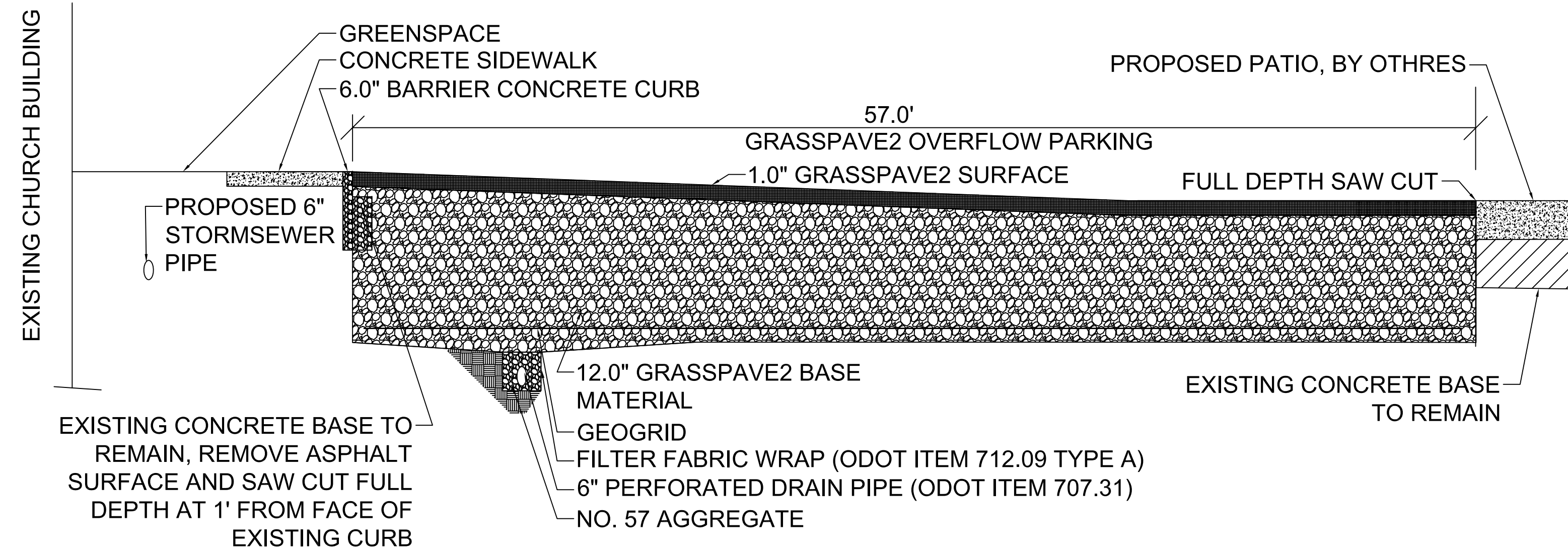

EXISTING MULTI-STORY SCHOOL

**7 Typical Section "B-B"**  
N.T.S

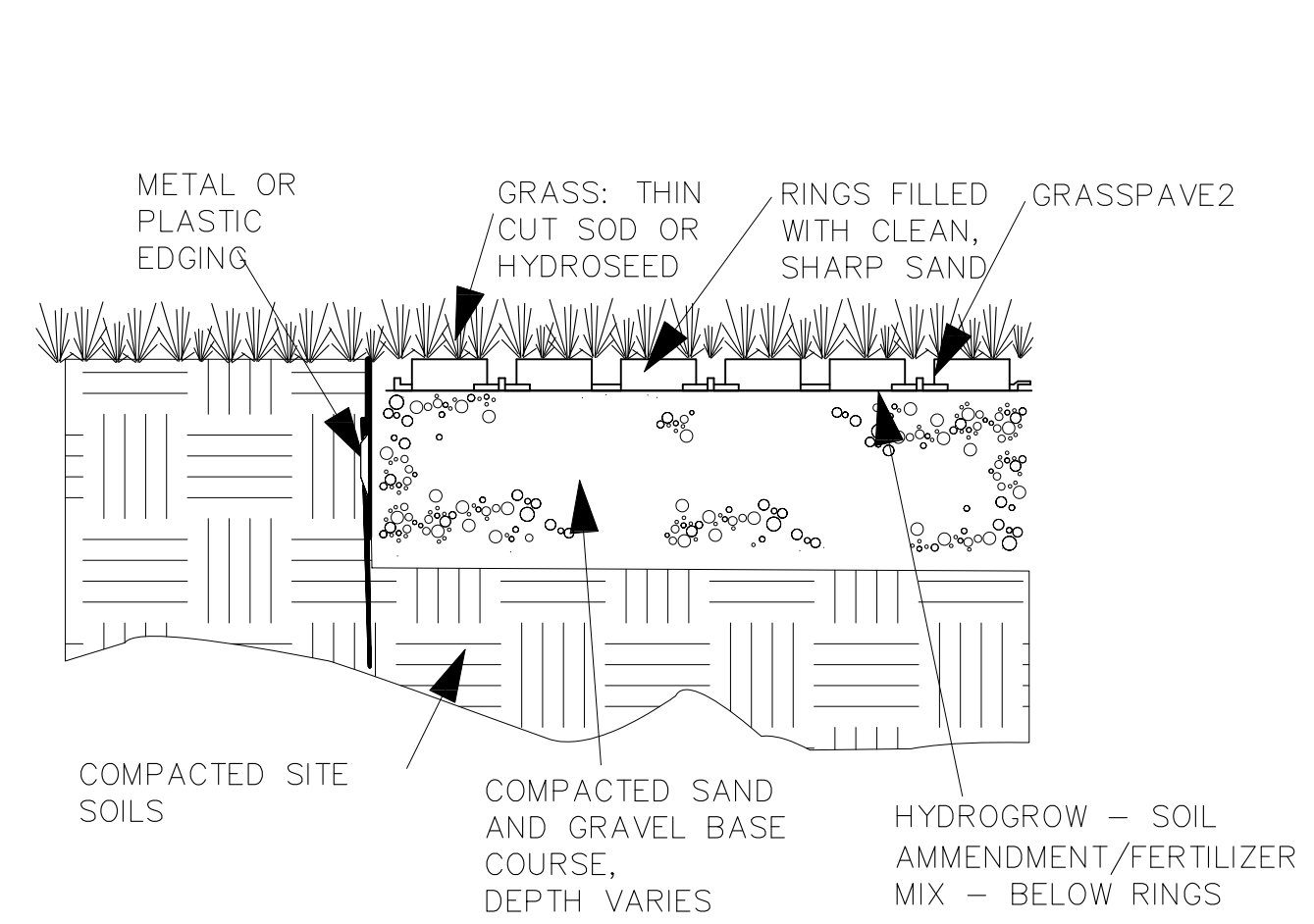

**8 GRASSPAVE LAWN EDGING**  
N.T.S

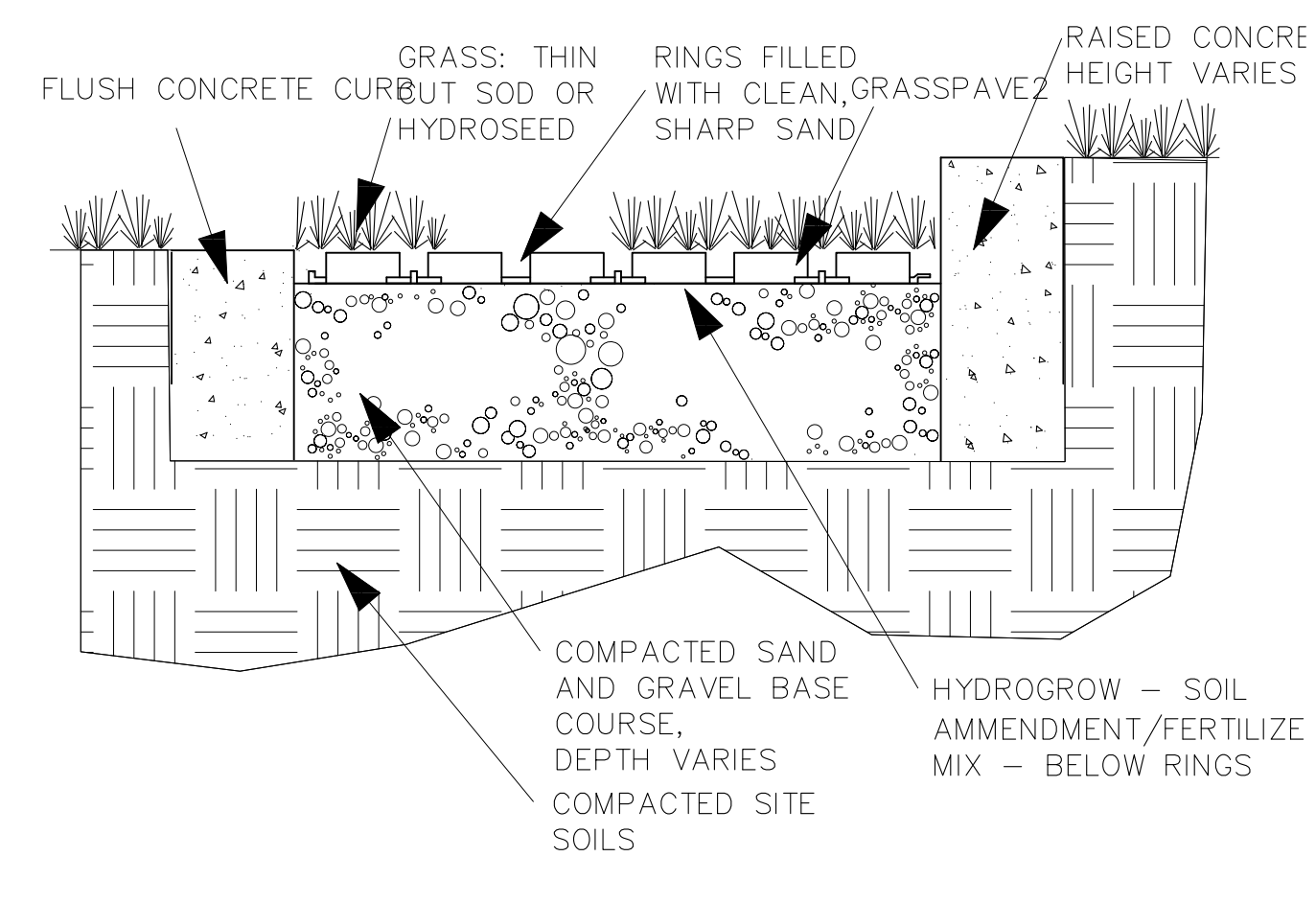

**9 GRASSPAVE CURB EDGING**  
N.T.S

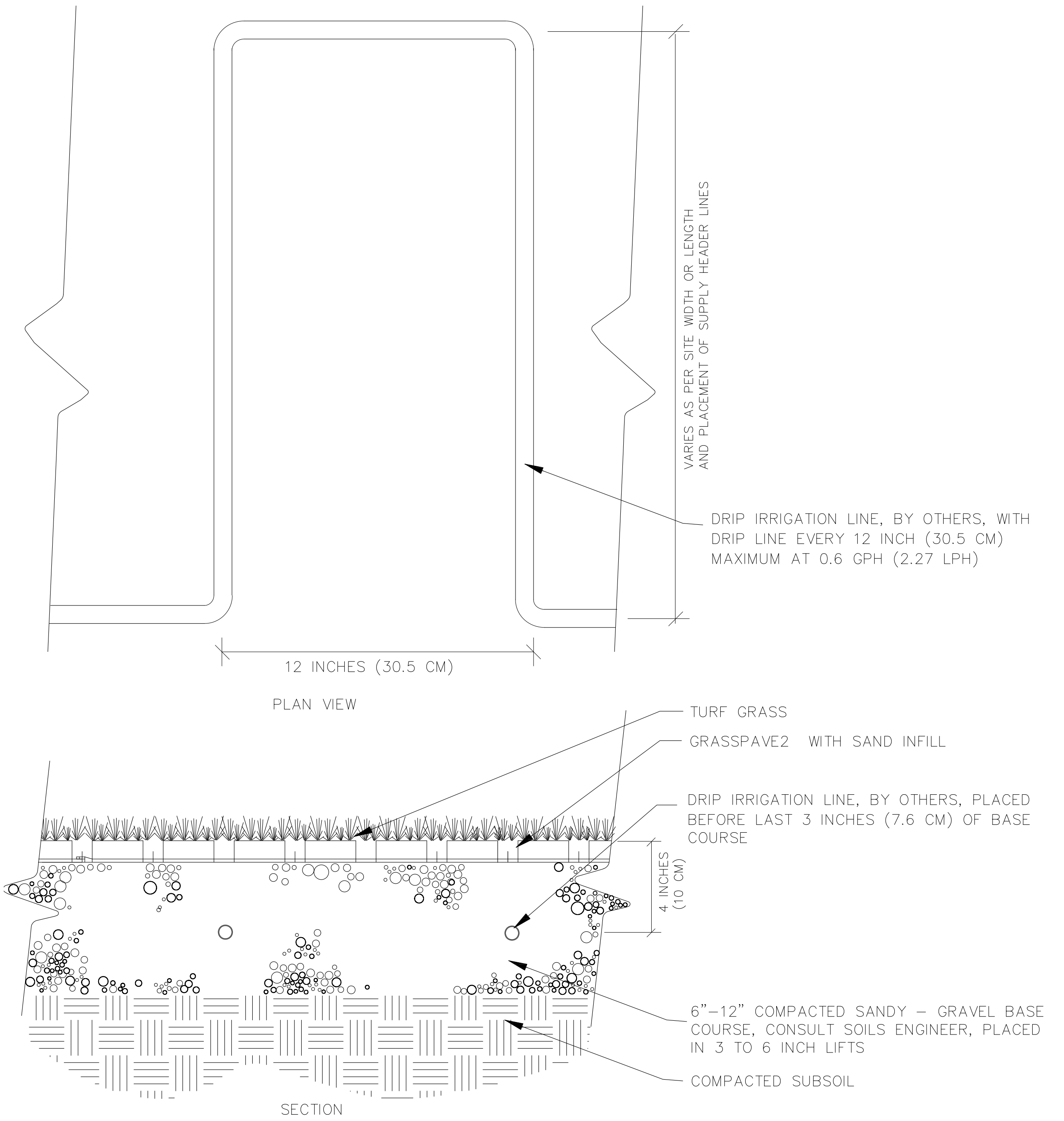

NOTE: GRASS/PLANT TYPES SHALL BE SPECIFIED BY A LANDSCAPE ARCHITECT OR LANDSCAPE DESIGNER.

**10 GRASSPAVE IRRIGATION DETAIL**  
N.T.S

REV. No.	DATE	BY

DATE: 11/17/16  
 SCALE: HOR. 1"=20'  
 VERT. N/A  
 FOLDER: DWG/Site Plans  
 FILENAME: Site Plan  
 TAB: 10-PR\_TypDet2  
 DRAWN: KTH

**Family Ministry Center**  
 3389 Fulton Road  
 Cleveland, Ohio 44109

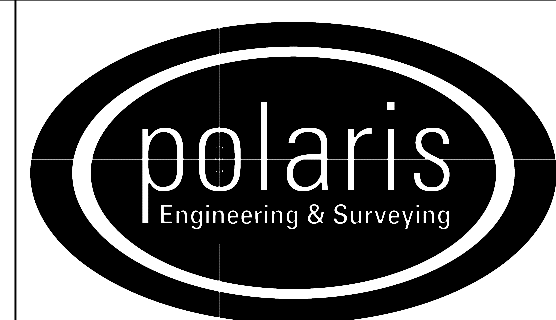

**POLARIS ENGINEERING & SURVEYING, INC.**  
 34600 CHARDON ROAD - SUITE D  
 WILLOUGHBY HILLS, OHIO 44094  
 (440) 944-4433 (440) 944-3722 (Fax)  
 www.polaris-es.com

**TYPICAL CROSS-SECTIONS AND DETAILS**

CONTRACT No.	
15225	
SHEET	OF
10	12



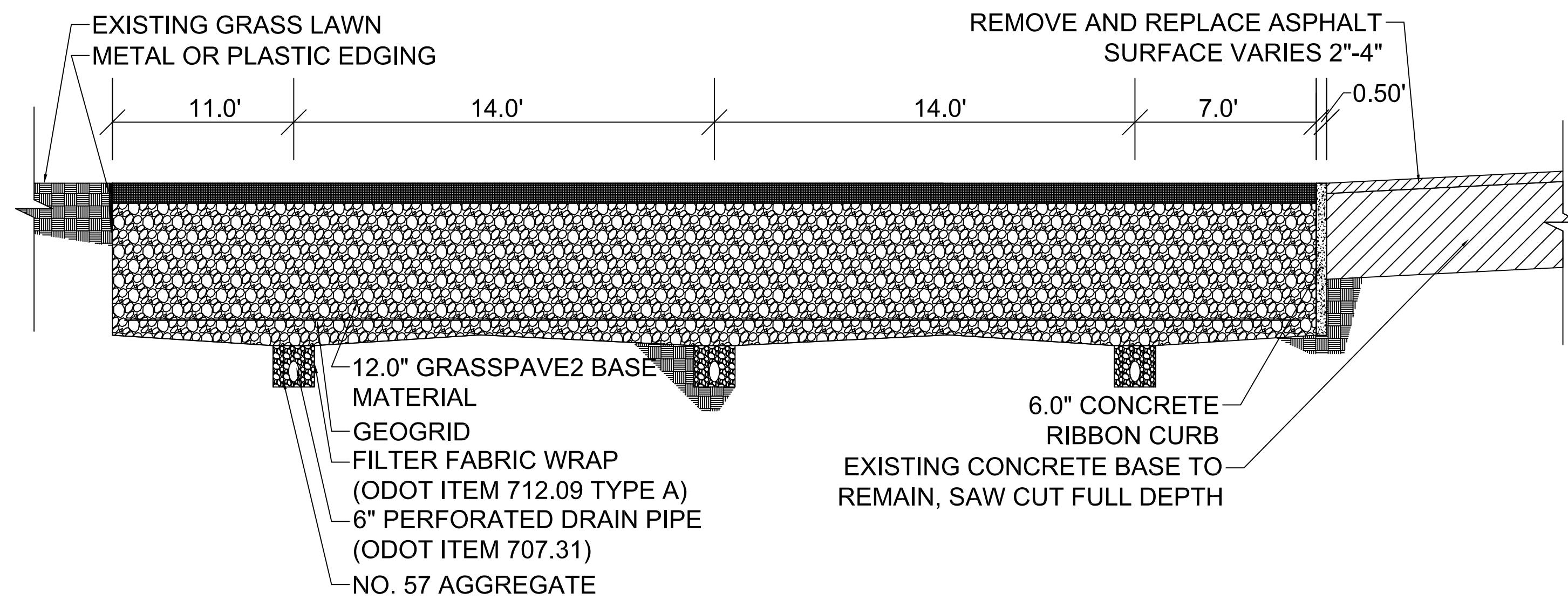

**11 Typical Section "C-C"**  
N.T.S

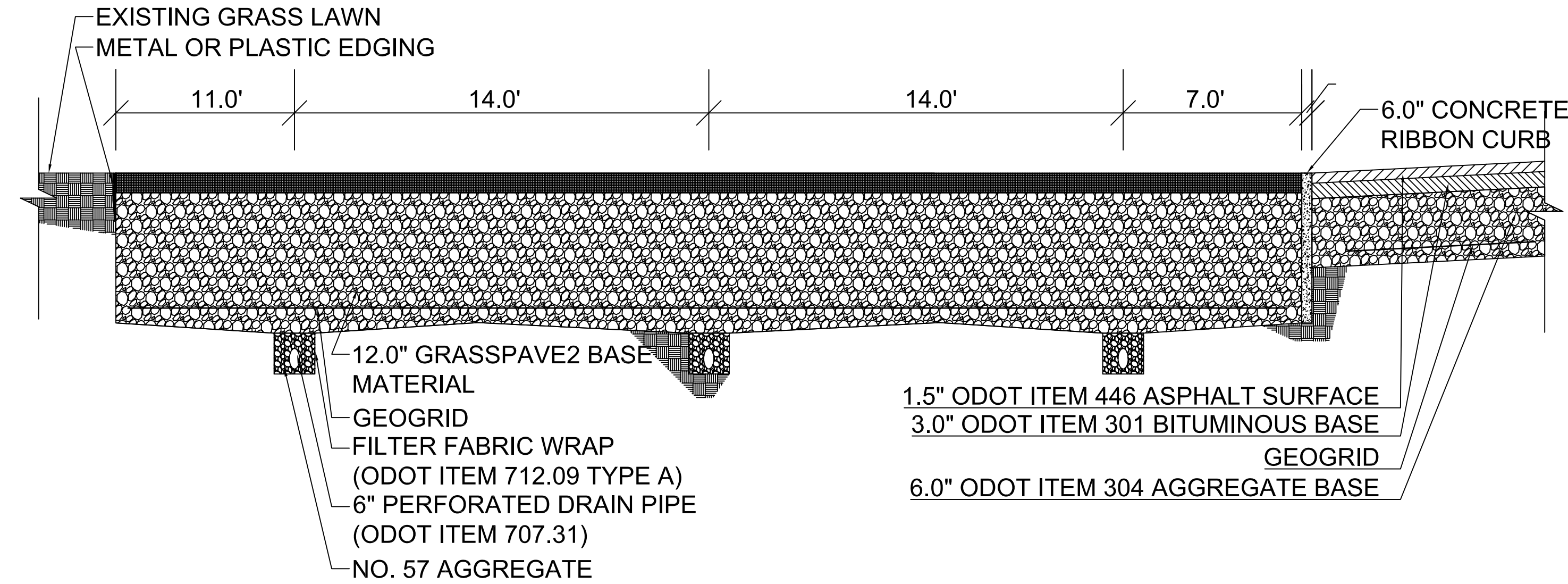

**12 Typical Section "C-C" ALTERNATIVE #1**  
N.T.S

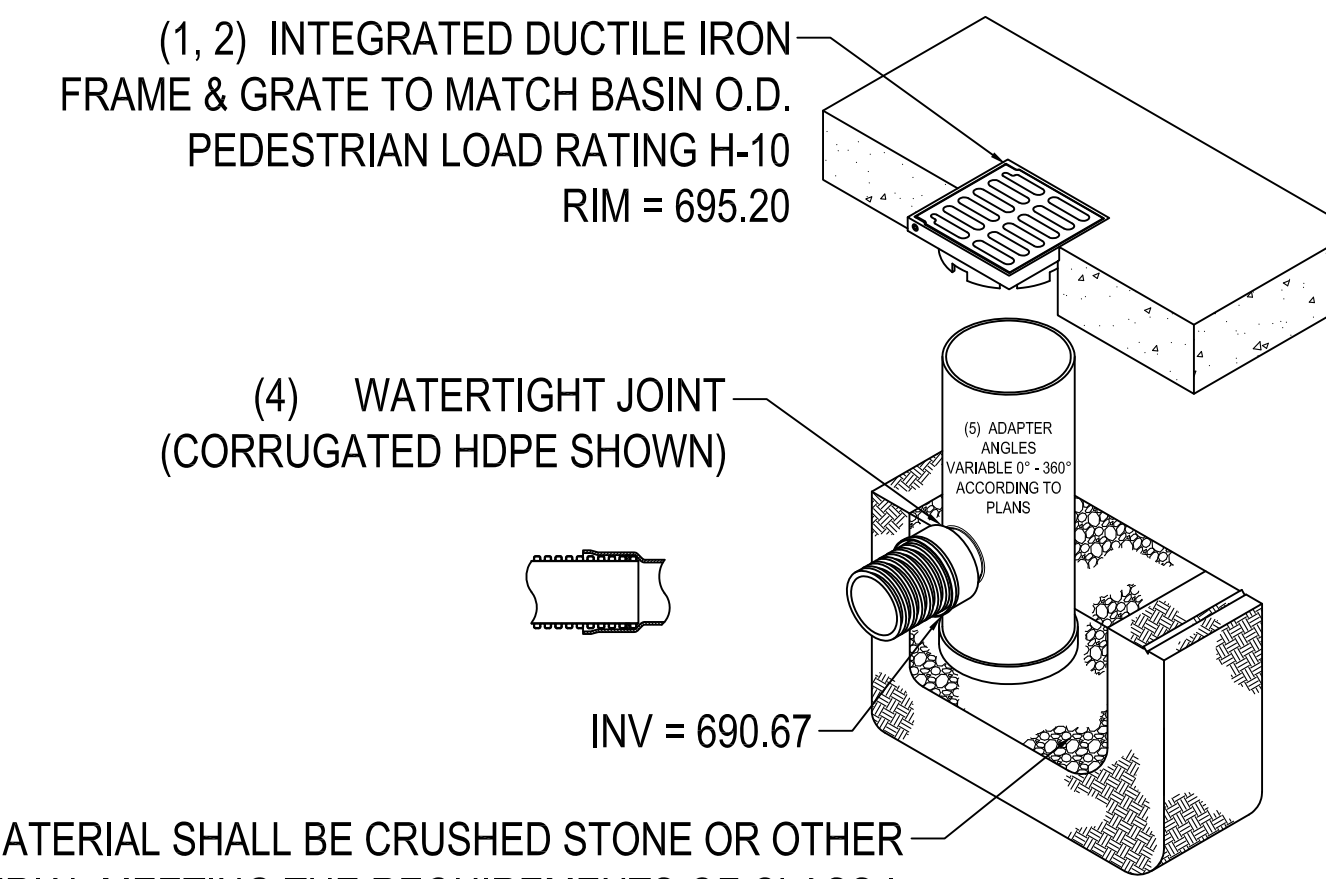

THE BACKFILL MATERIAL SHALL BE CRUSHED STONE OR OTHER GRANULAR MATERIAL MEETING THE REQUIREMENTS OF CLASS I, CLASS II, OR CLASS III MATERIAL AS DEFINED IN ASTM D2321. BEDDING & BACKFILL FOR SURFACE DRAINAGE INLETS SHALL BE PLACED & COMPACTED UNIFORMLY IN ACCORDANCE WITH ASTM D2321.

- 1 - GRATE SHALL BE DUCTILE IRON PER ASTM A536 GRADE 70-50-05,
- 2 - FRAMES SHALL BE DUCTILE IRON PER ASTM A536 GRADE 70-50-05
- 3 - DRAIN BASIN TO BE CUSTOM MANUFACTURED ACCORDING TO PLAN DETAILS.
- 4 - DRAINAGE CONNECTION STUB JOINT TIGHTNESS SHALL CONFORM TO ASTM D3212 FOR CORRUGATED HDPE (ADS N-12/HANCOR DUAL WALL), N-12 HP, & PVC SEWER.

**13 PROPOSED MANHOLE DETAIL**  
N.T.S

REV. No.	DATE	BY	DATE

STATE OF OHIO  
REGISTERED PROFESSIONAL ENGINEER  
KEYVIN T. HOFFMAN  
74831

DATE: 11/17/16  
SCALE: HOR. 1"=20'  
VERT. N/A  
FOLDER: DWG/Site Plans  
FILENAME: Site Plan  
TAB: 11-PR\_TypDet3  
DRAWN: KTH

**Family Ministry Center**  
3389 Fulton Road  
Cleveland, Ohio 44109

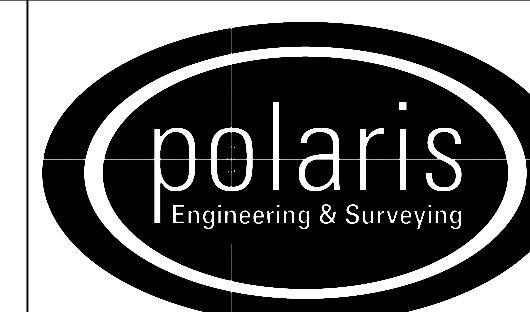

POLARIS ENGINEERING & SURVEYING, INC.  
34600 CHARDON ROAD - SUITE D  
WILLOUGHBY HILLS, OHIO 44094  
(440) 944-4433 (440) 944-3722 (Fax)  
www.polaris-es.com

**TYPICAL CROSS-SECTIONS AND DETAILS**

CONTRACT No.	
15225	
SHEET	OF
11	12



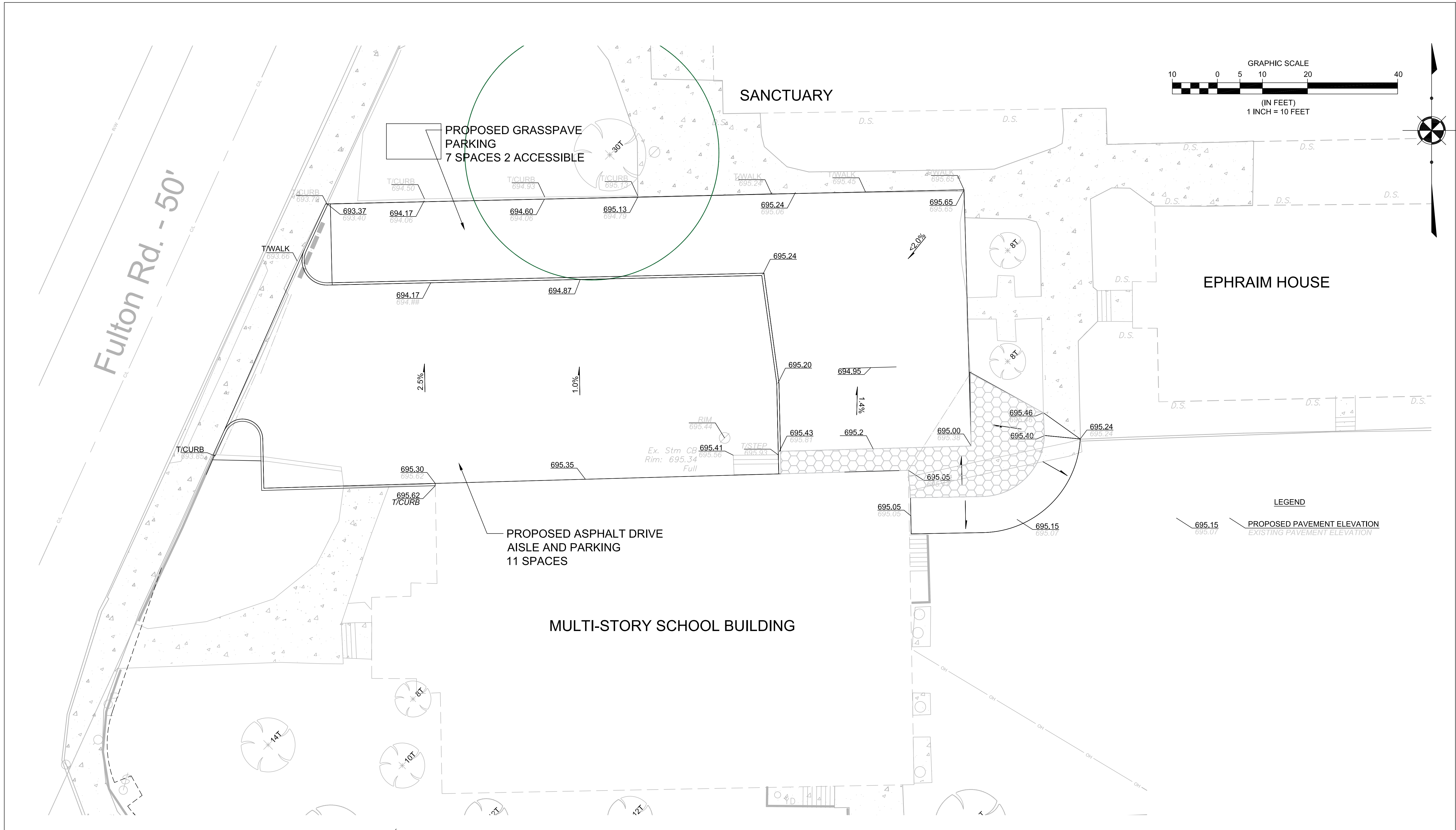

REV. No.	DATE	BY

DATE: 11/17/16  
 SCALE: HOR. 1"=10'  
 VERT. N/A  
 FOLDER: DWG/Site Plans  
 FILENAME: Site Plan  
 TAB: 12-PR Grading  
 DRAWN: KTH

**Family Ministry Center**  
 3389 Fulton Road  
 Cleveland, Ohio 44109

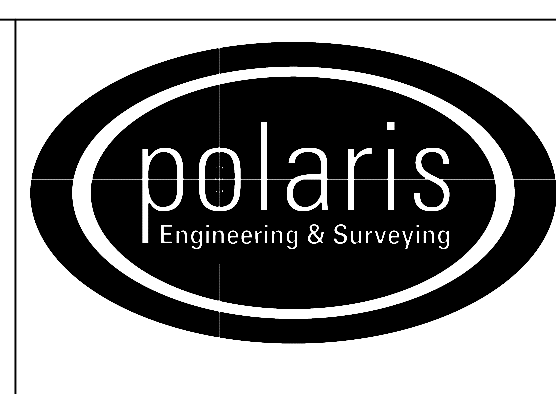

**POLARIS ENGINEERING & SURVEYING, INC.**  
 34600 CHARDON ROAD - SUITE D  
 WILLOUGHBY HILLS, OHIO 44094  
 (440) 944-4433 (440) 944-3722 (Fax)  
 www.polaris-es.com

**PROPOSED GRADING**

CONTRACT No.	
15225	
SHEET	OF
12	12